



1



2





1x

3



1x

4



6x

6x

5

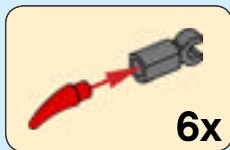

2x

6





1x

7



8



1x

8





1x



1x

9

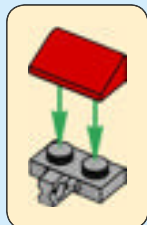

1x



2x

10

1



2





11

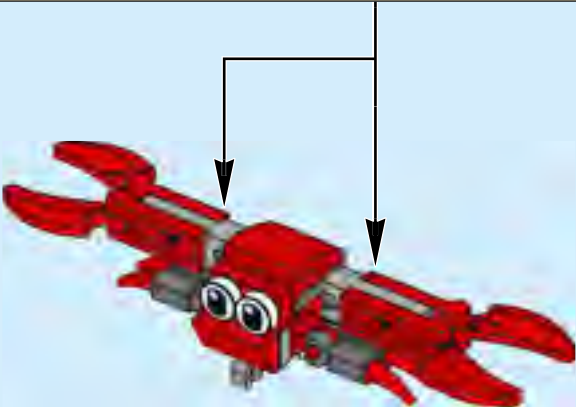



1x

1



1x



1x

2



2x

3



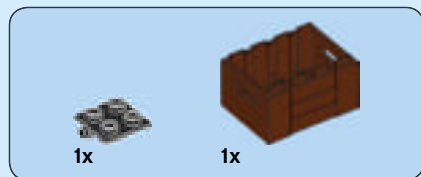

4

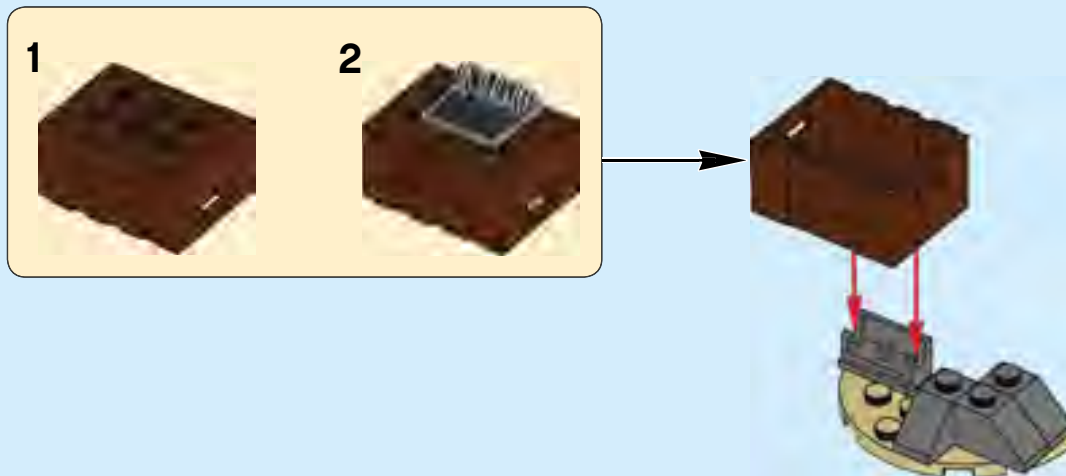

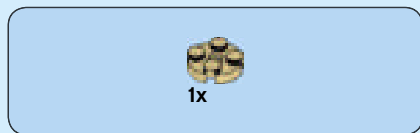

5

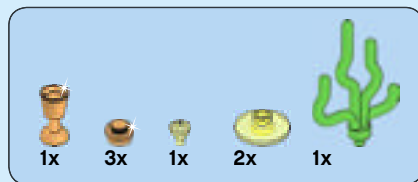

6



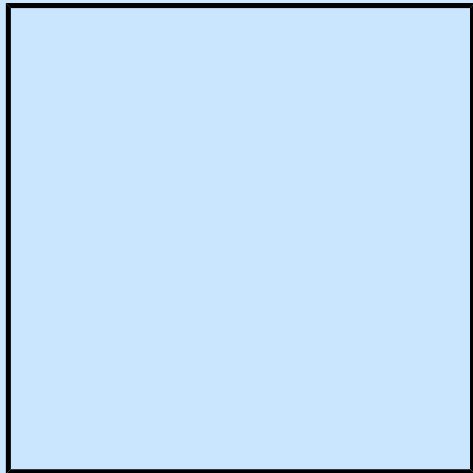

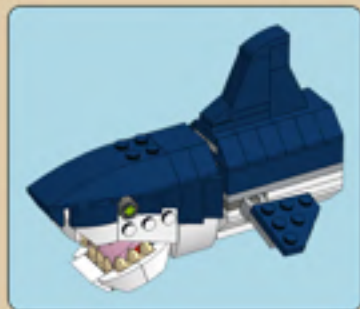

1x



1x



1

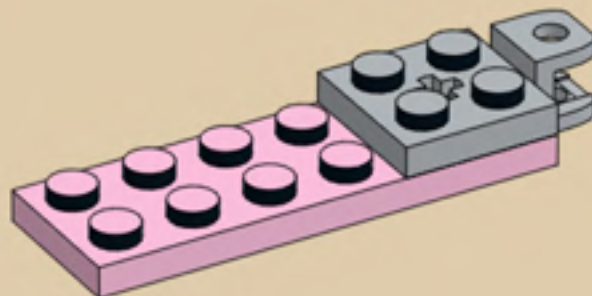

1x



1x



2

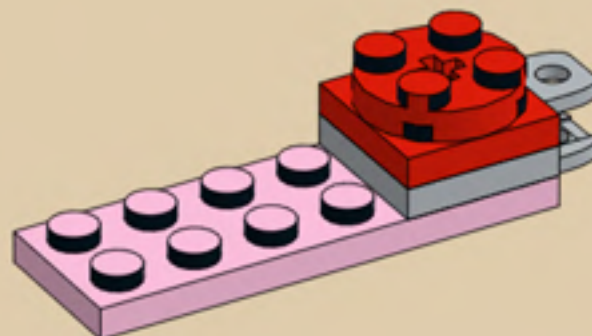

1x



3

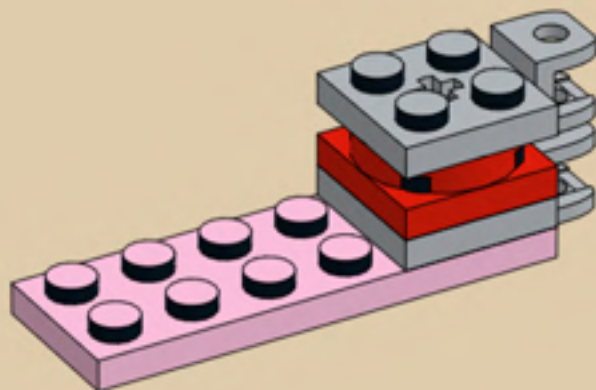

2x



4

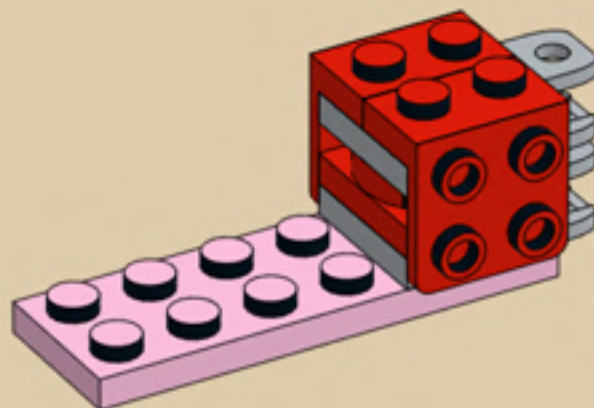

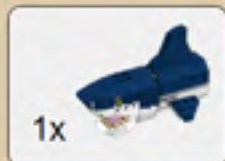

5 Original Steps 7 to 64

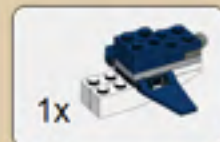
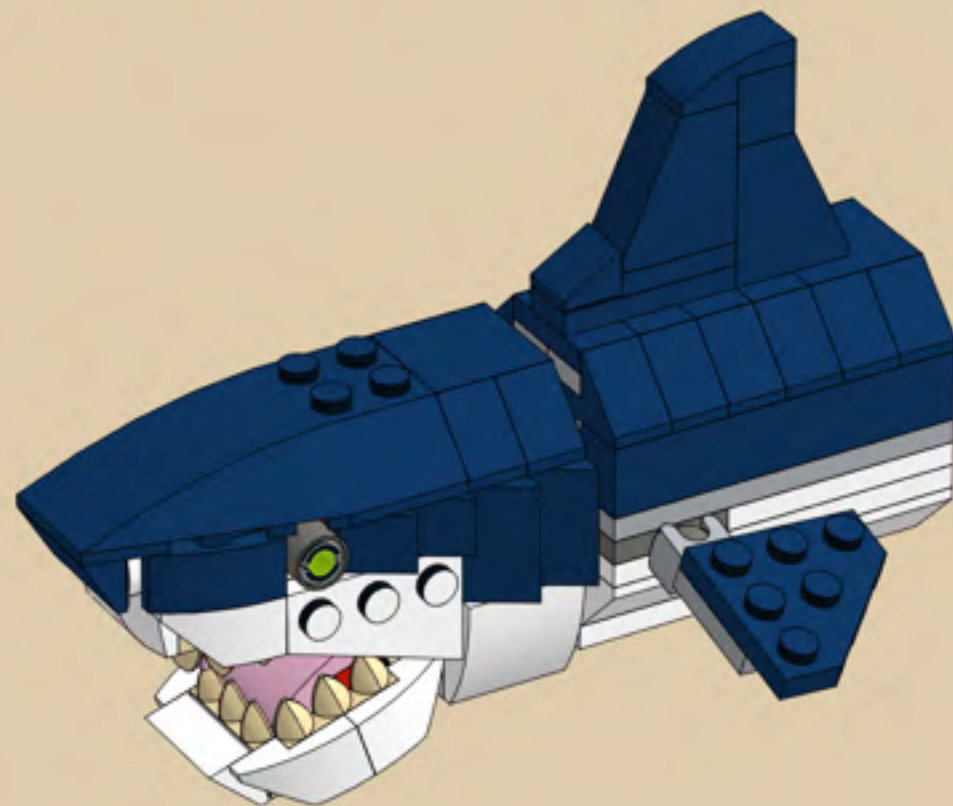

1 Original steps 65 to 71

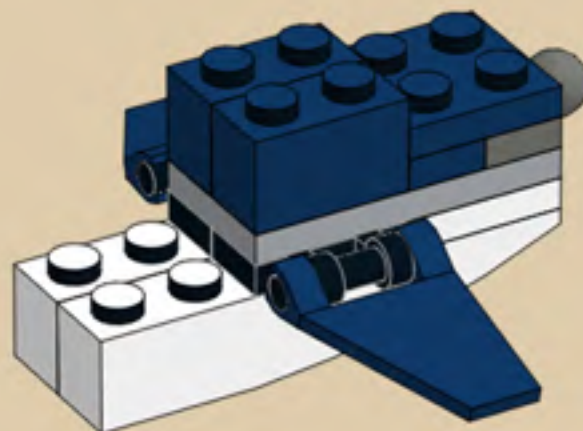



7

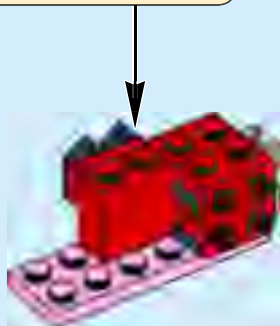
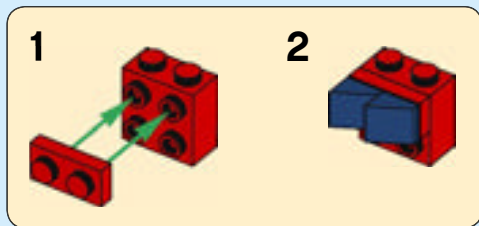



7

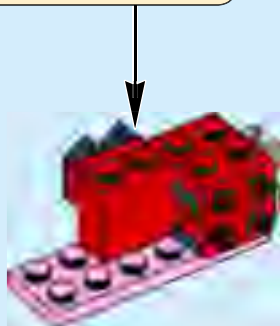
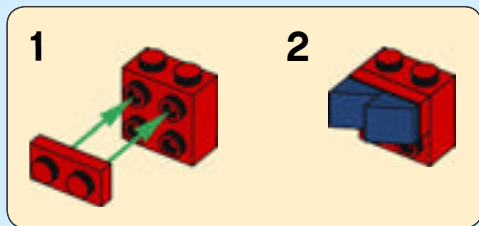



7

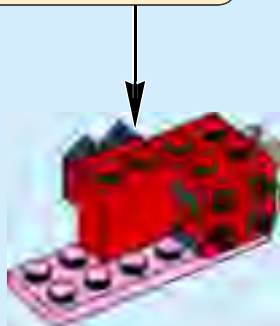
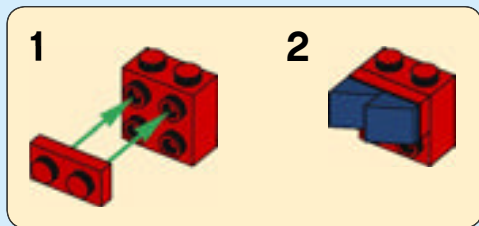



7

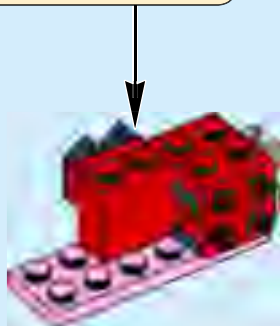
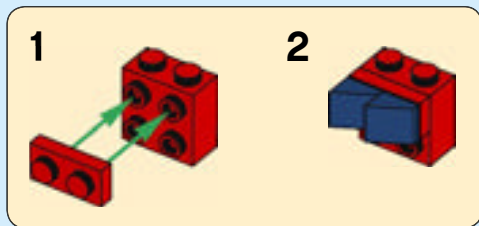



8

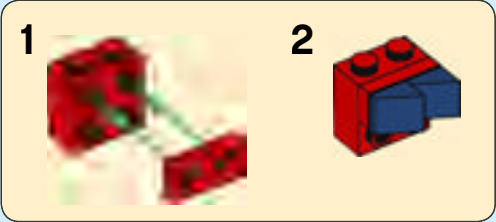



1x

9



1x

10





2x



2x

11

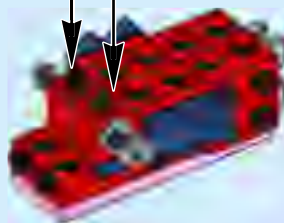

2x

12





1x

13



1x

14





2x

15

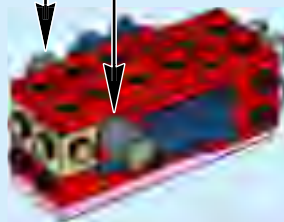

4x

16





1x

17



1x

18





1x



1x

19

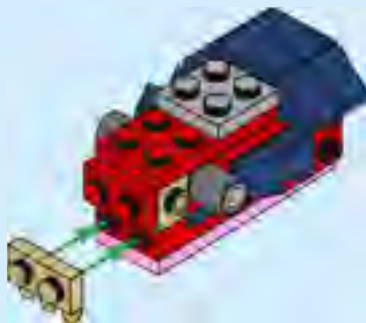

1x

20





7

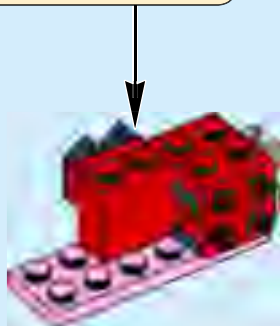
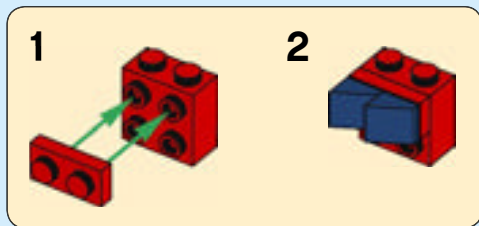



7

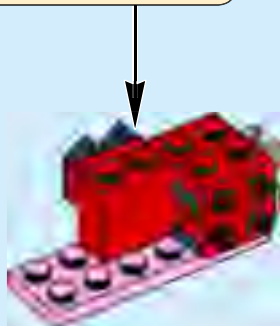
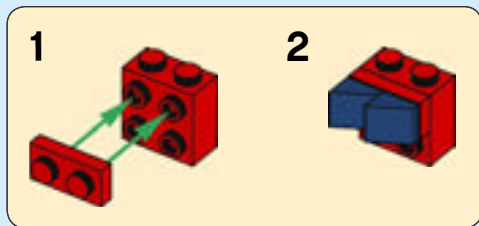



8

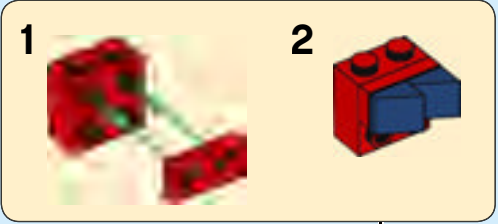



1x

9



1x

10





2x



2x

11

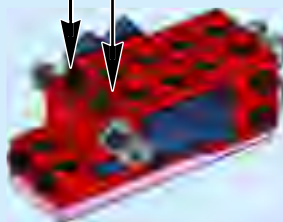

2x

12





1x



1x

19

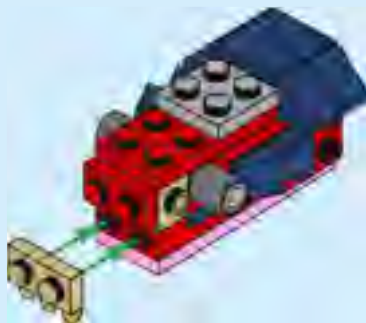

1x

20





1x

21



1x

22

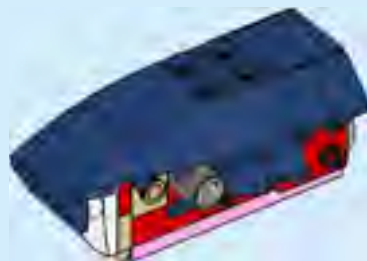

23

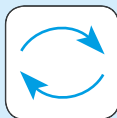
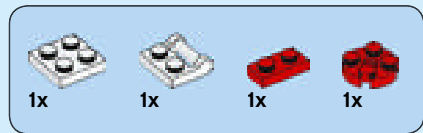



2x

24





1x

21



1x

22



23

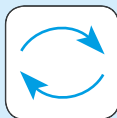
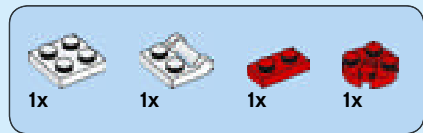



2x

24





25



26





1x

27



1x



1x

28



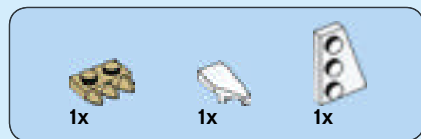

29

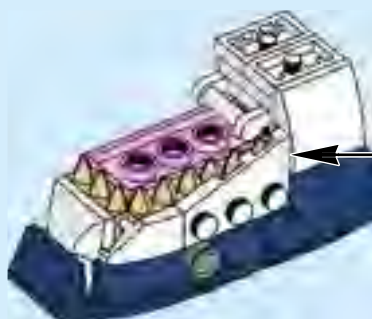



1x



1x

30

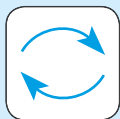

2x

31





1x

32



1x



1x

33

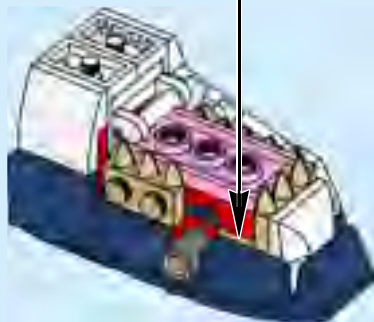

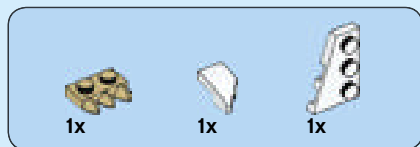

34

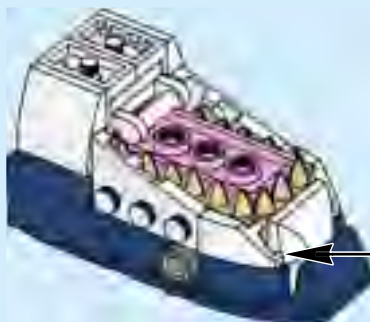
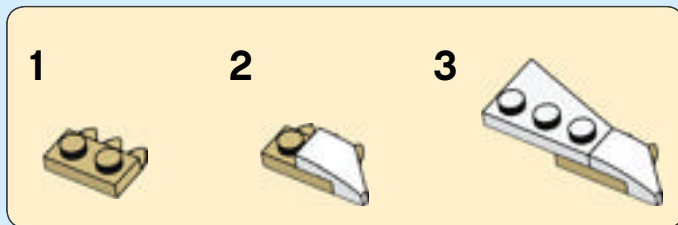



1x

35



2x

36





2x

37



1x

38



1x

39





40



41





42

1

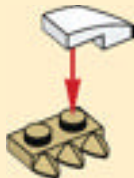

2



2x

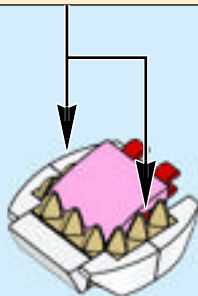

43

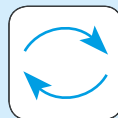



1x

44



1x

45





1x

46



1x

47





2x

48

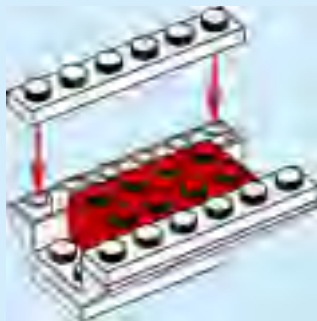

2x



2x



2x

49





2x



2x

50



1x

51





2x

52



1x

53



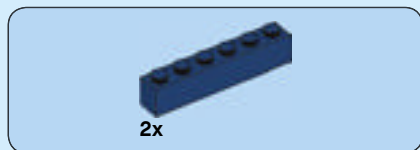

54

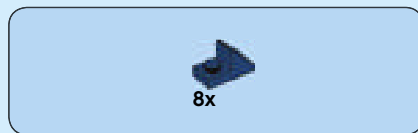

55

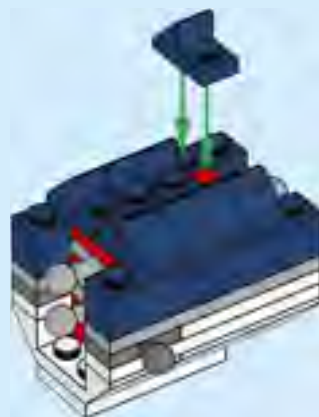



4x

56

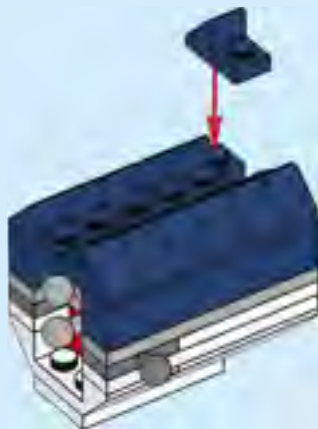



2x

57



1x



4x

58





2x

59



2x

60

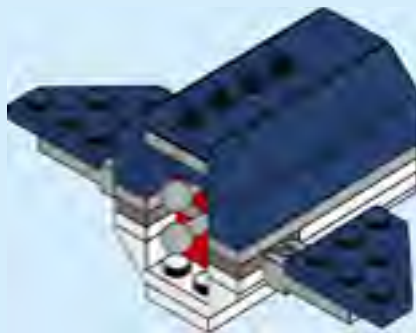

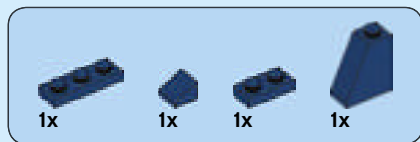

61

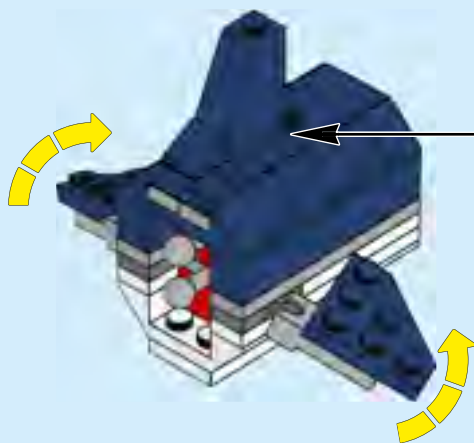
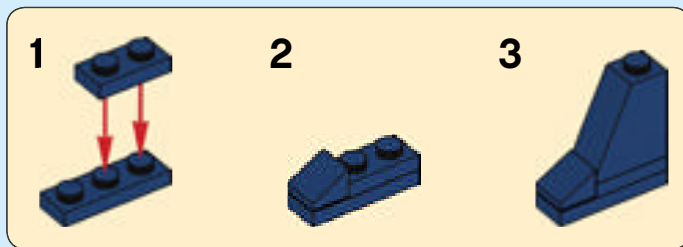

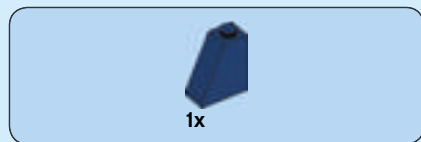

62

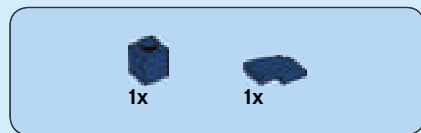

63

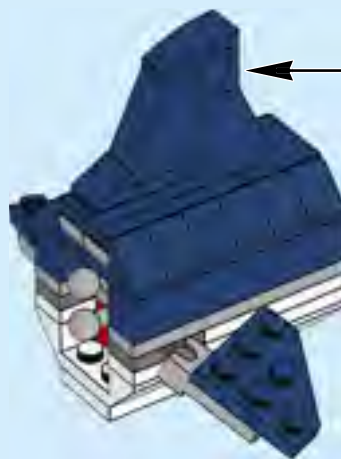
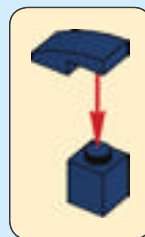

64

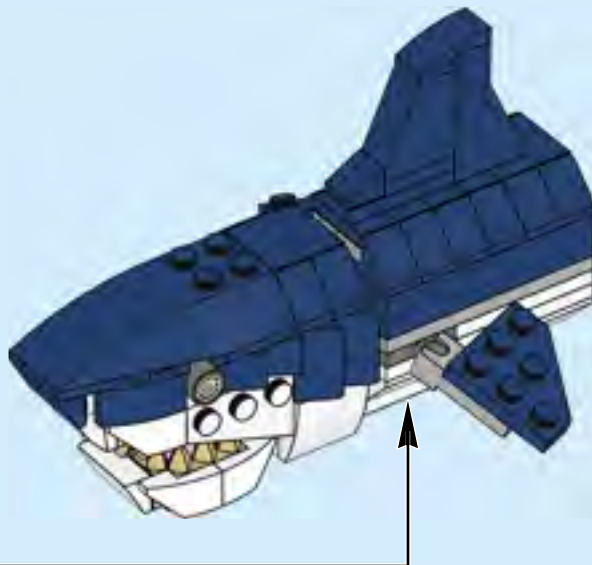



2x

65



1x

66





2x

67



1x

68





2x

69



1x



1x

70





2x



1x

71



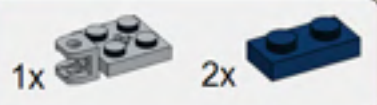

2

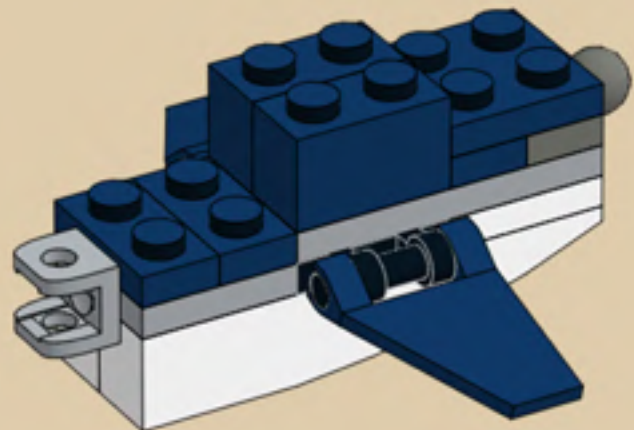

3

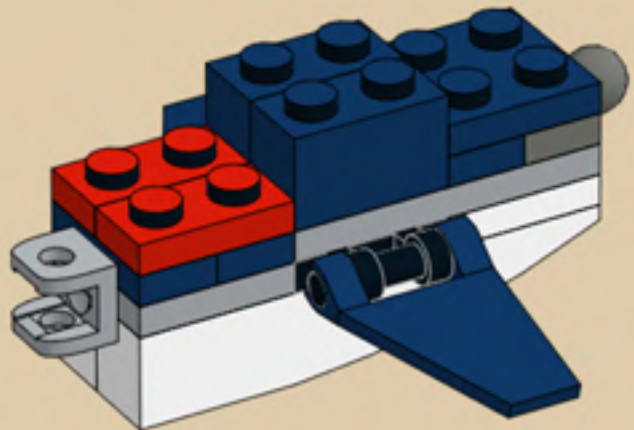



4

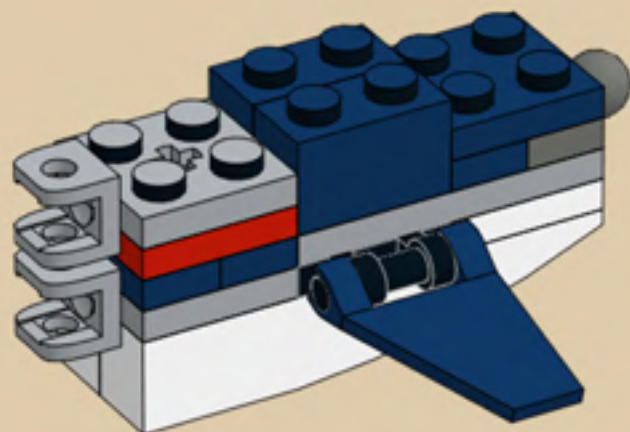

5

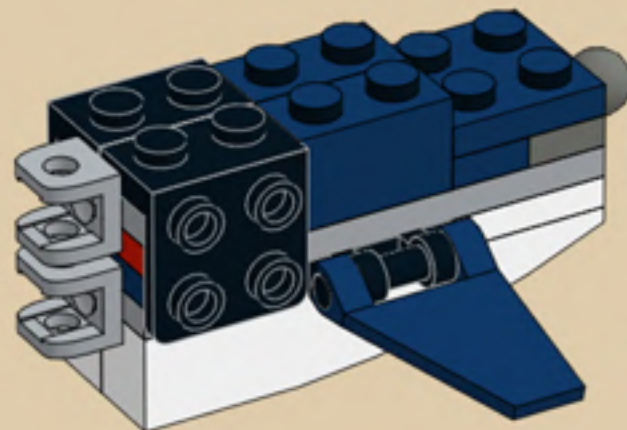

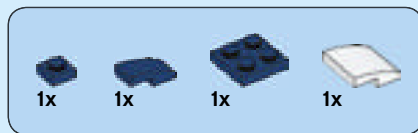

74

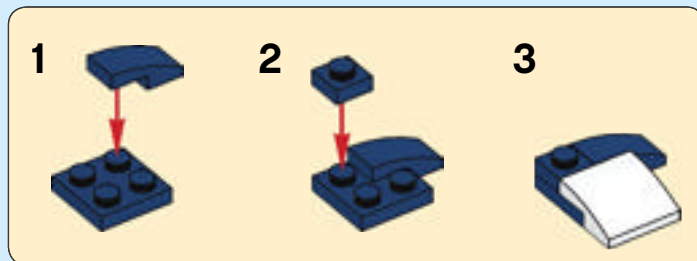

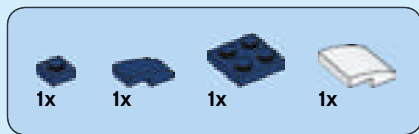

75

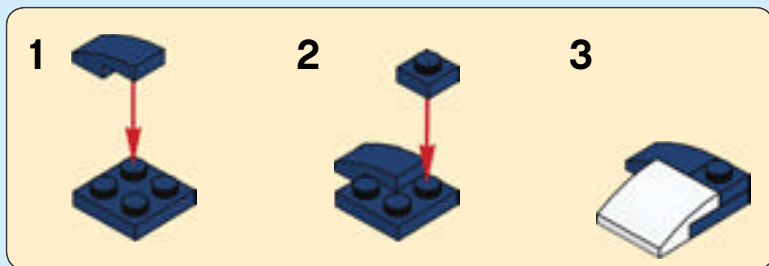



2x

76



1x



2x

77



78

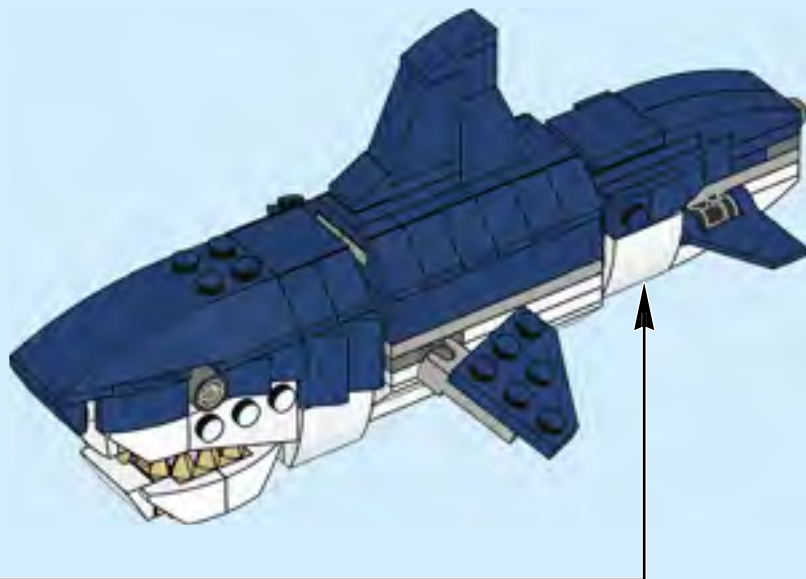

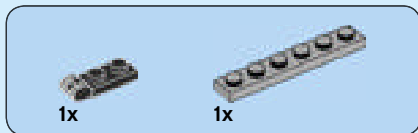

79



80



81





1x

82



1x



1x

83



84

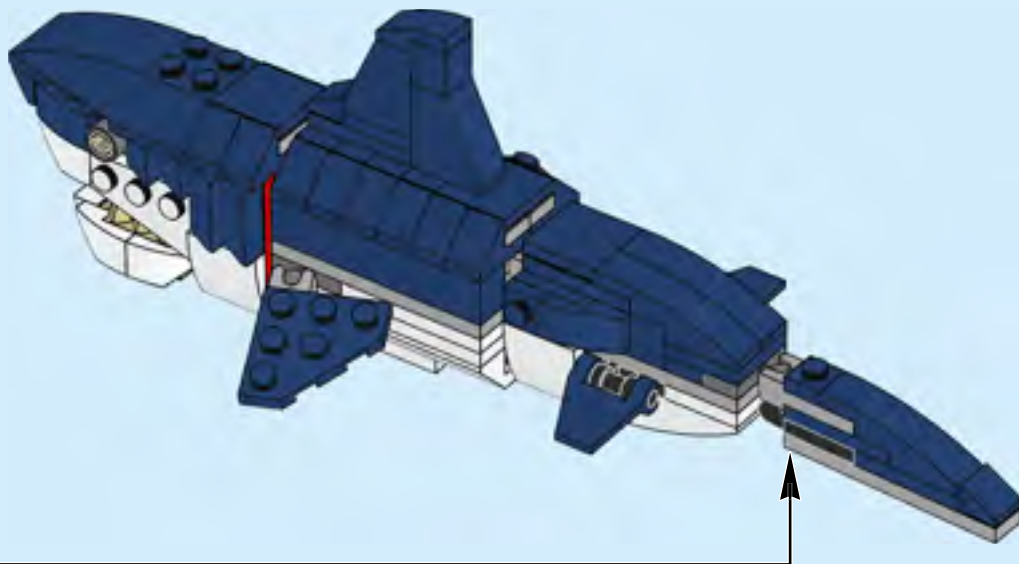

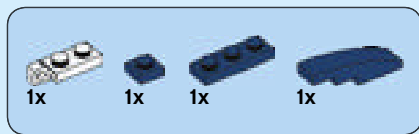

85

1

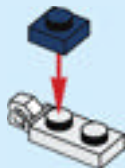

2



3



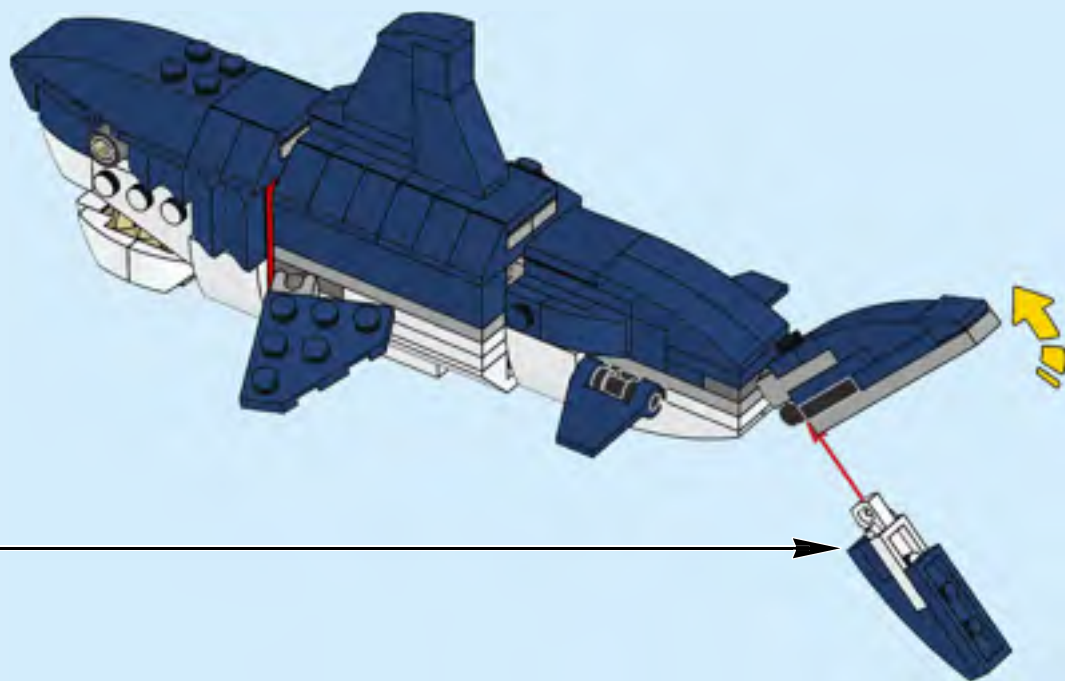

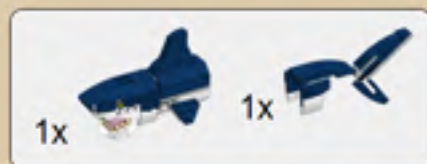

6 Original steps 74 to 85

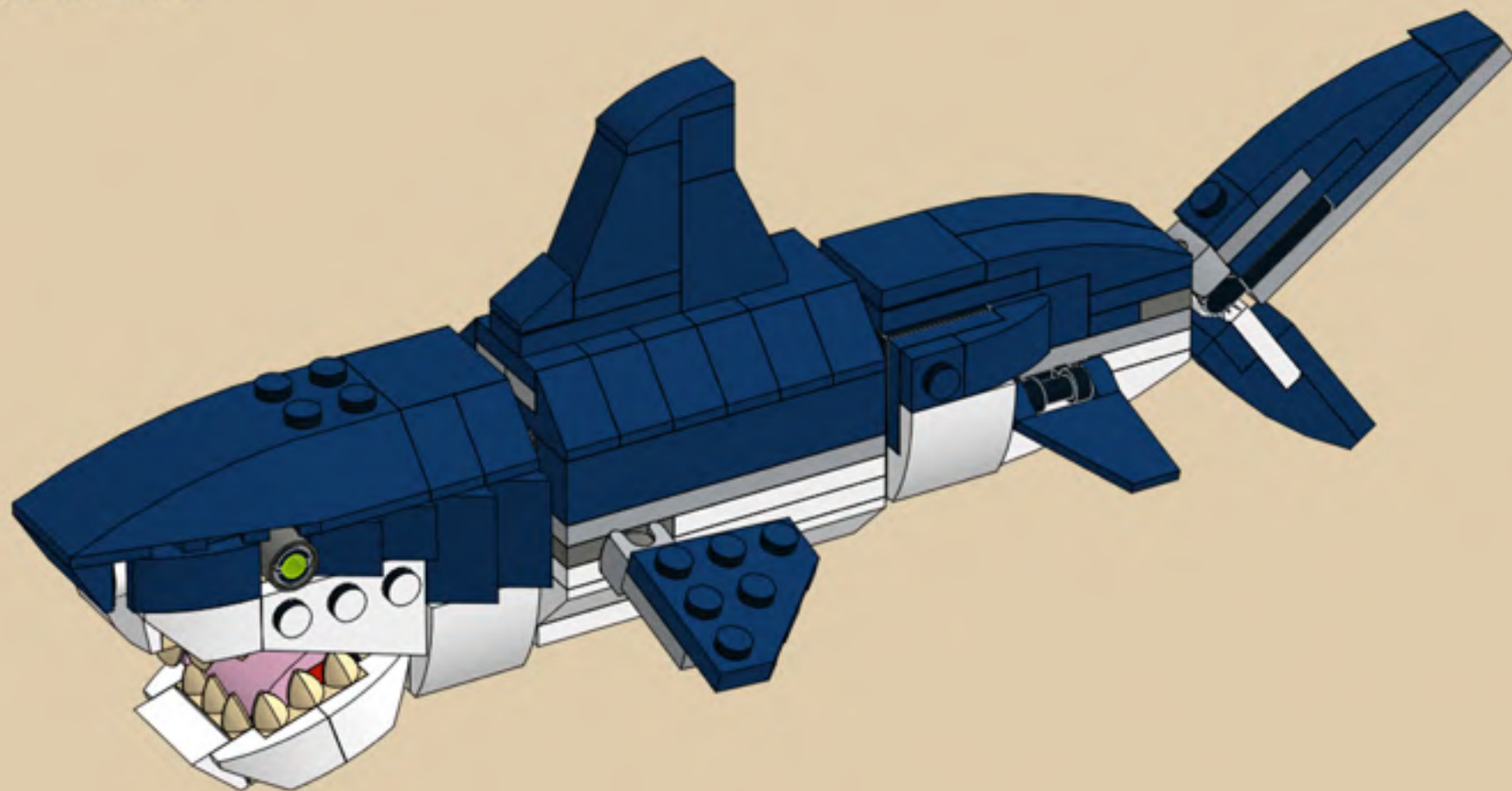

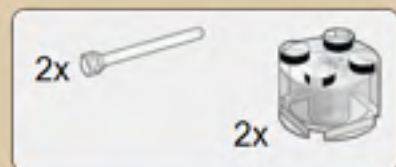

7

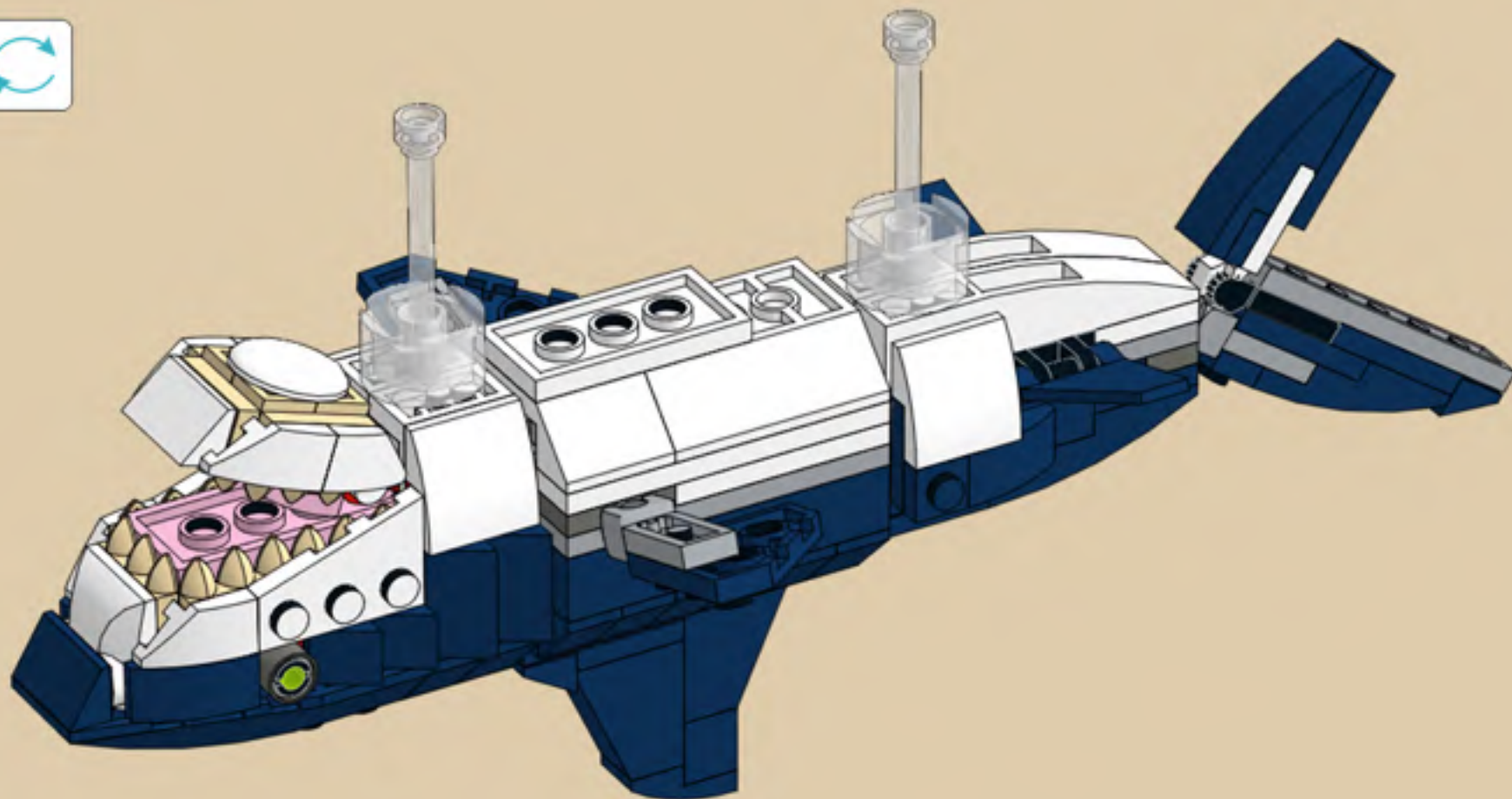



x3



1

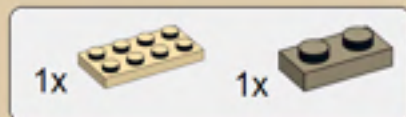
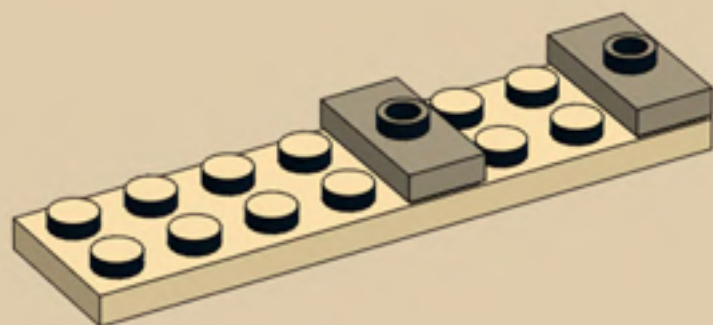

2

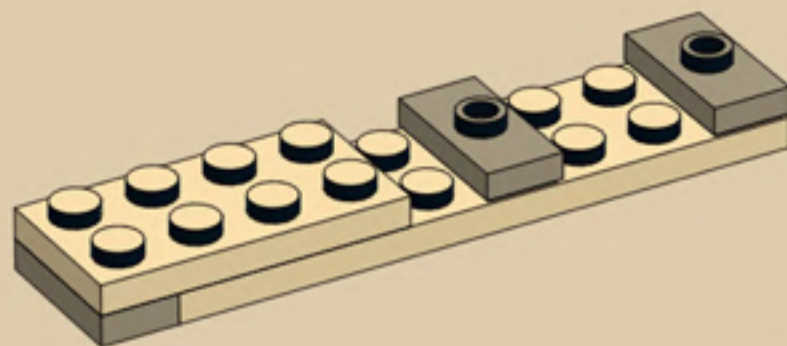

x3

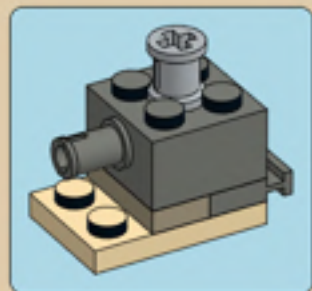

x2



1

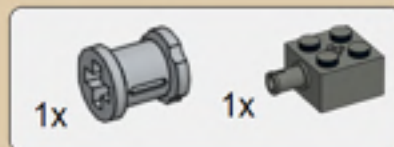

2

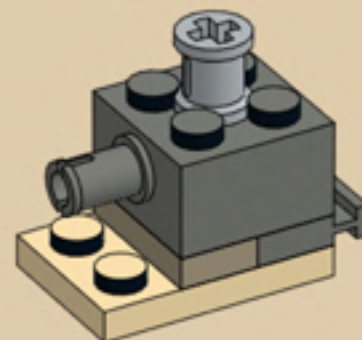

x2



x2

1x



1x



1x

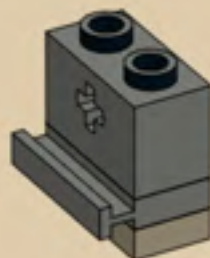

x2



2x



1x



1

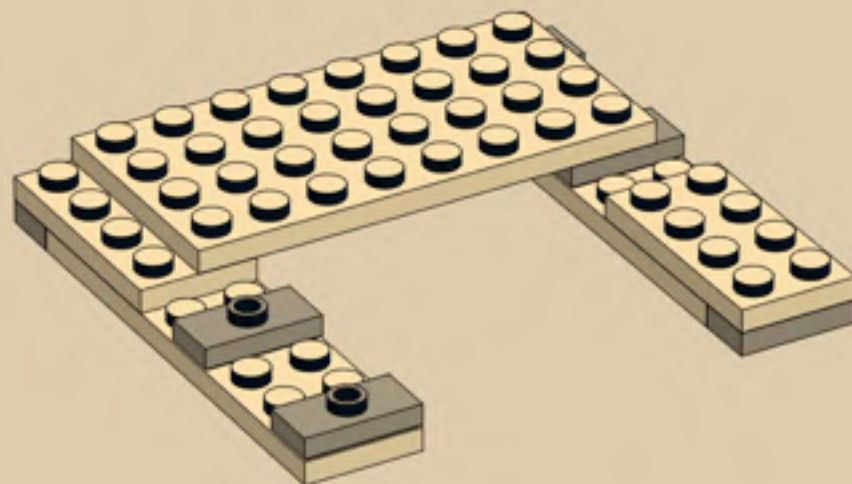

- 1x  1x  1x 

2

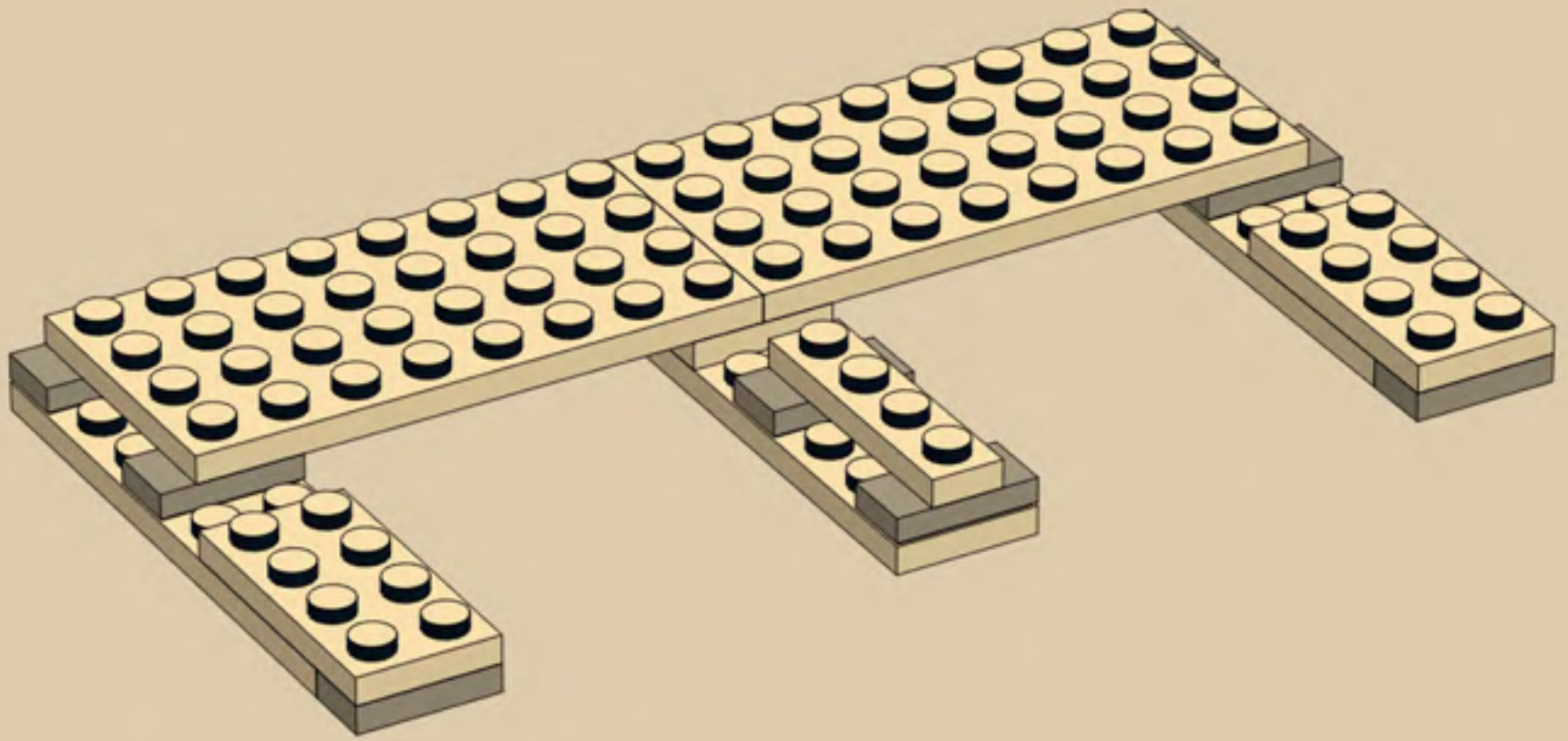

3x



2x



3

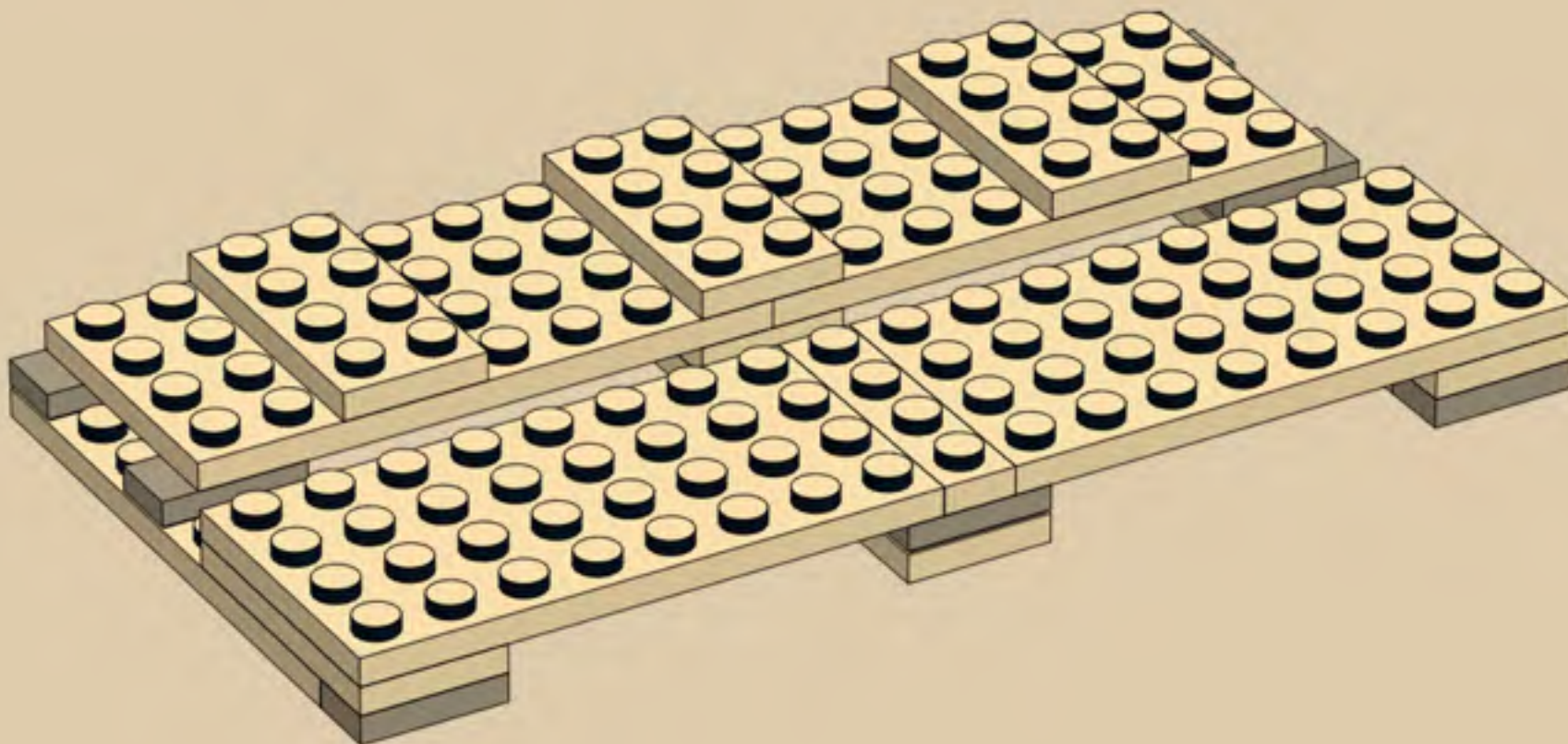

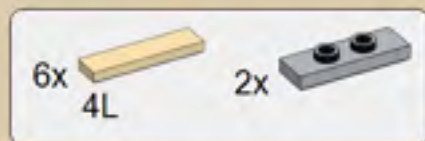

4

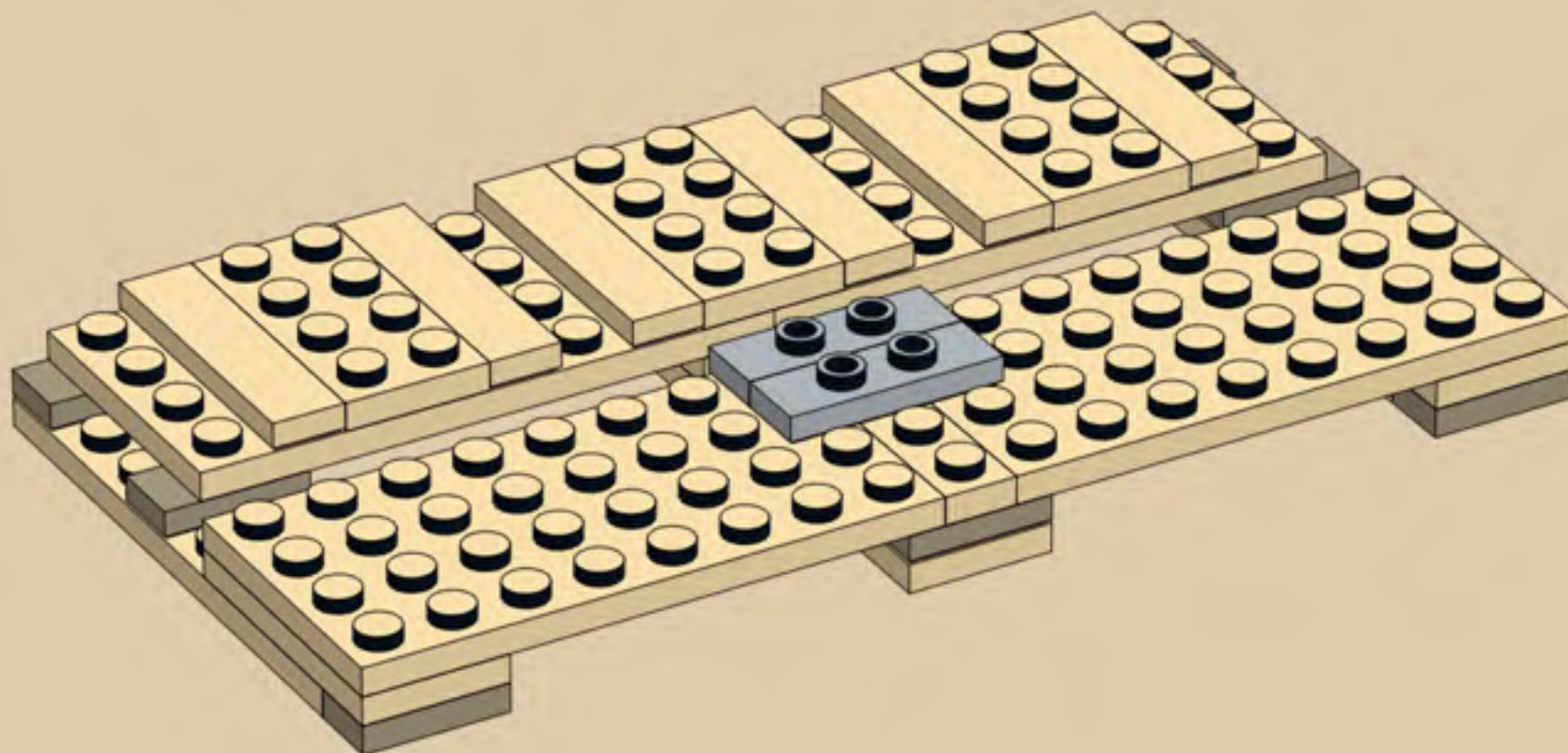



5

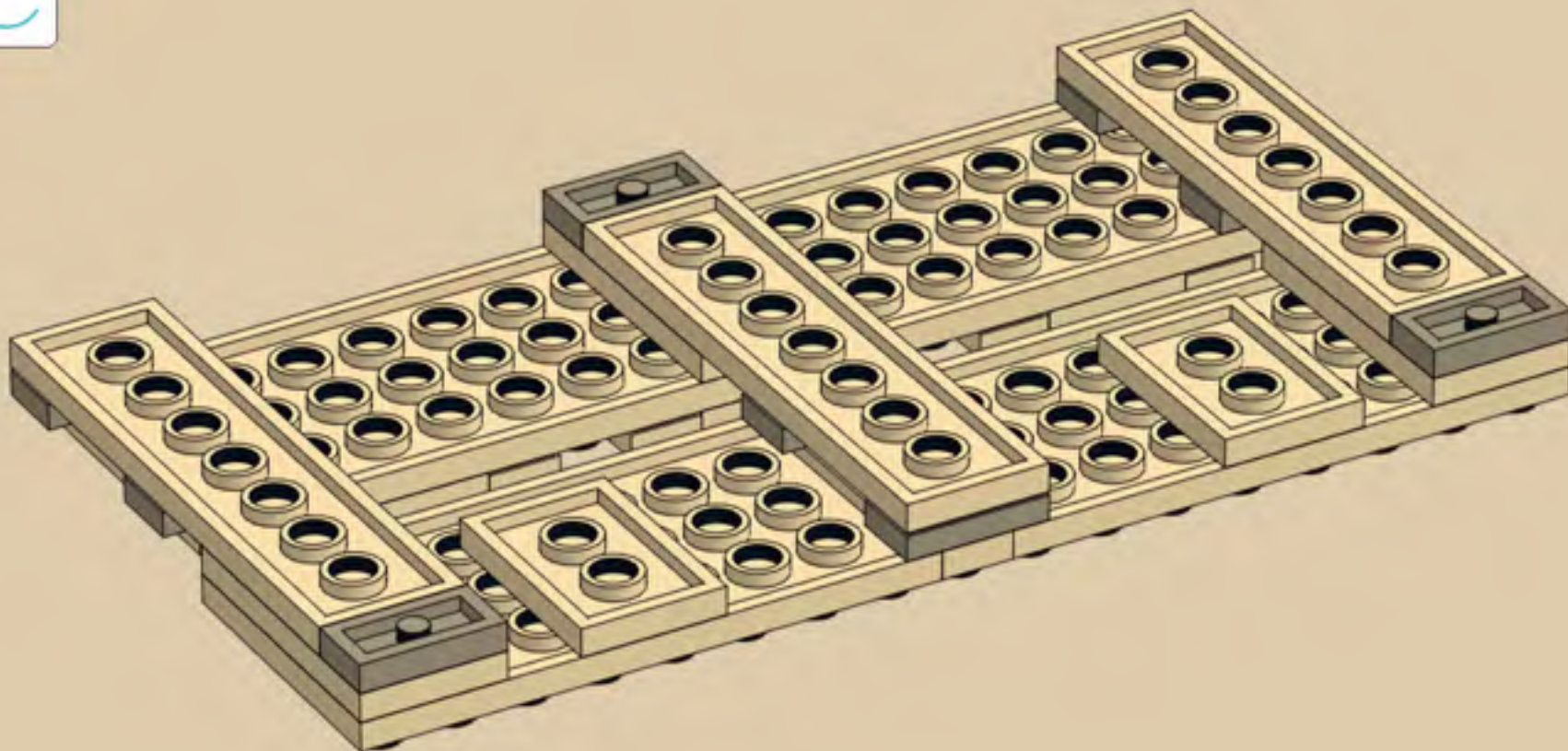



6

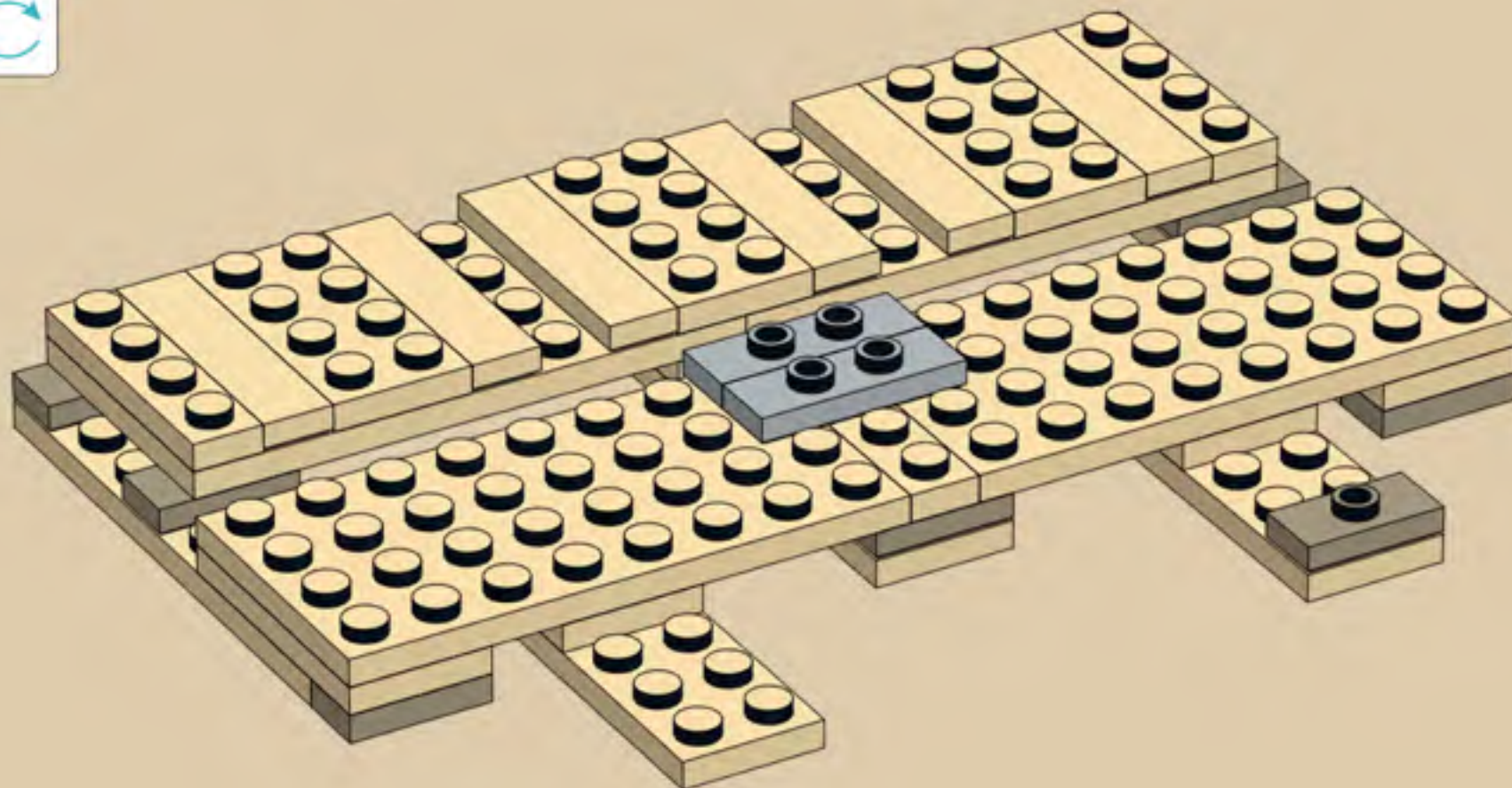



7

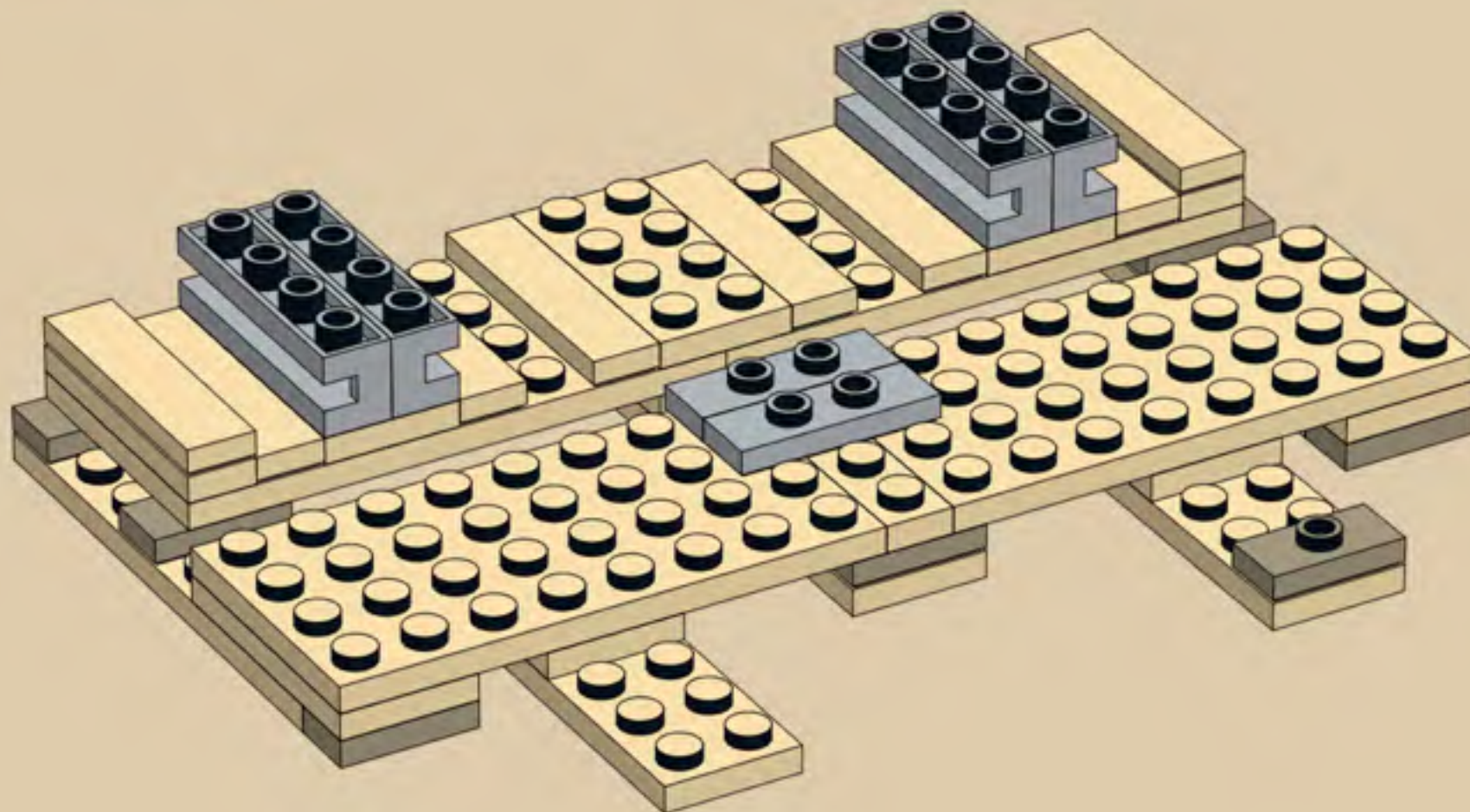



8

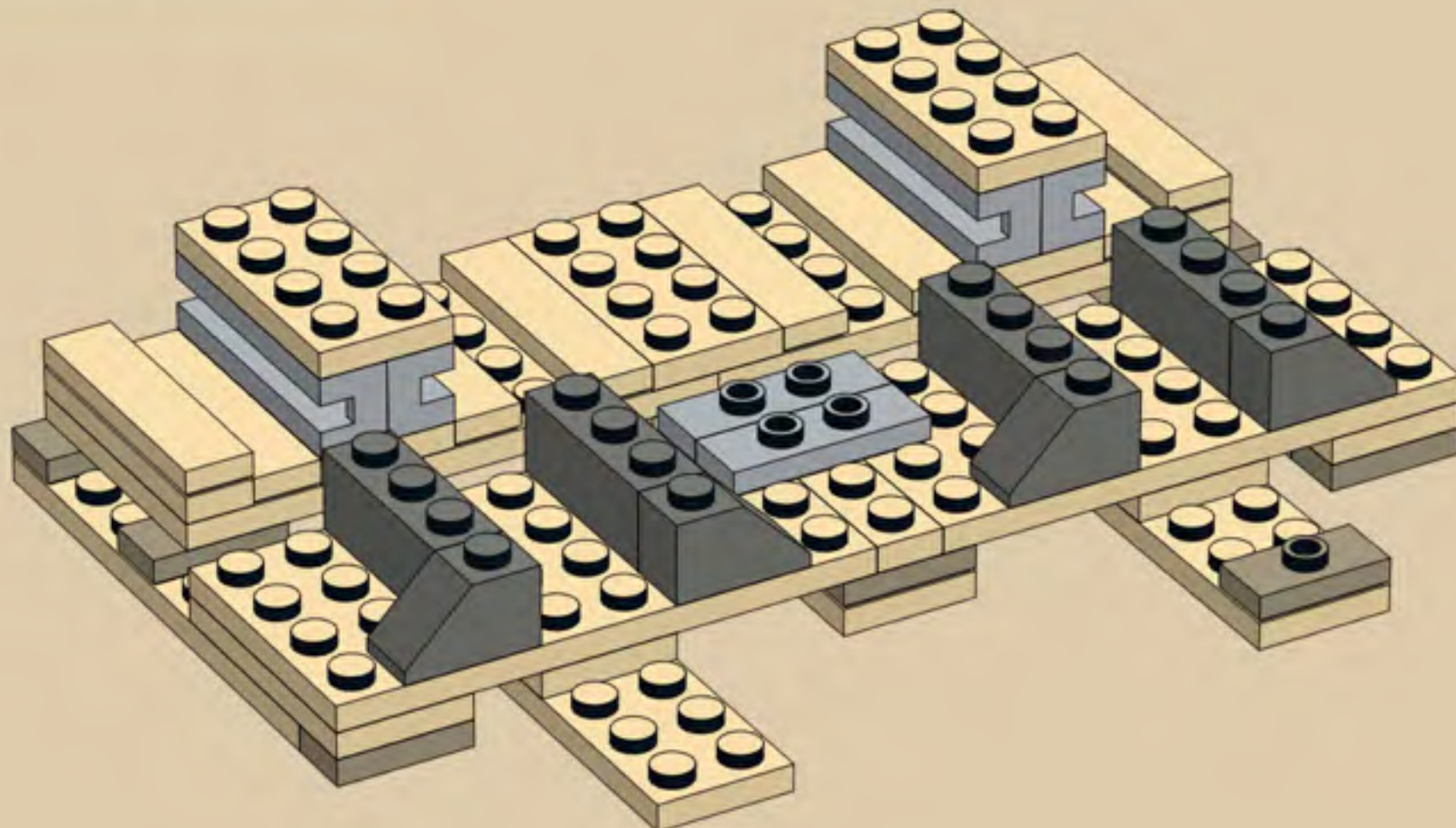



9

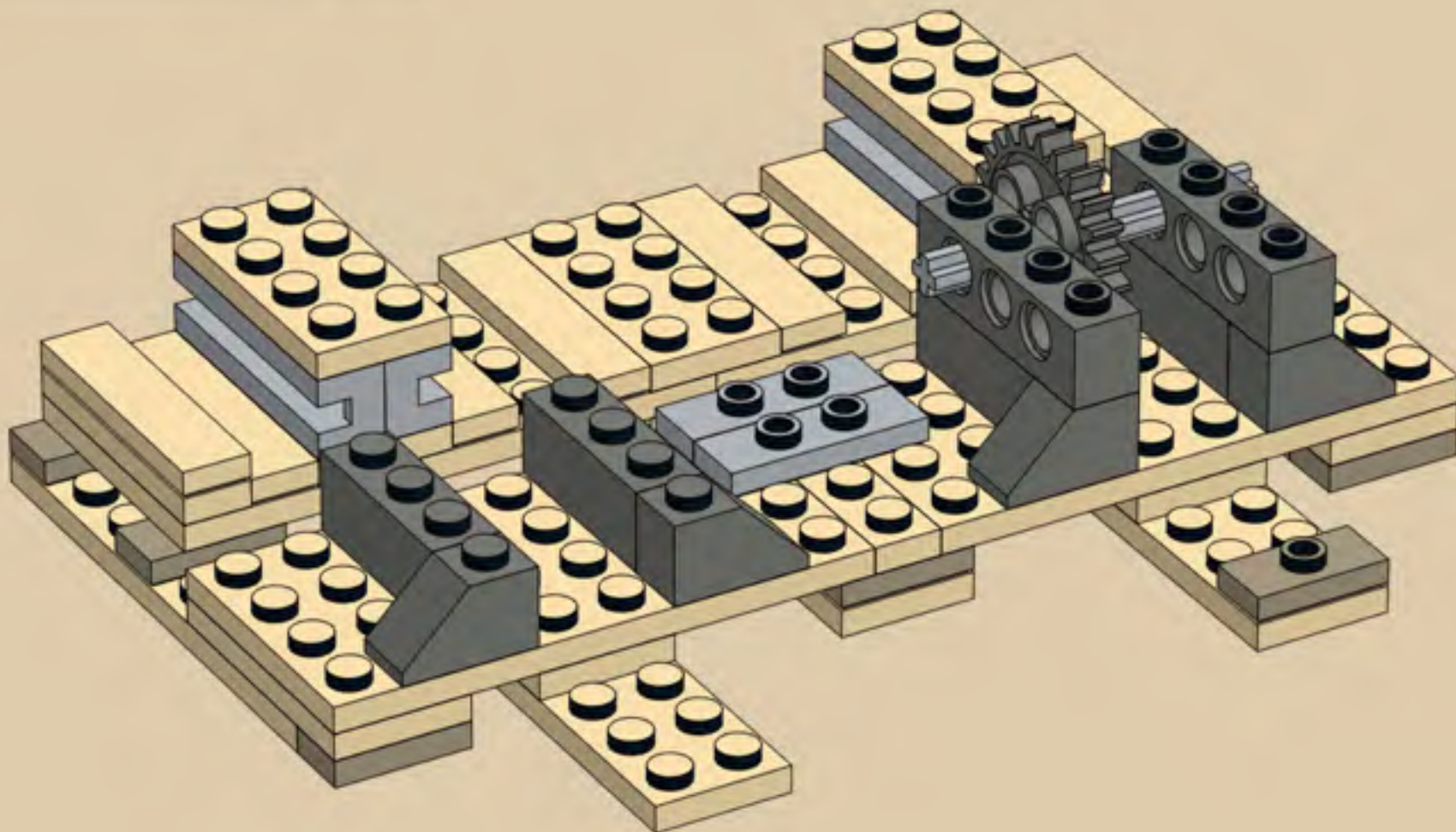



10

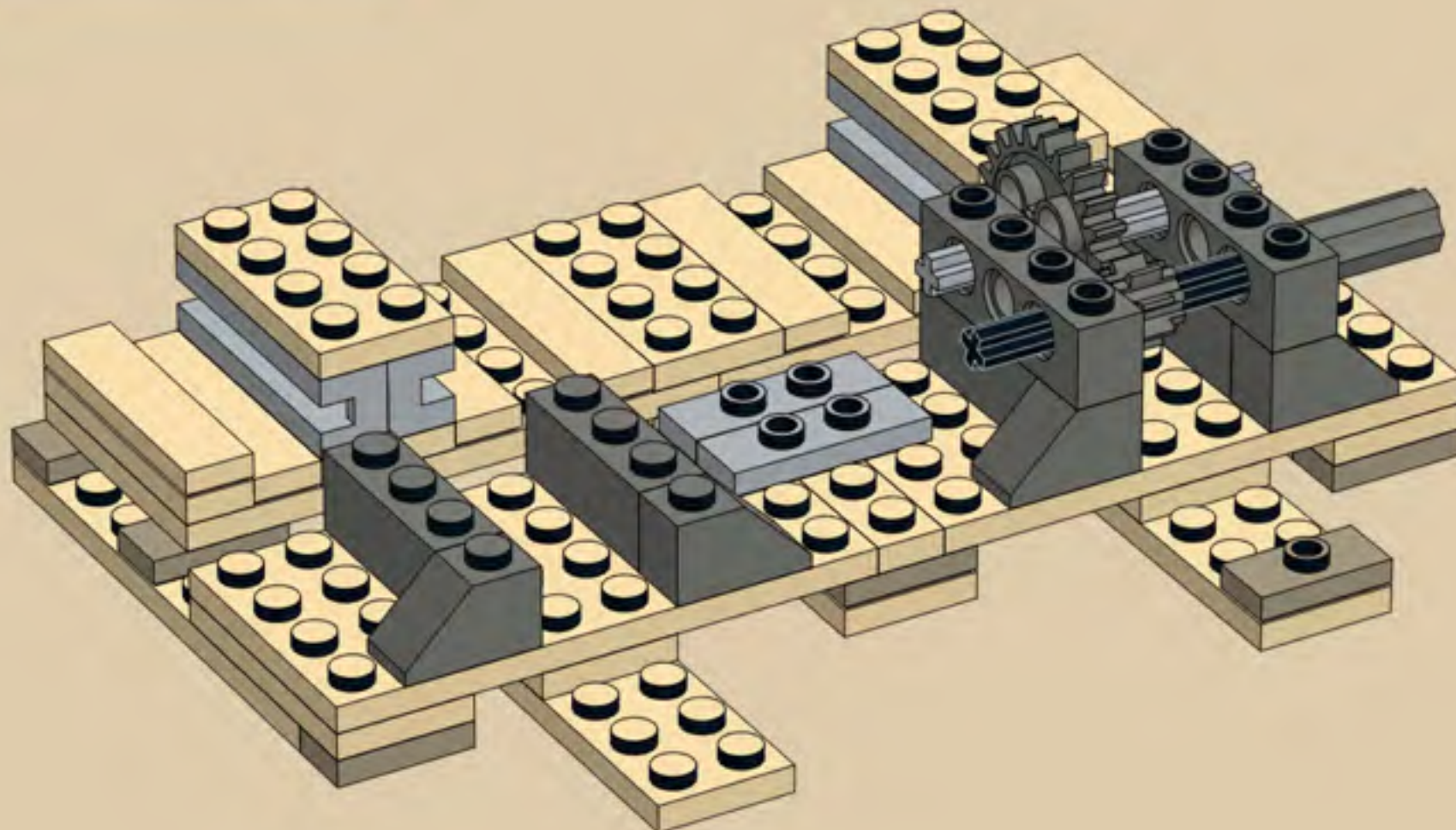





12

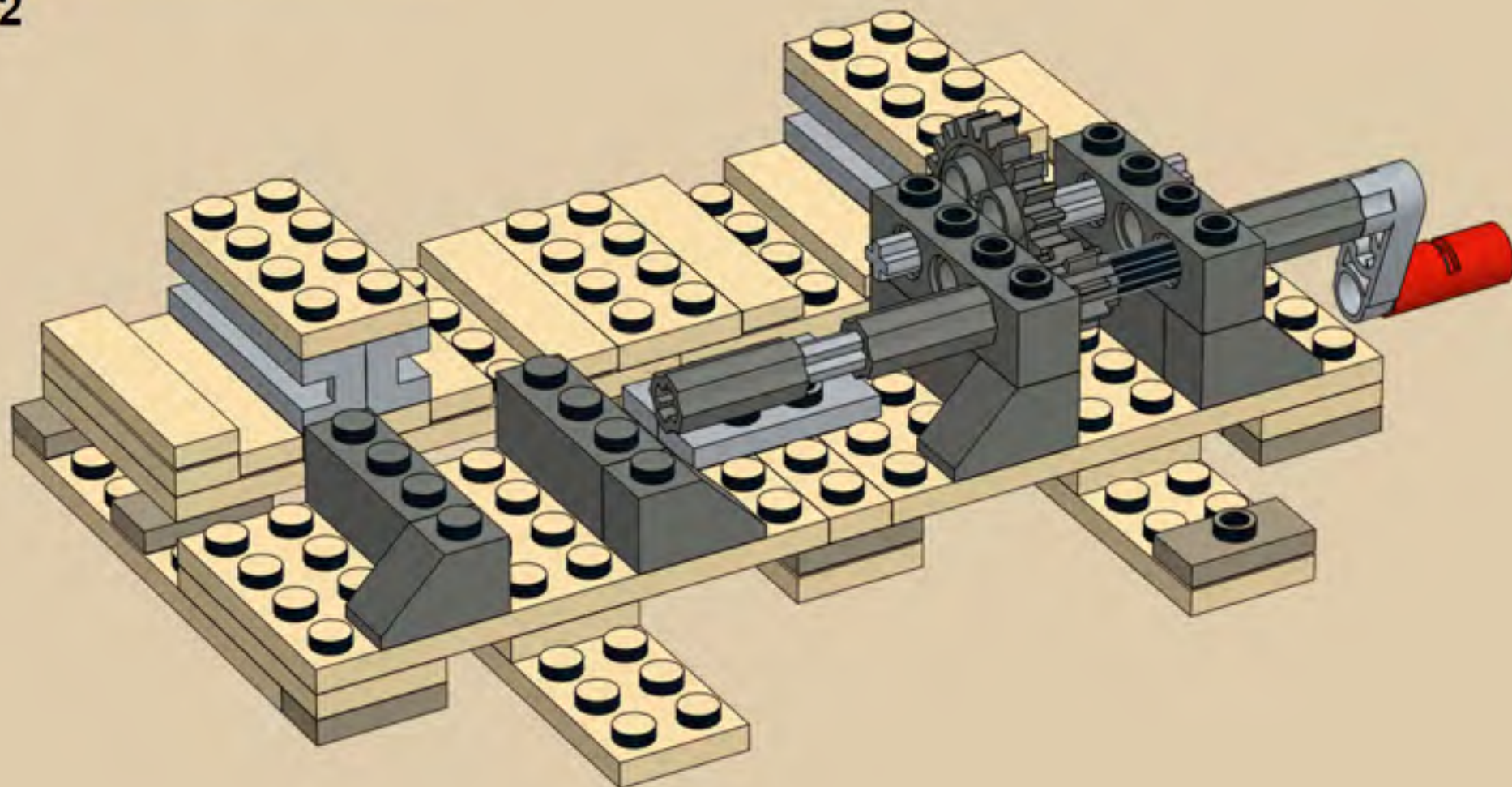



13

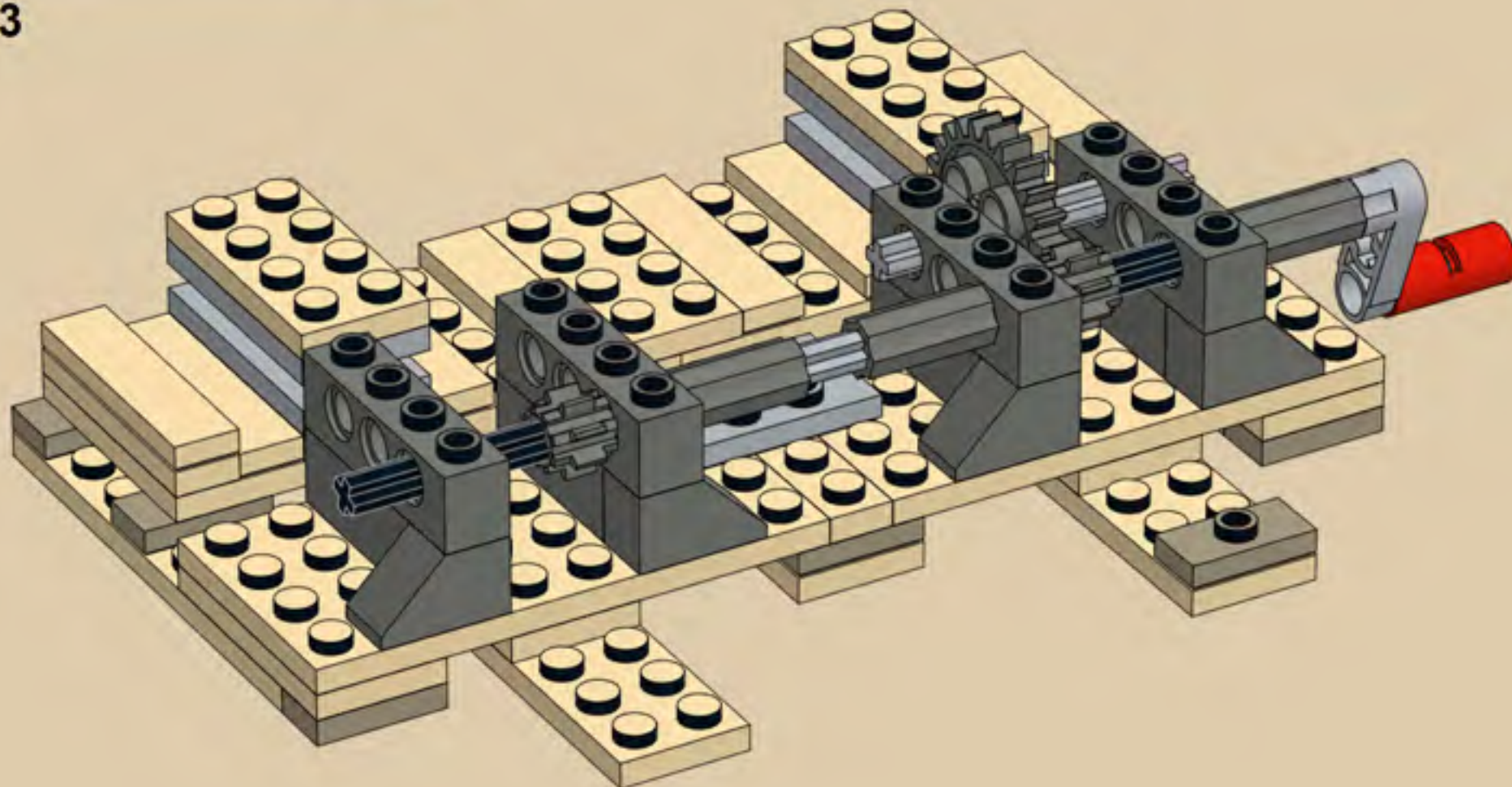

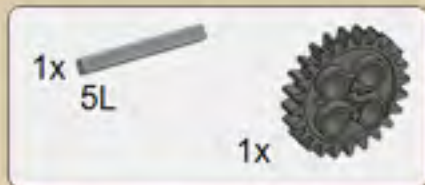

14 Ensure 24 tooth gear axes are oriented the same

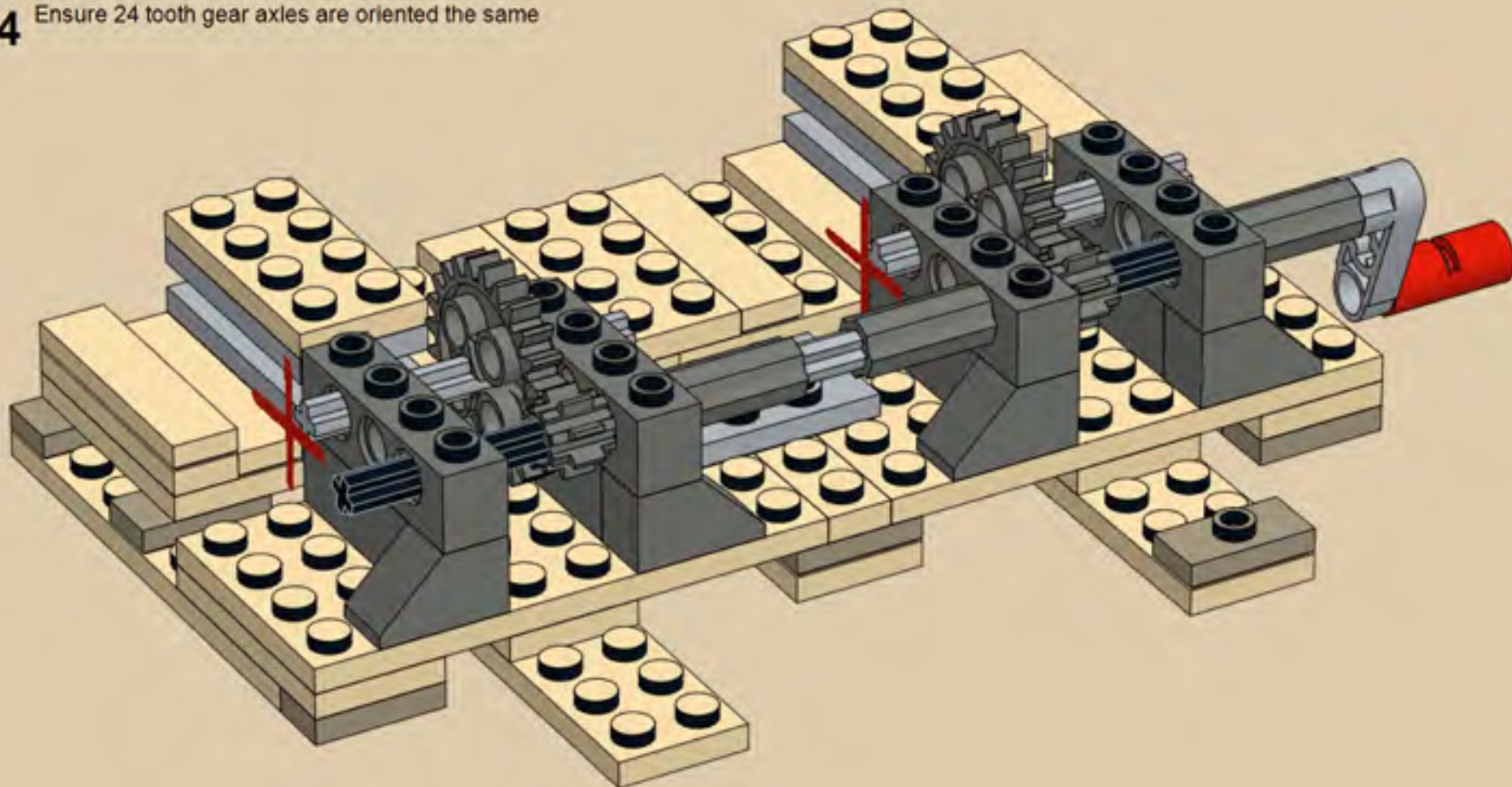

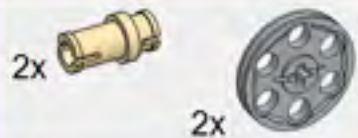

15 Ensure belt wheels and pins are oriented as shown

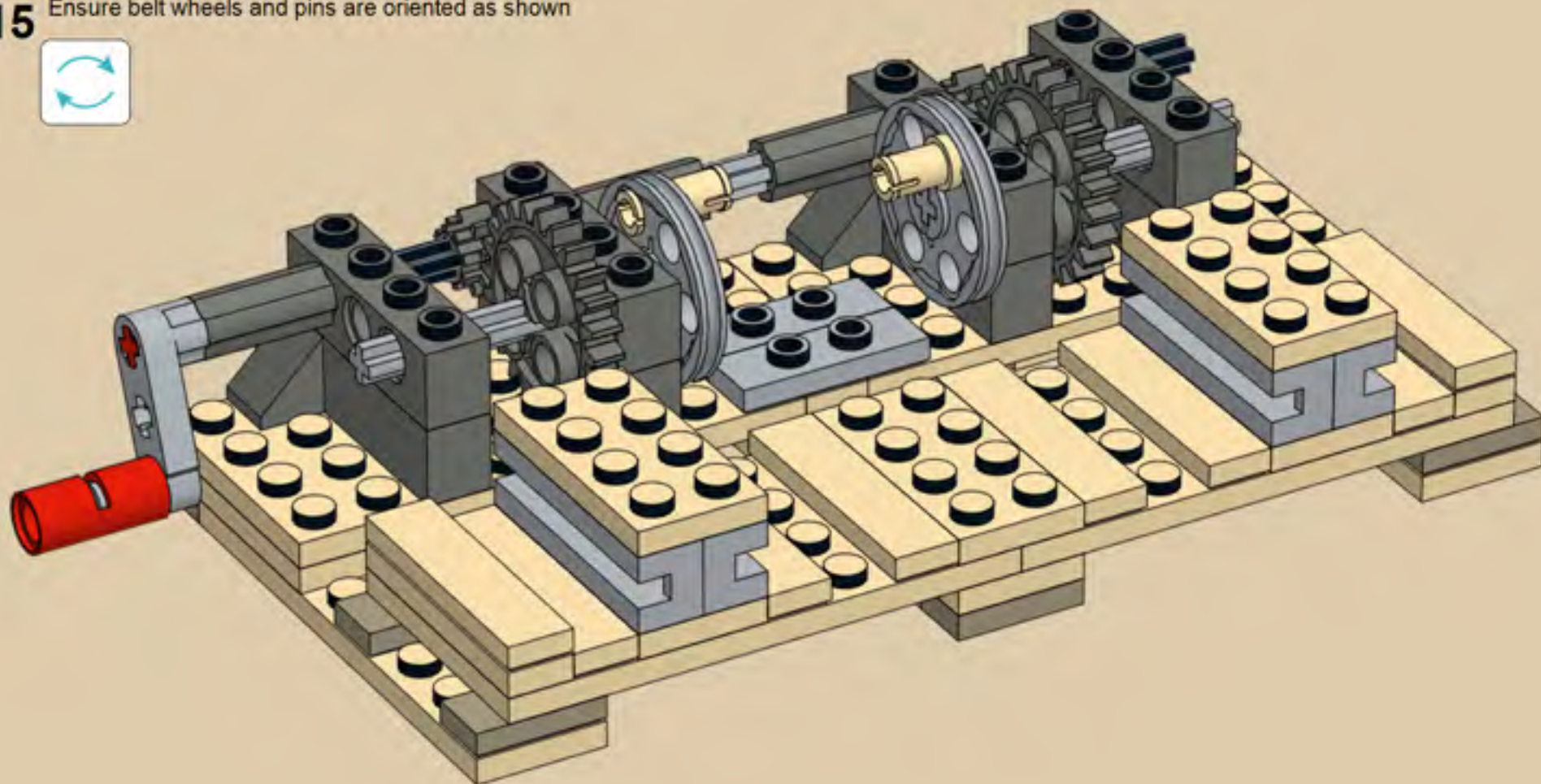



16 Ensure belt wheels and pins are oriented as shown

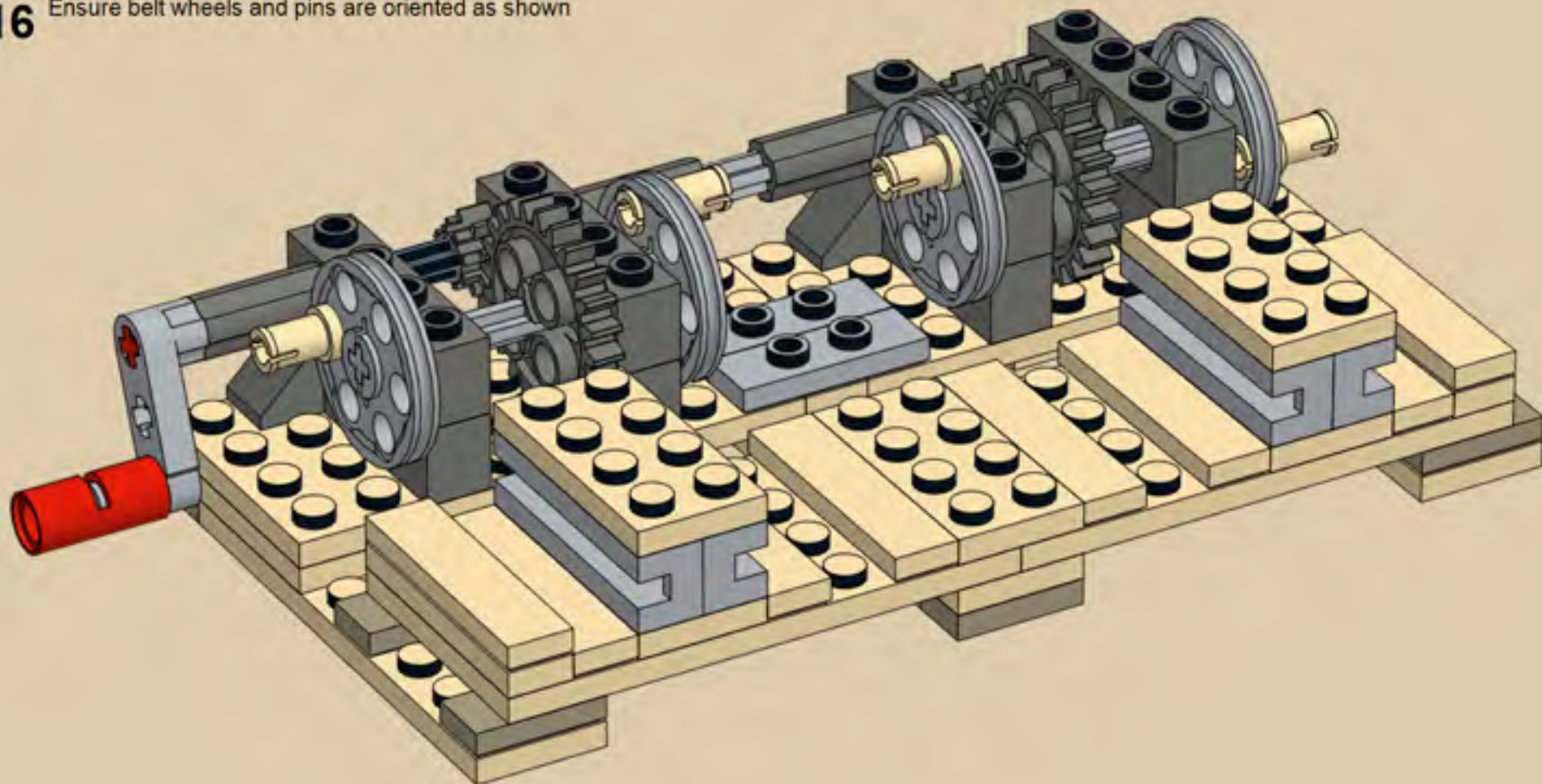



17

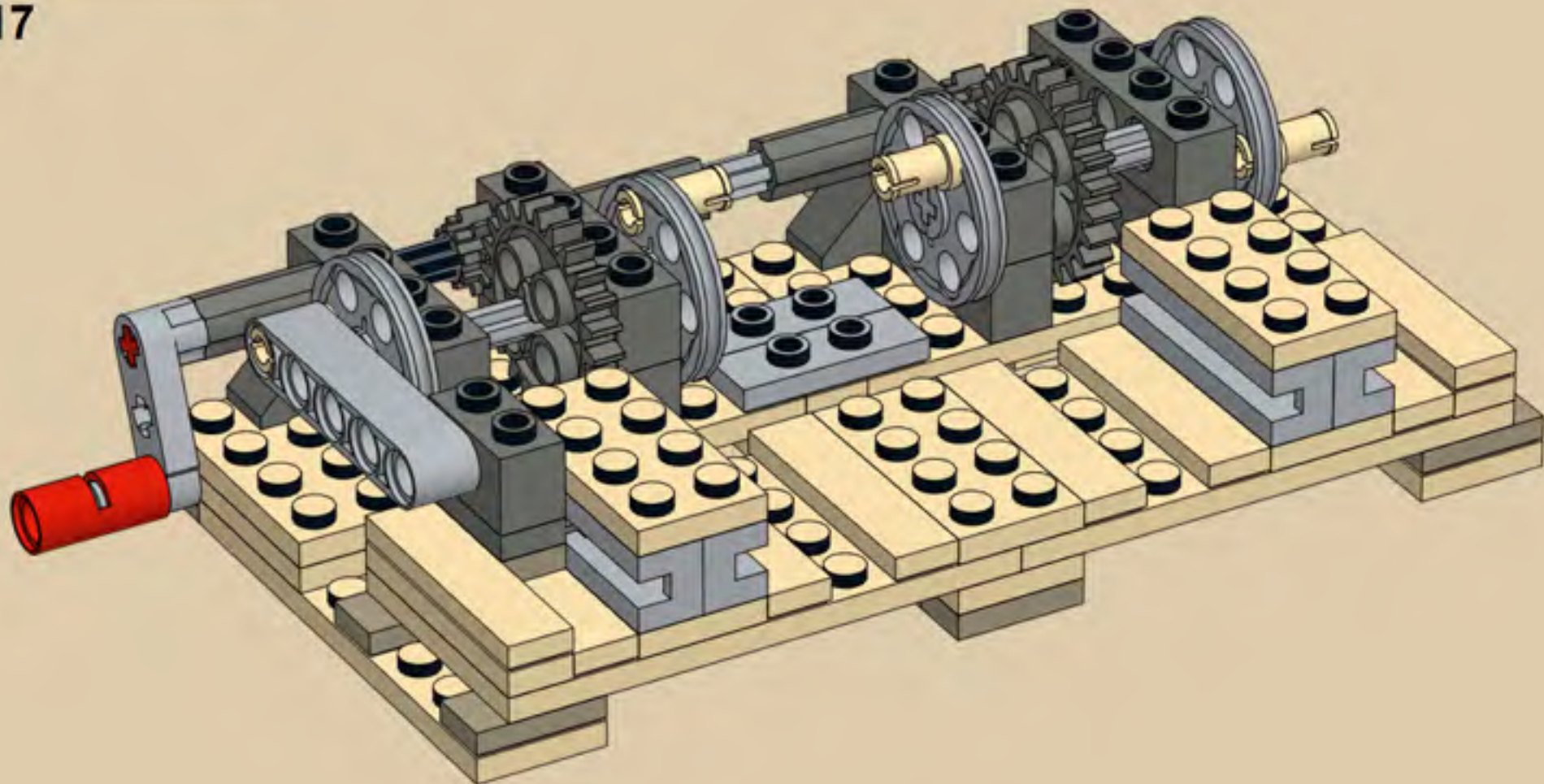

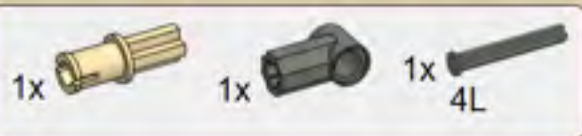

18

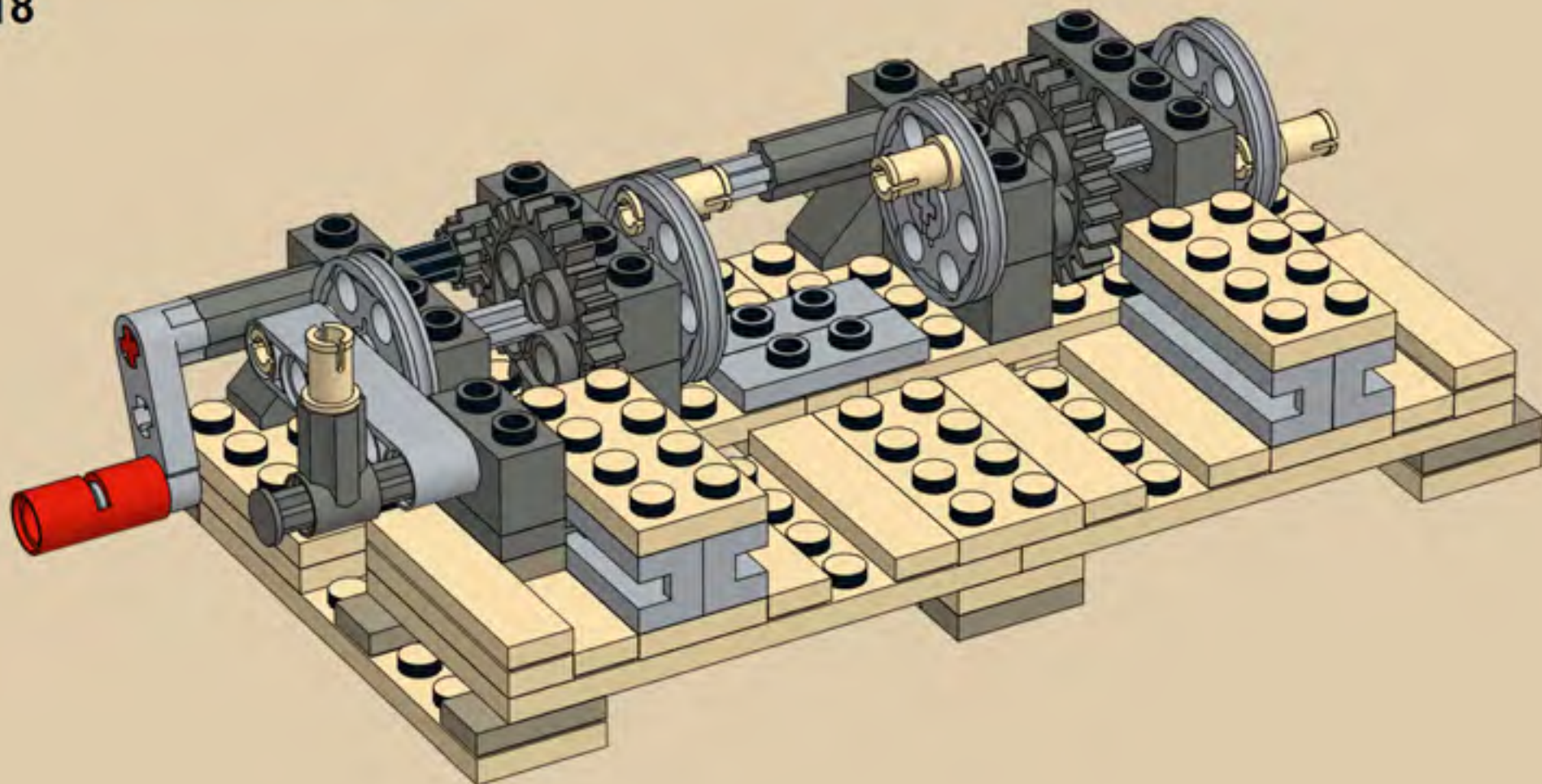

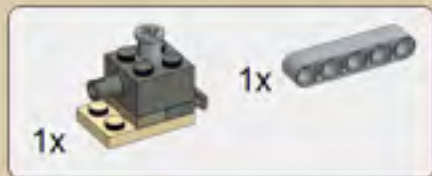

19

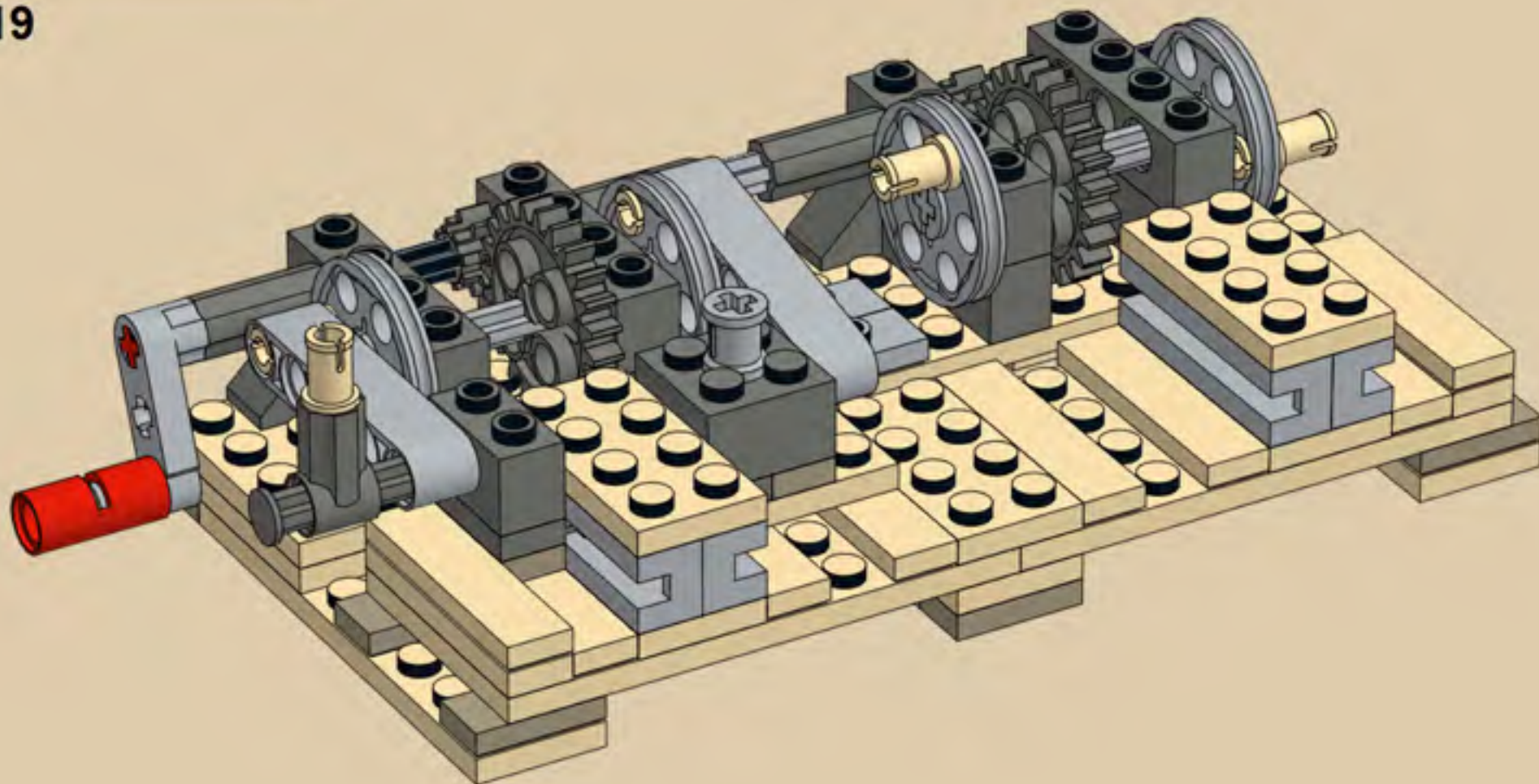

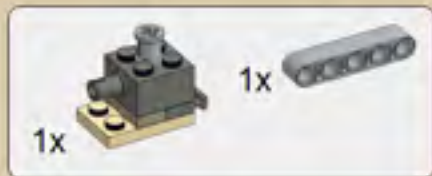

20

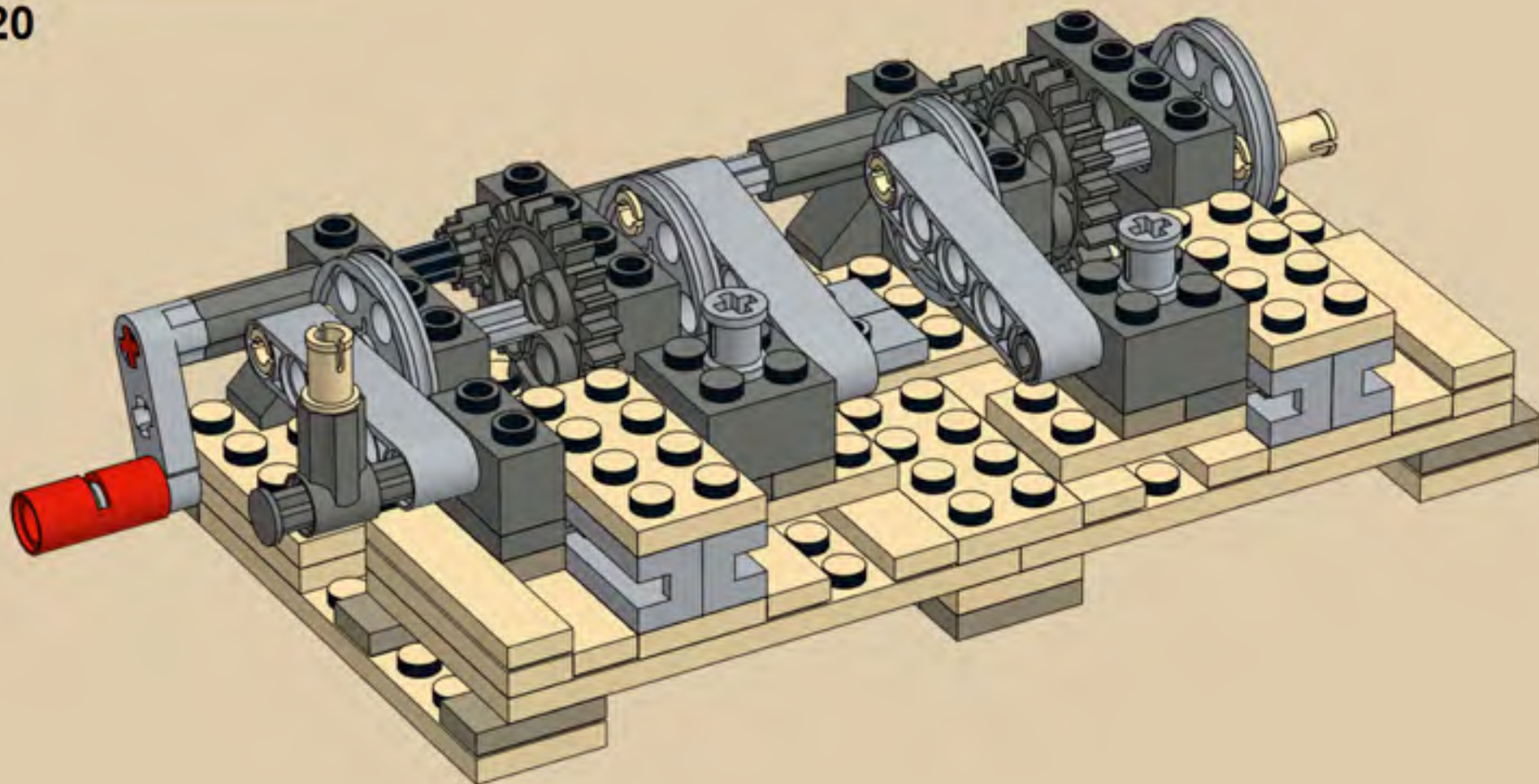



21

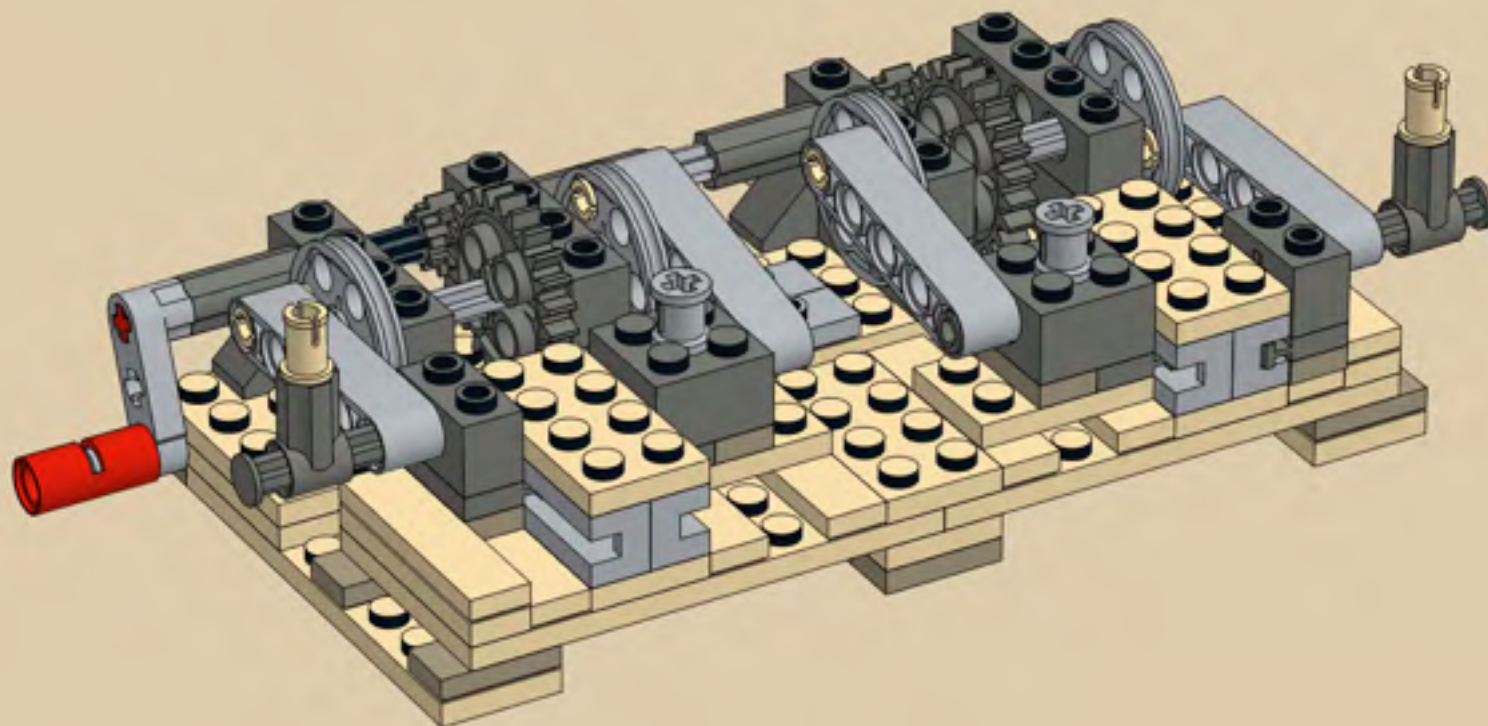

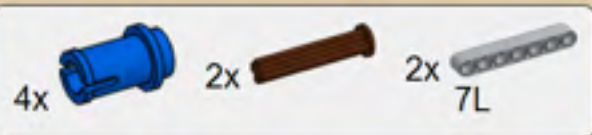

22

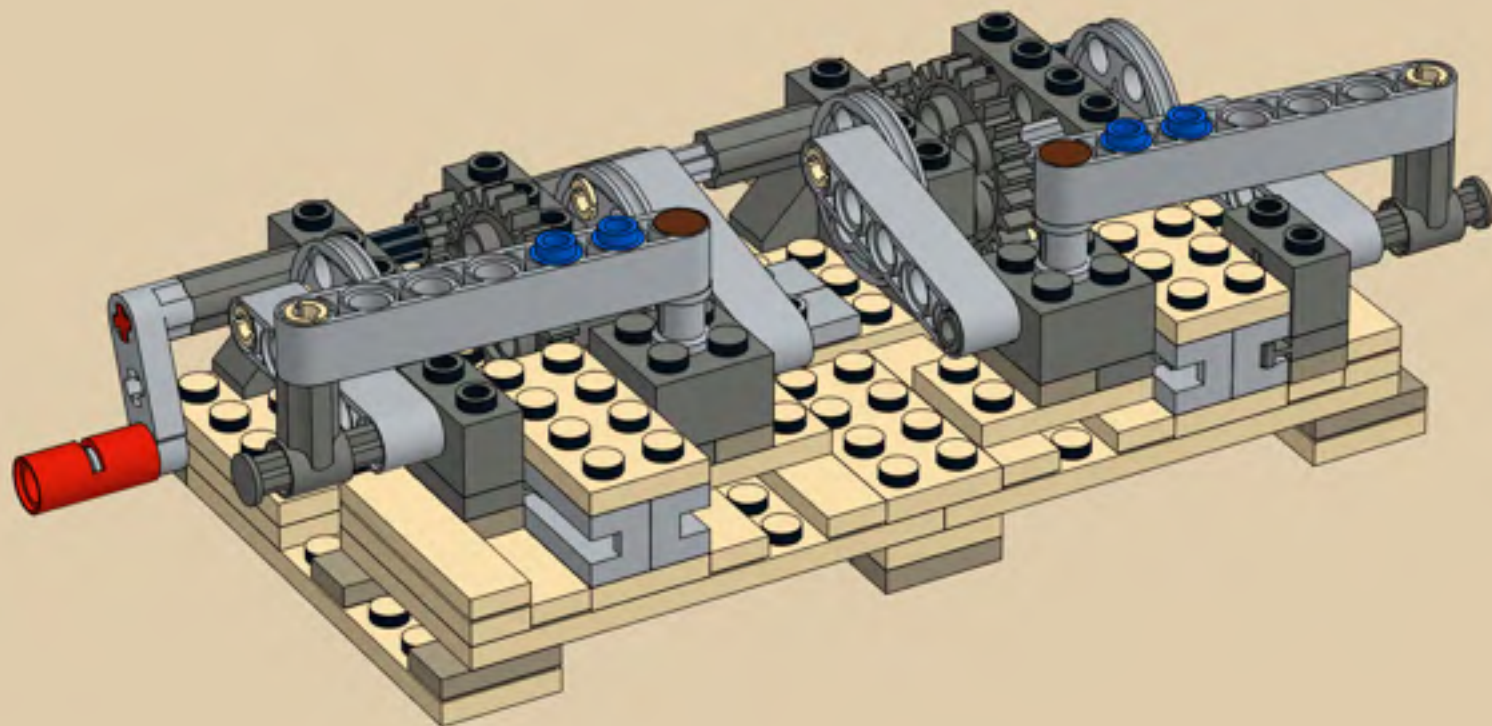

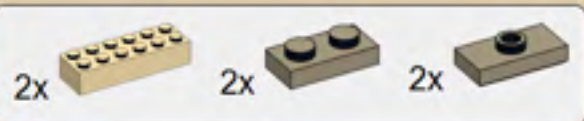

23

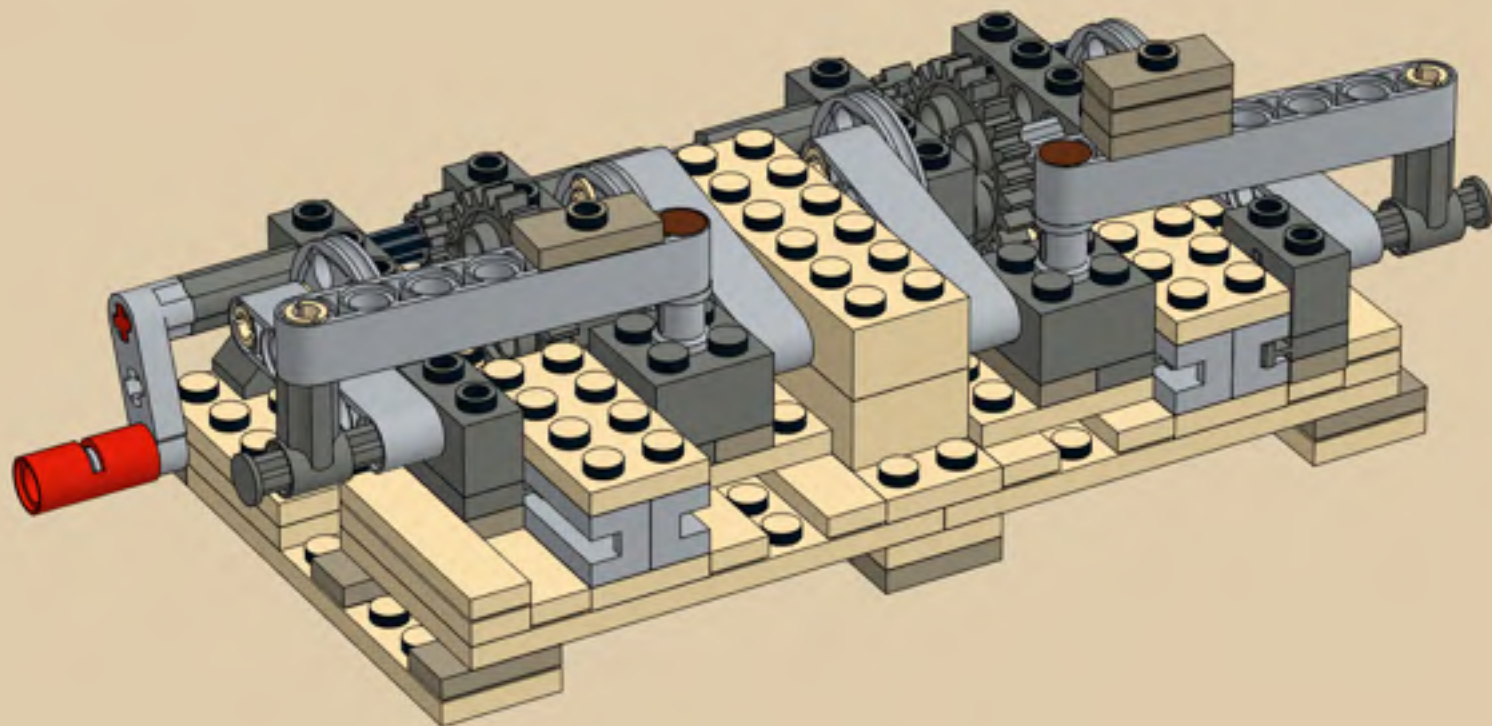



24

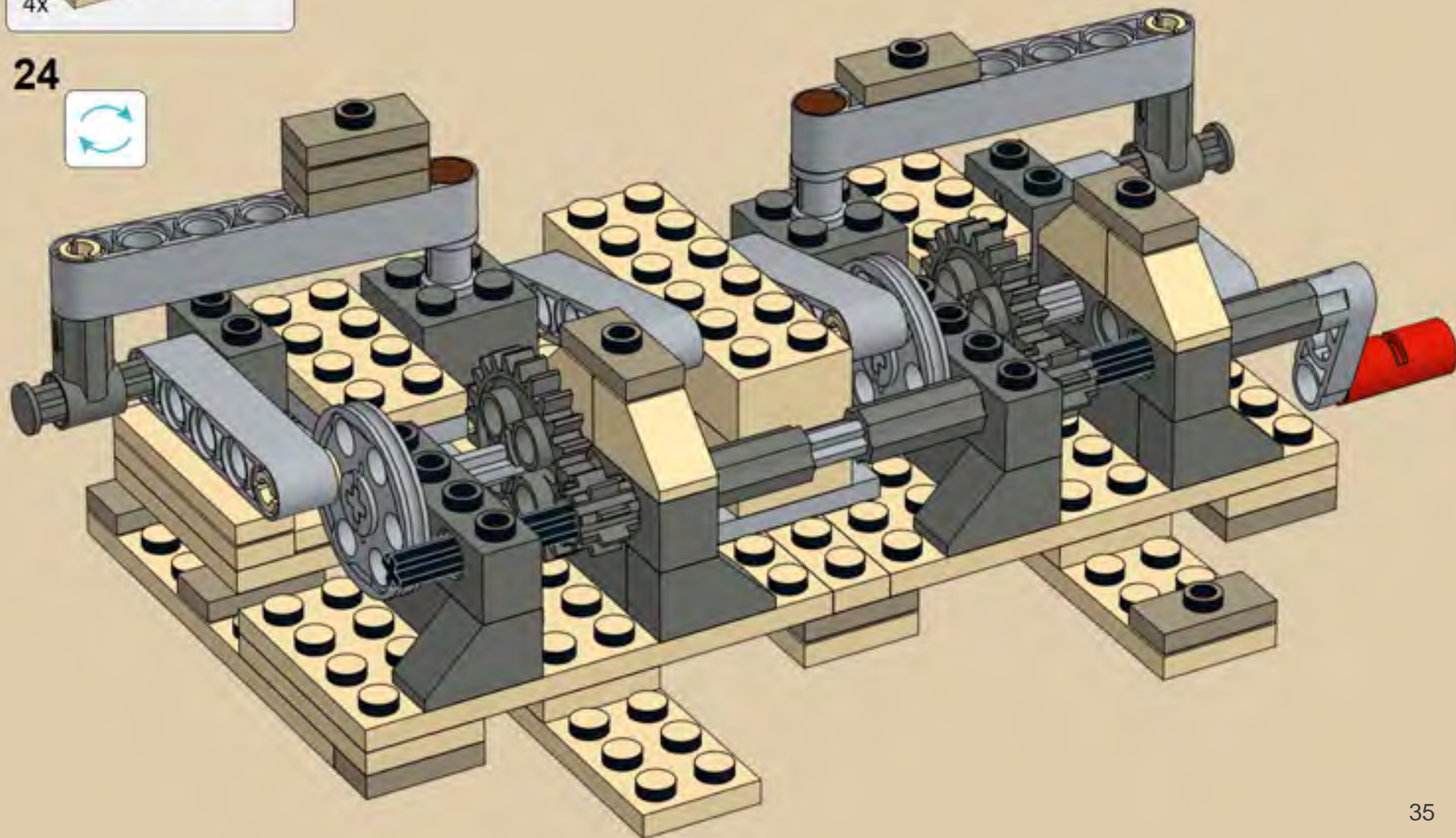



25

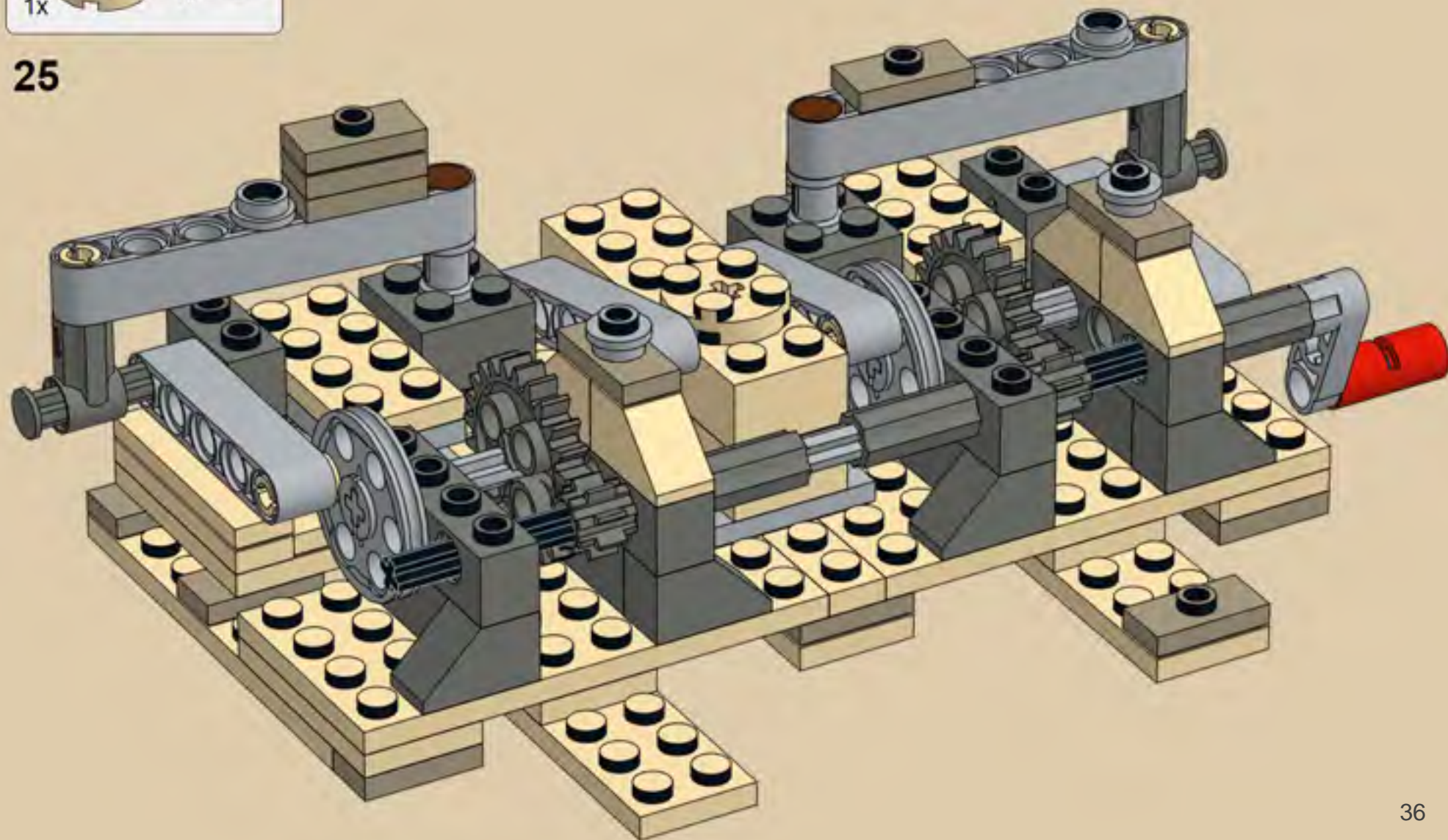



26

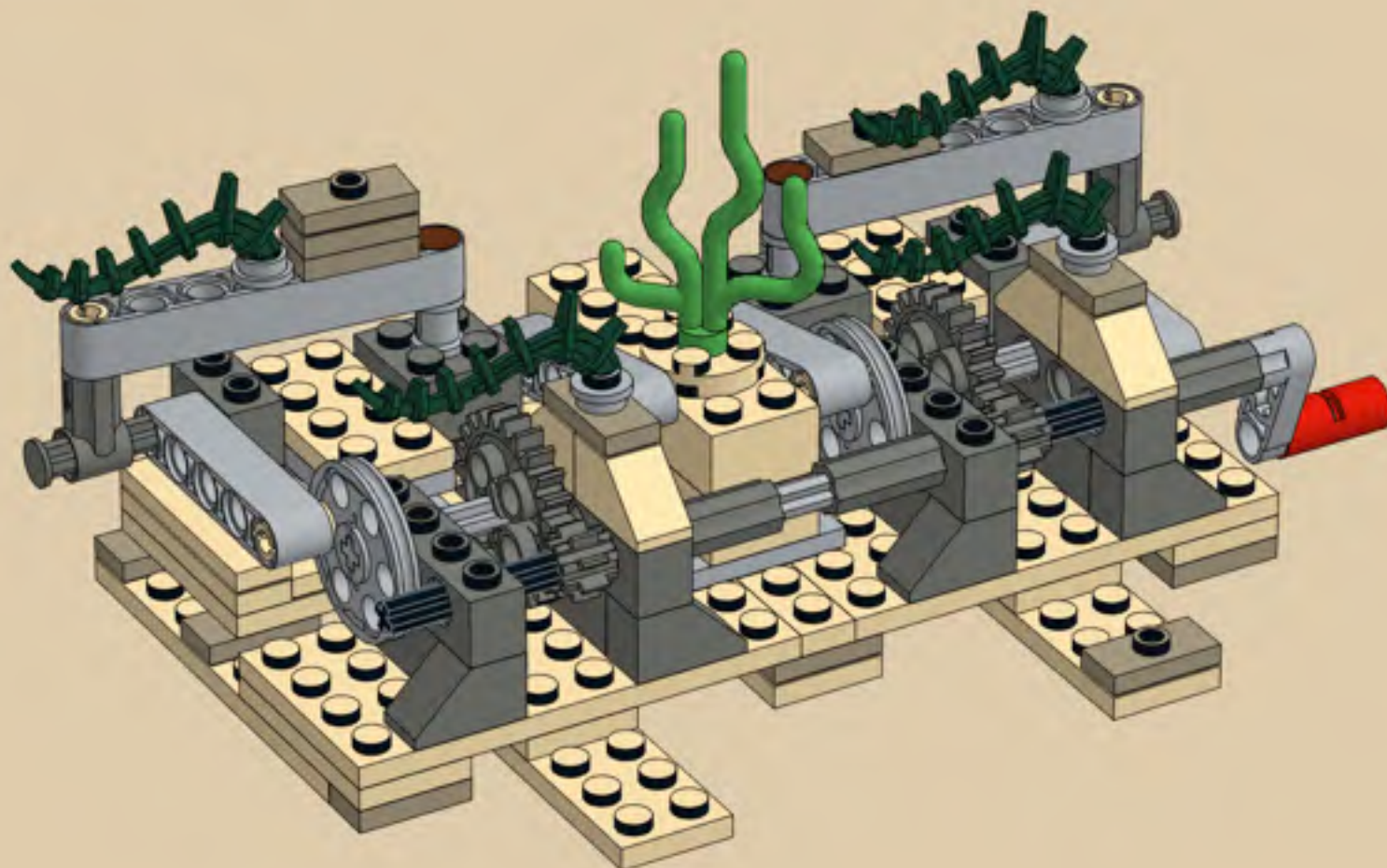

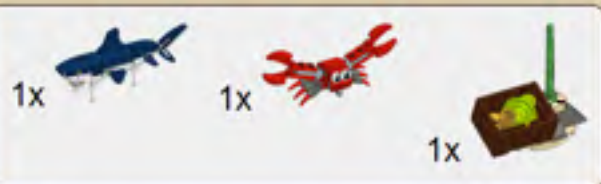

27

