

10

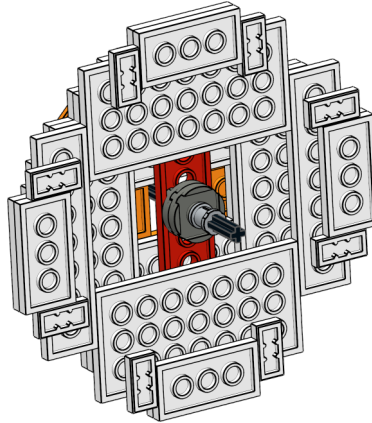

11

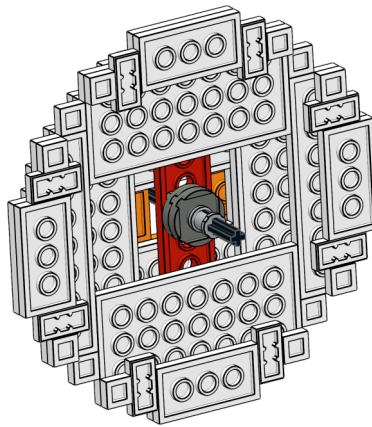

12

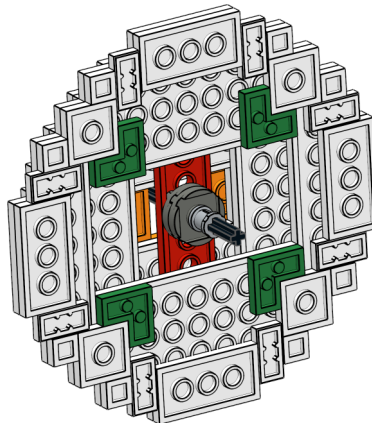

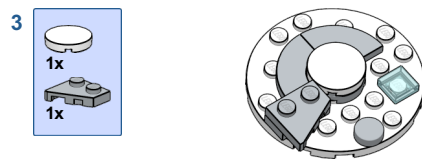
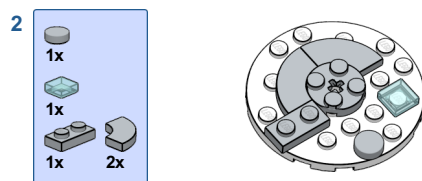
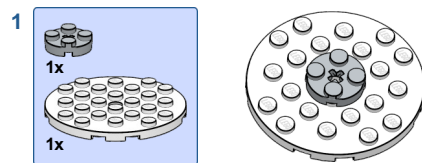

1

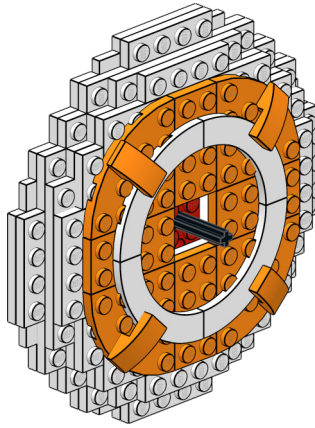

2

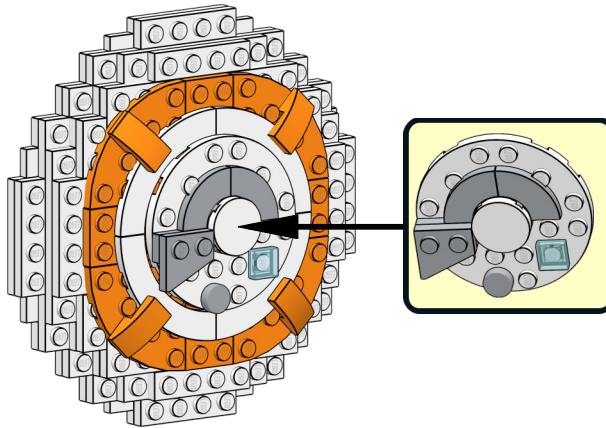

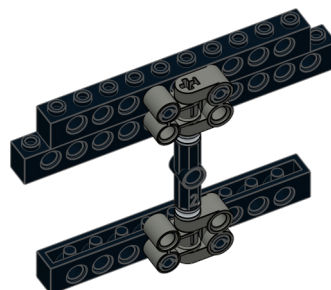
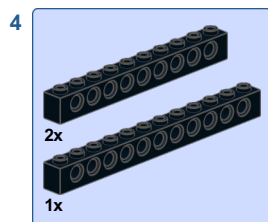
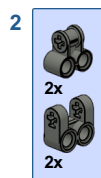
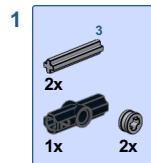

3

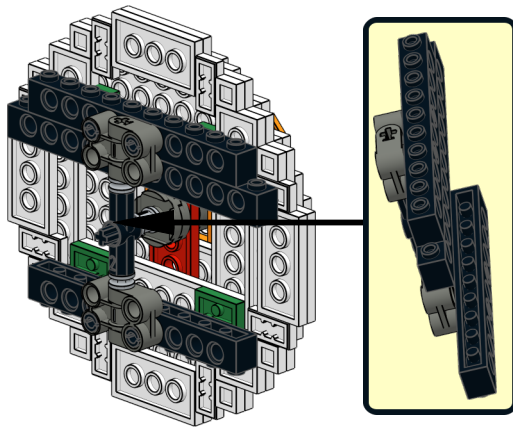

4

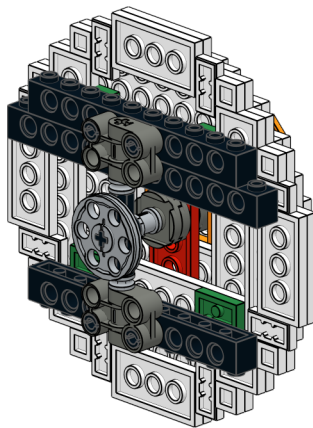

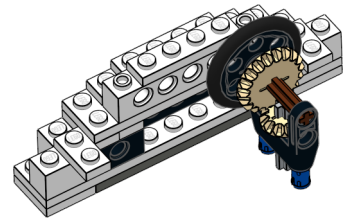
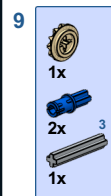
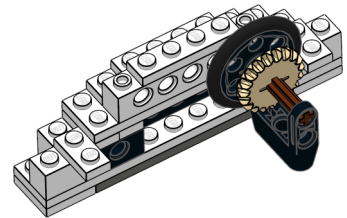
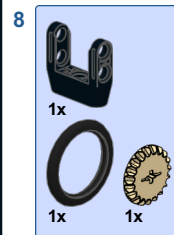
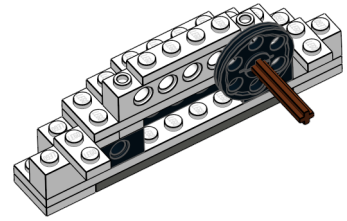
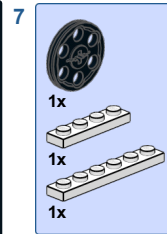
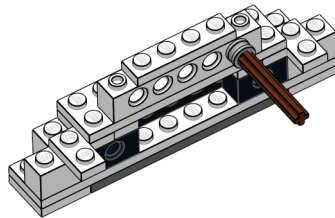
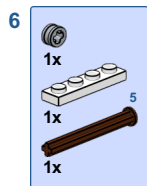
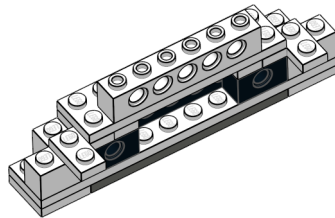
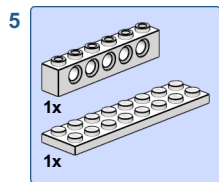
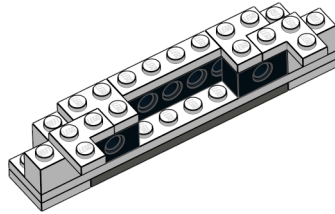
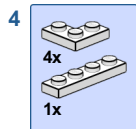
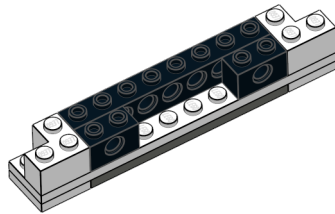
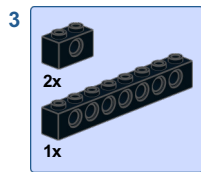
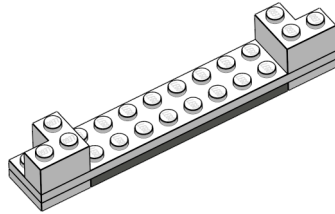
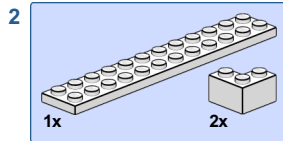
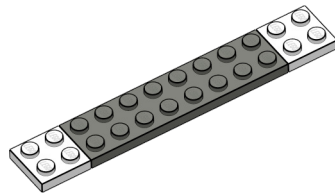
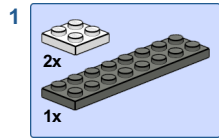

5

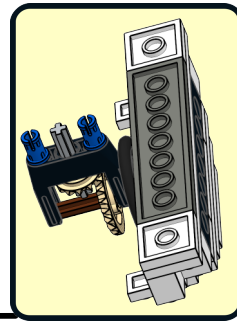
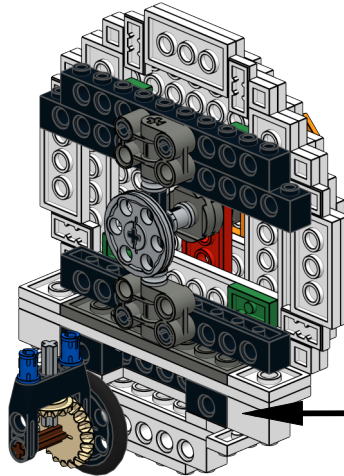

6

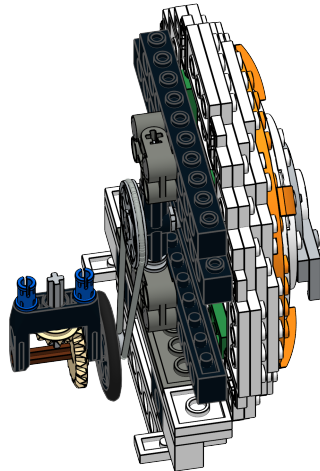

**TIP: use the 4x4 studs LEGO rubber band
(it comes in light gray color)**

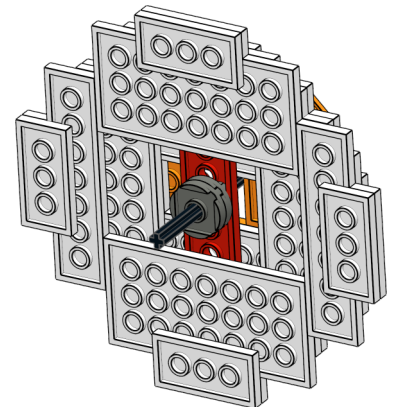
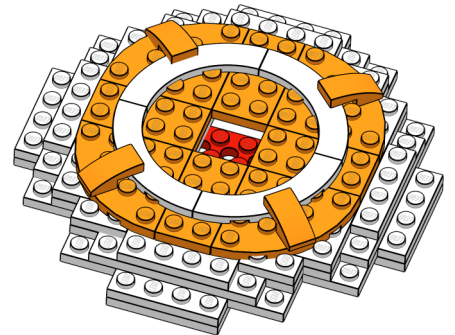
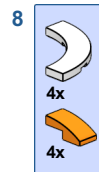
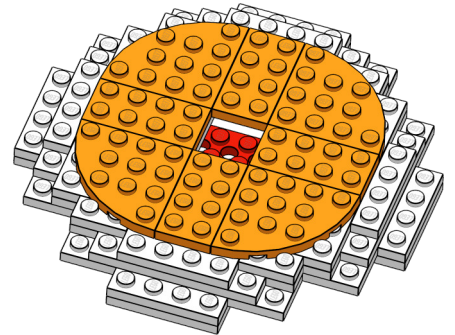
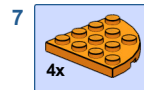
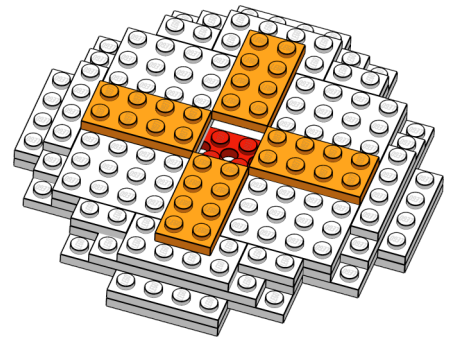
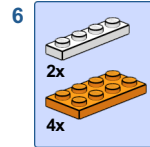
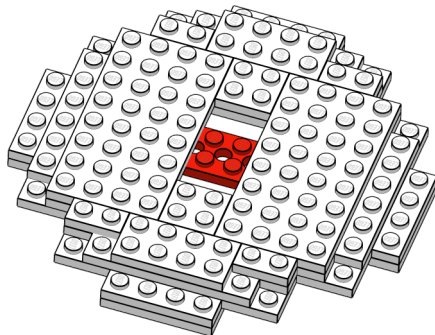
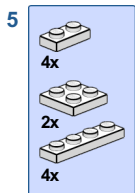
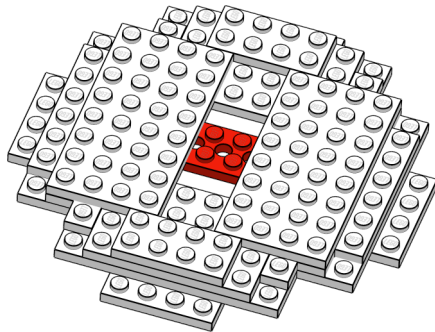
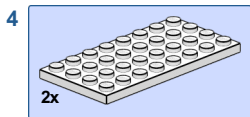
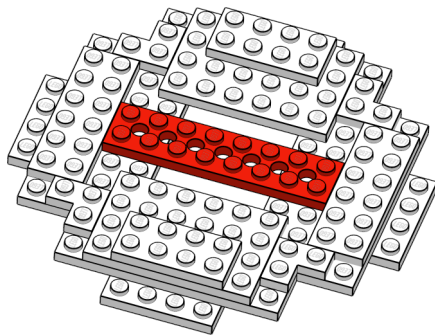
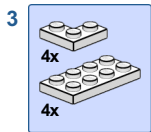
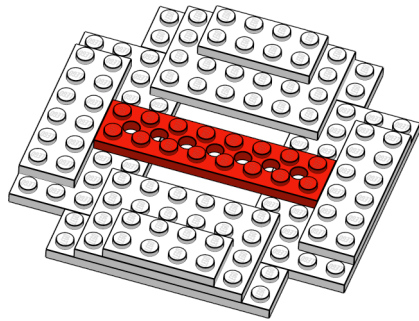
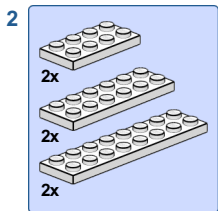
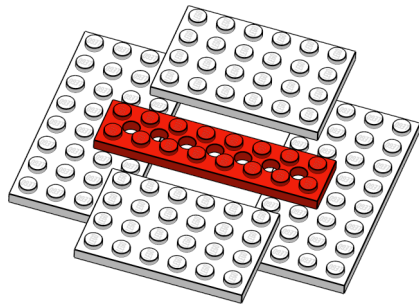
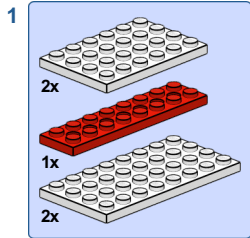

10

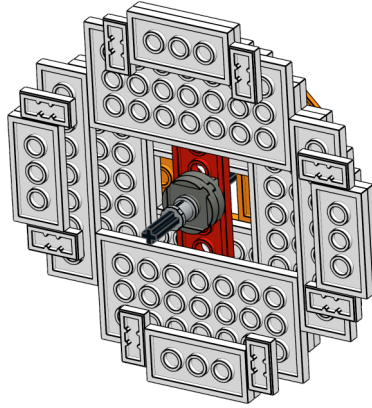
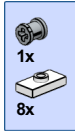

11

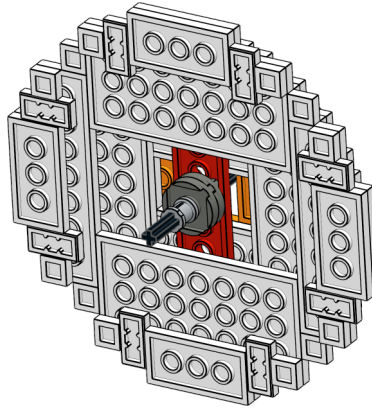

12

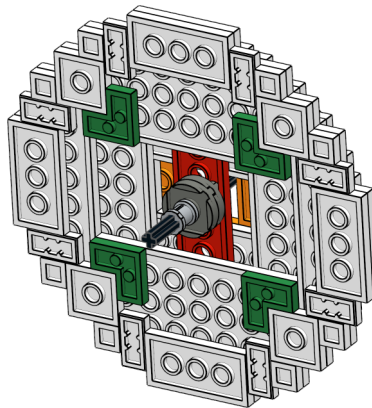
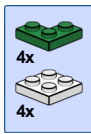

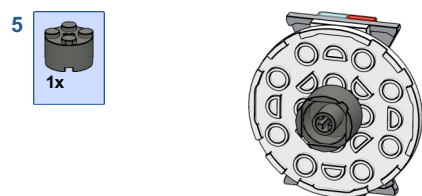
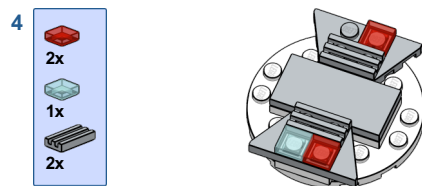
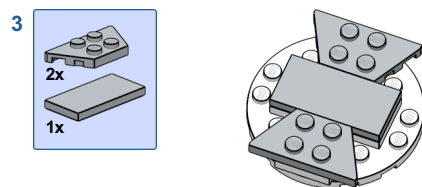
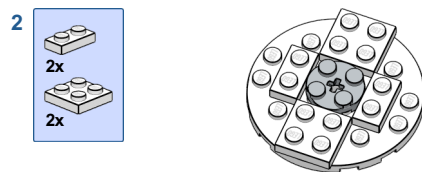
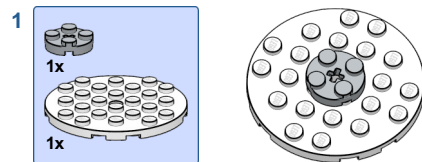

1

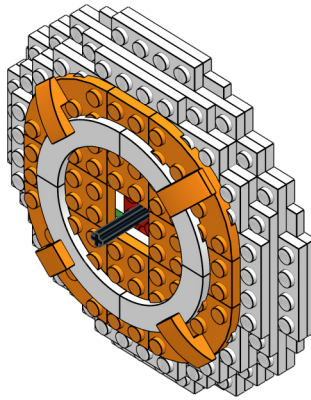

2

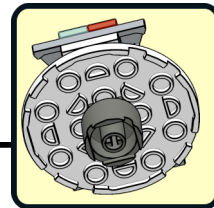
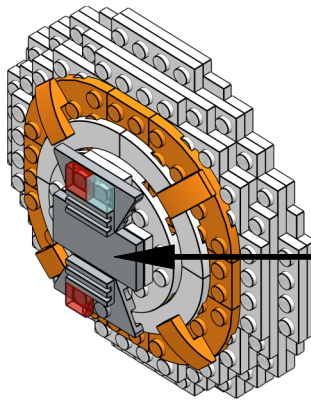

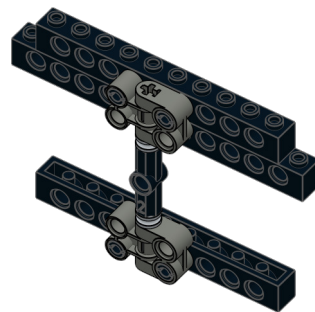
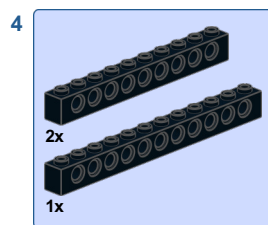
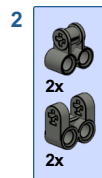
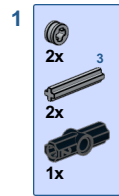

3

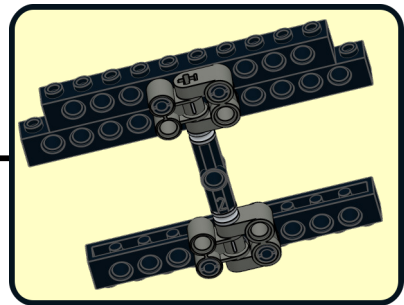
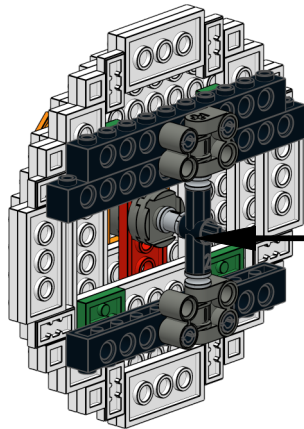

4

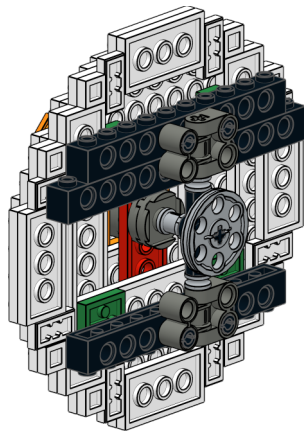

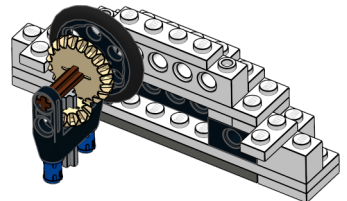
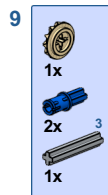
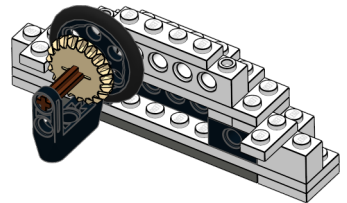
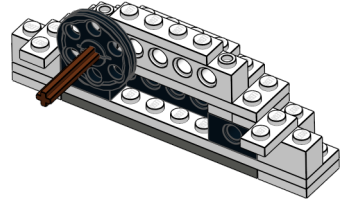
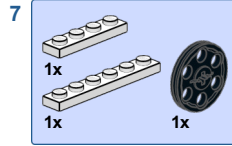
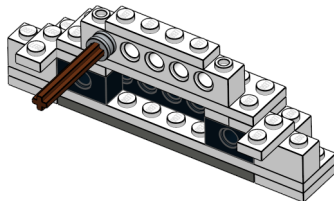
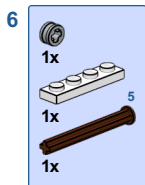
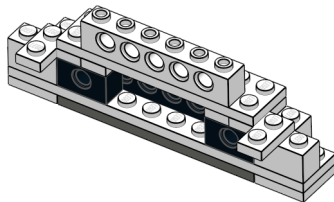
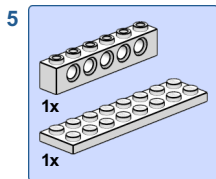
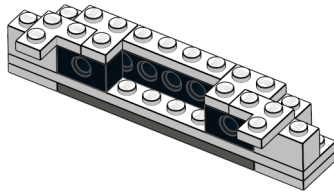
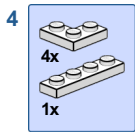
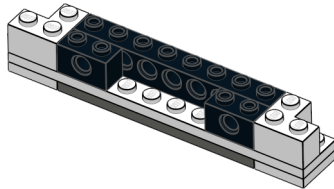
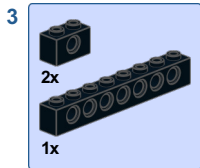
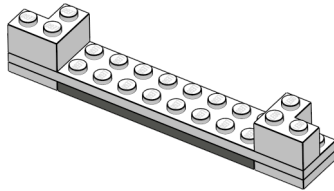
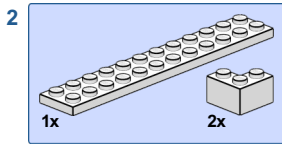
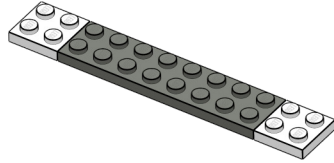
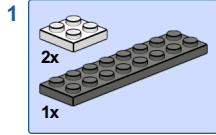

5

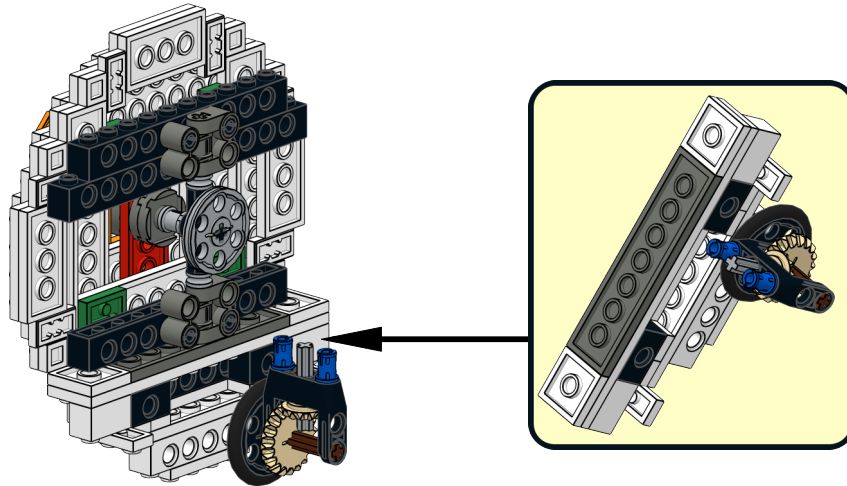

6

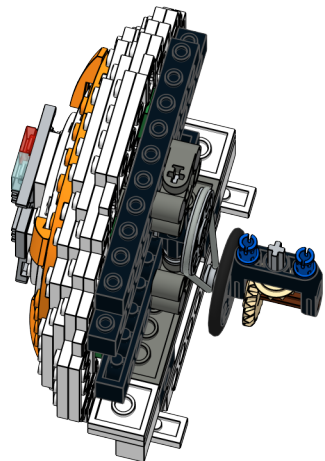

TIP: use the 4x4 studs LEGO rubber band (it comes in light gray color)

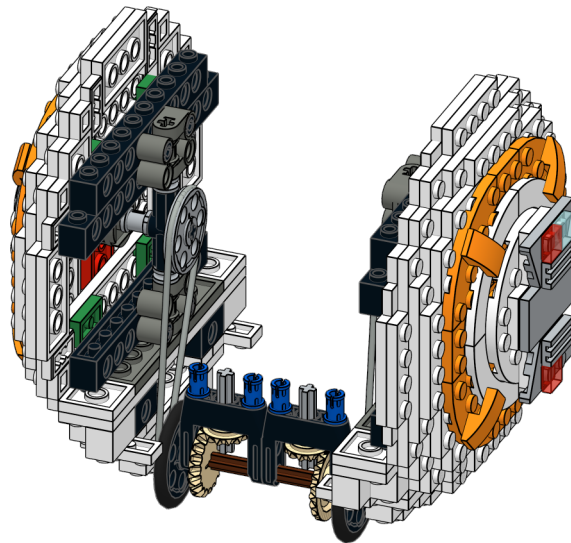

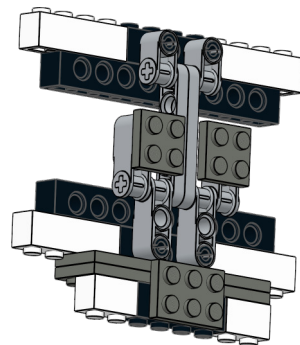
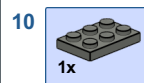
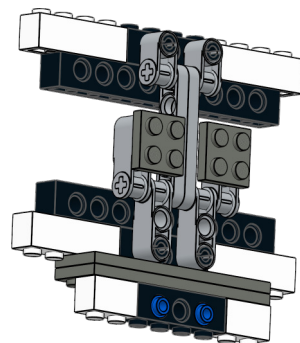
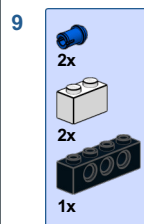
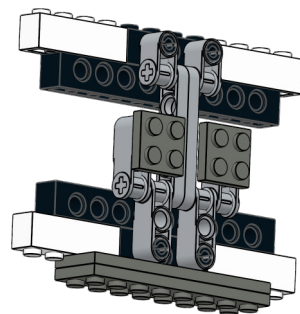
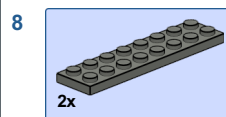
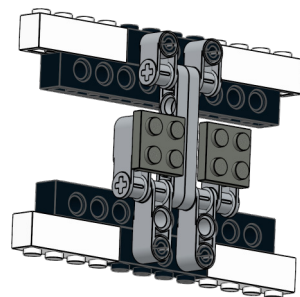
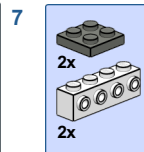
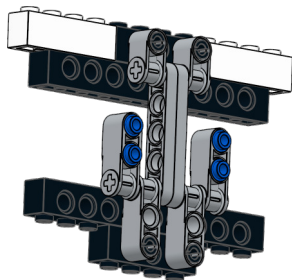
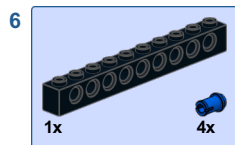
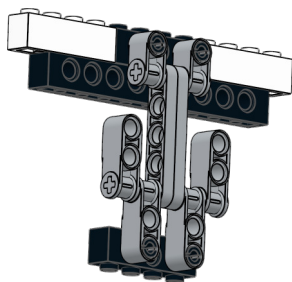
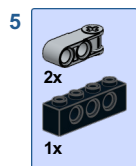
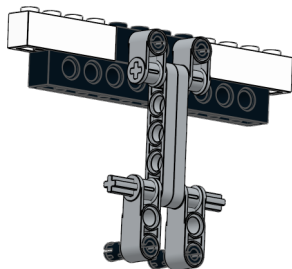
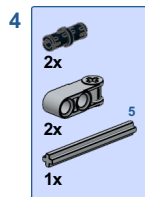
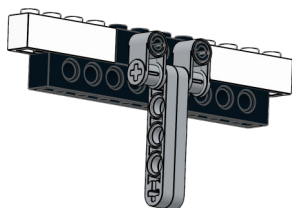
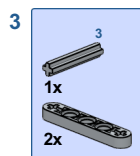
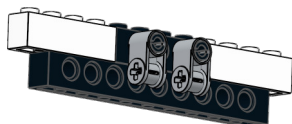
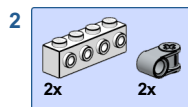
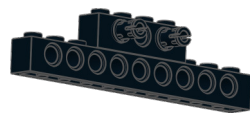
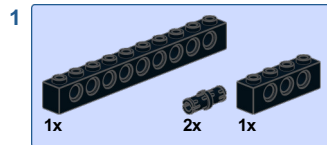

8

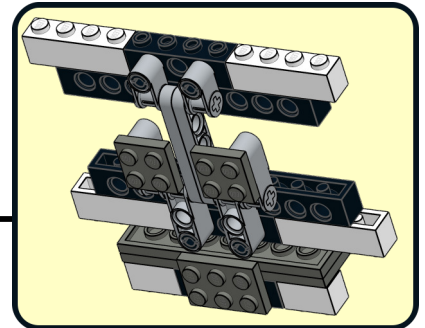
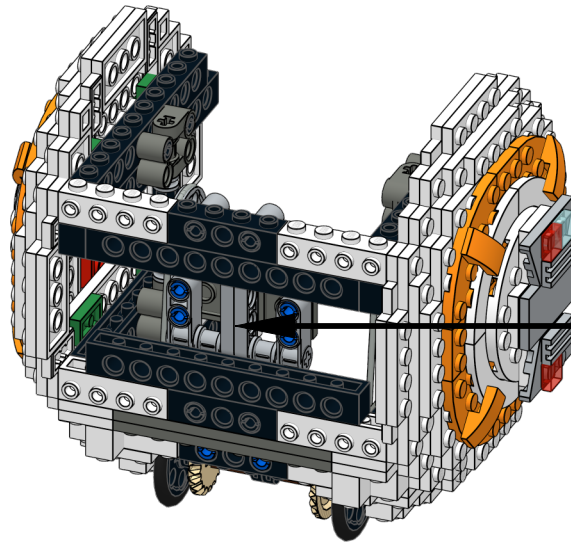

9

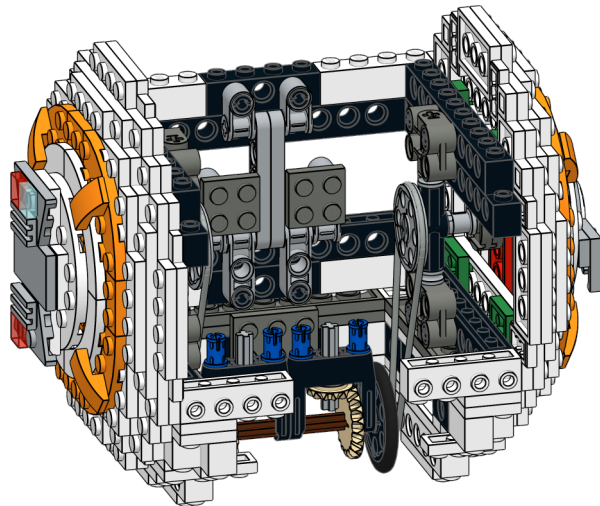
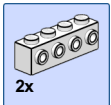

10

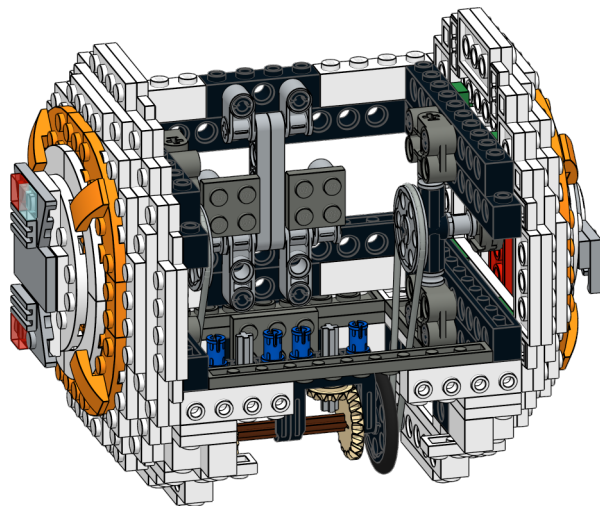
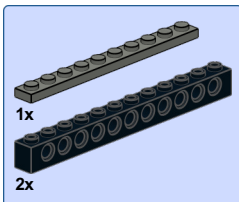

11

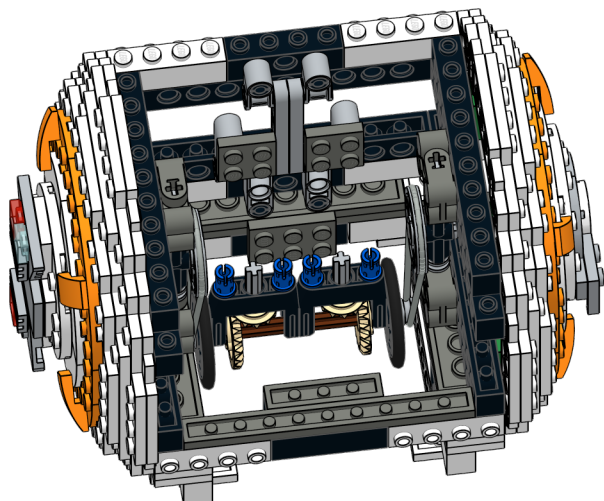
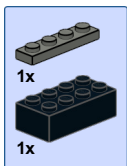

12

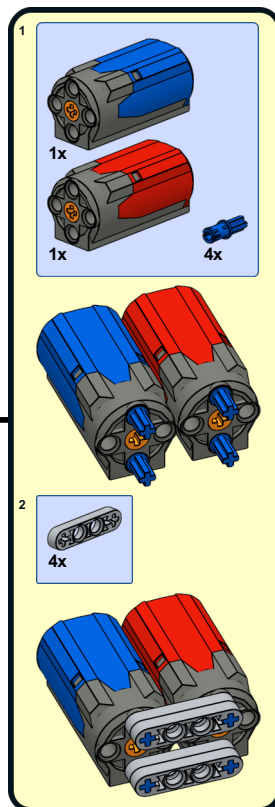
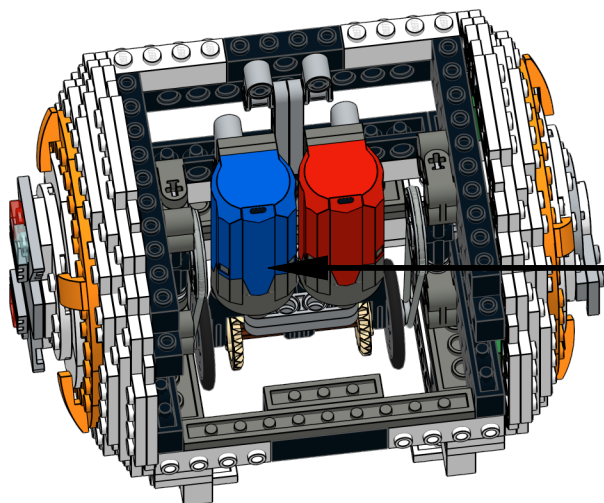

**TIP: blue and red plugs connect blue and red PF M motors respectively.
Green plug is the PF extension wire that connects SBrick to the battery box (see next page).**

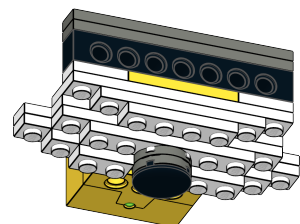
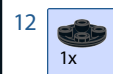
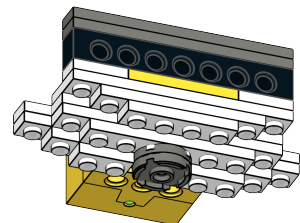
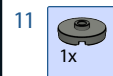
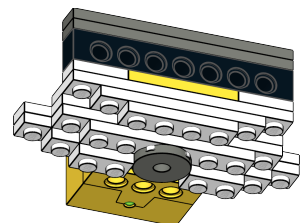
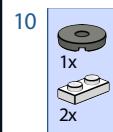
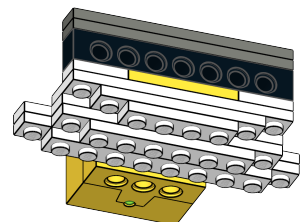
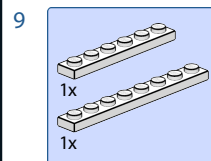
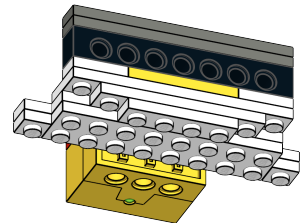
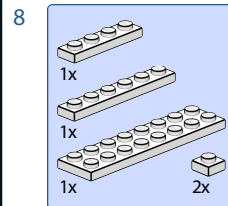
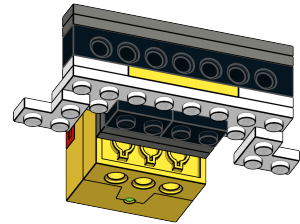
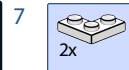
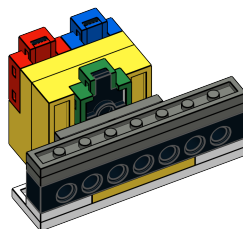
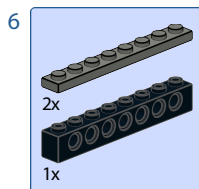
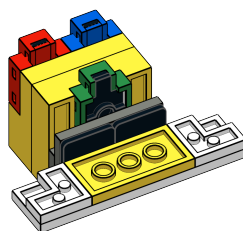
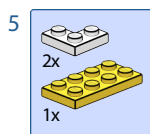
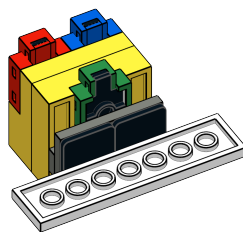
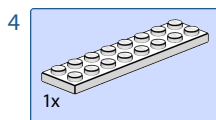
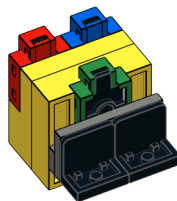
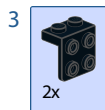
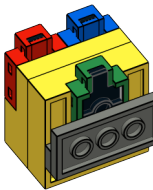
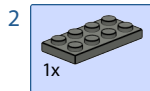
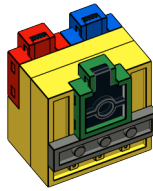
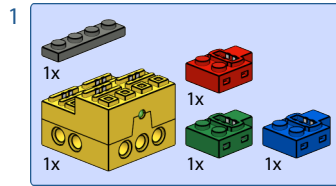

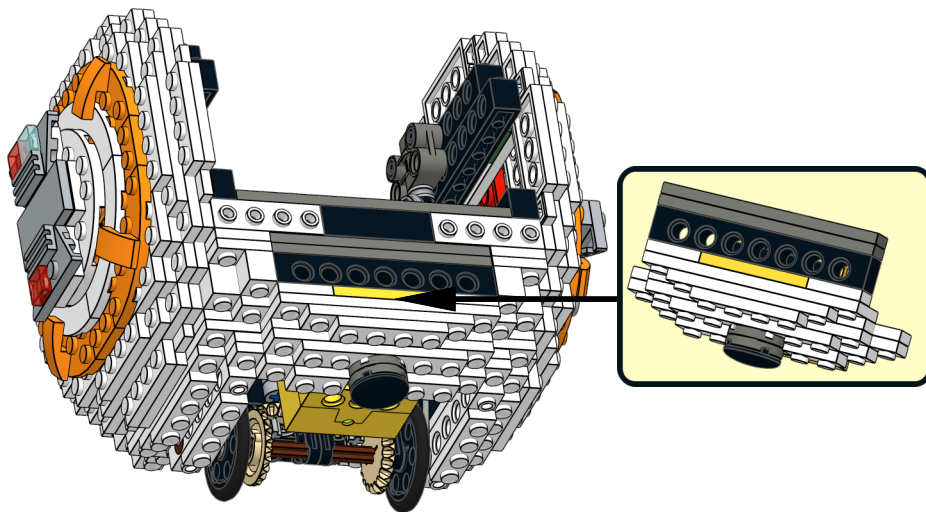

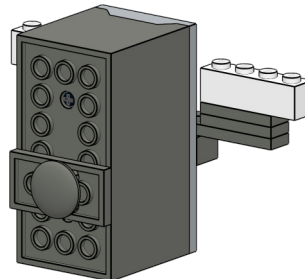
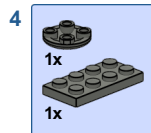
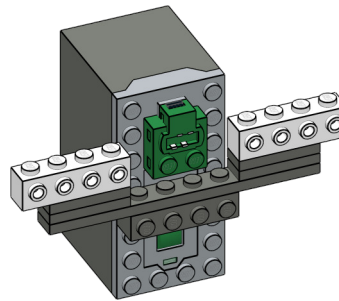
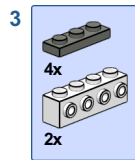
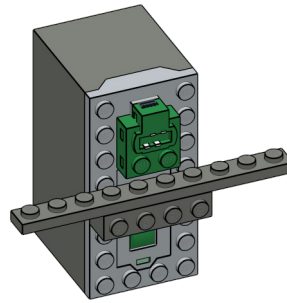
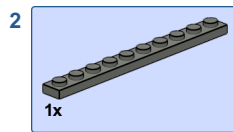
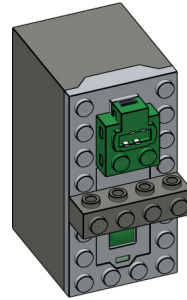
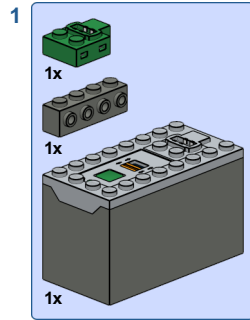

14

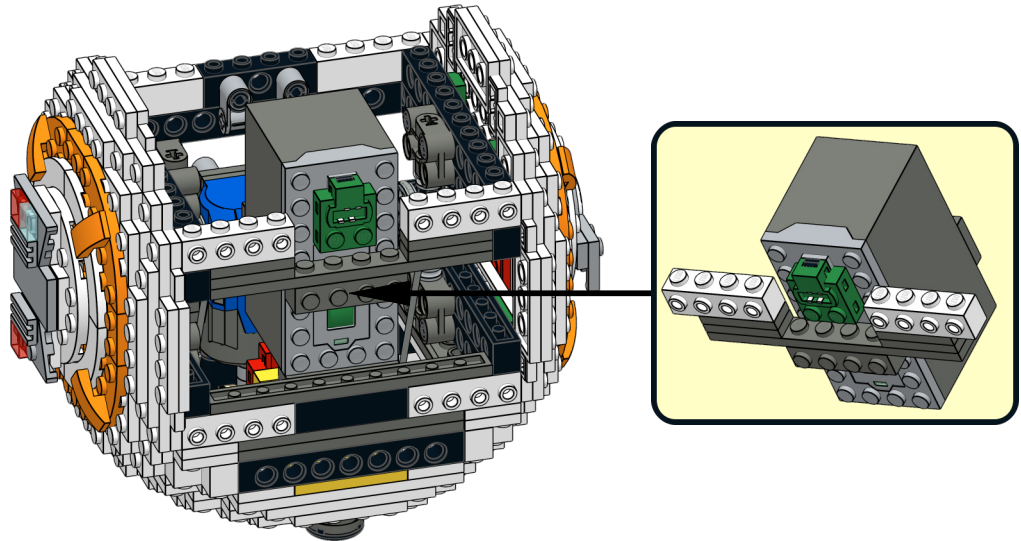

15

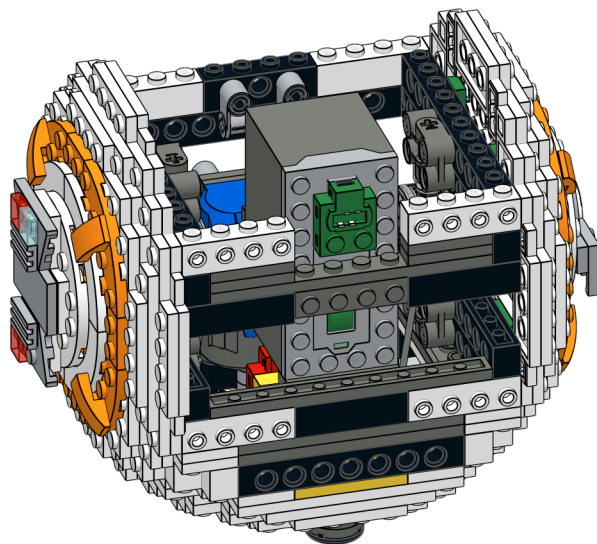
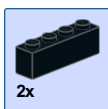

16

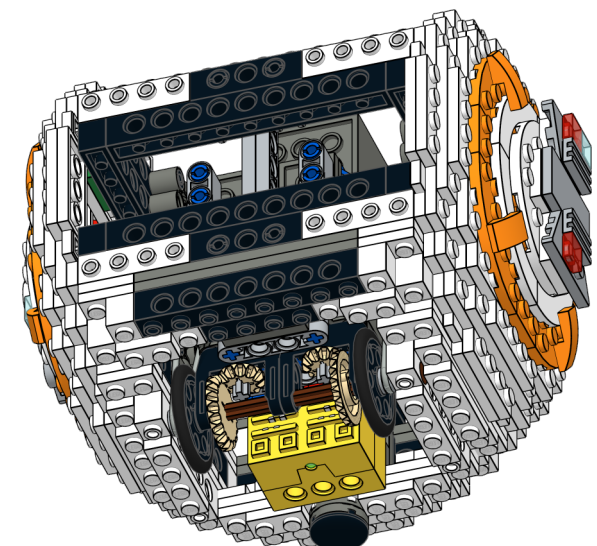
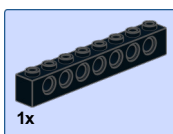

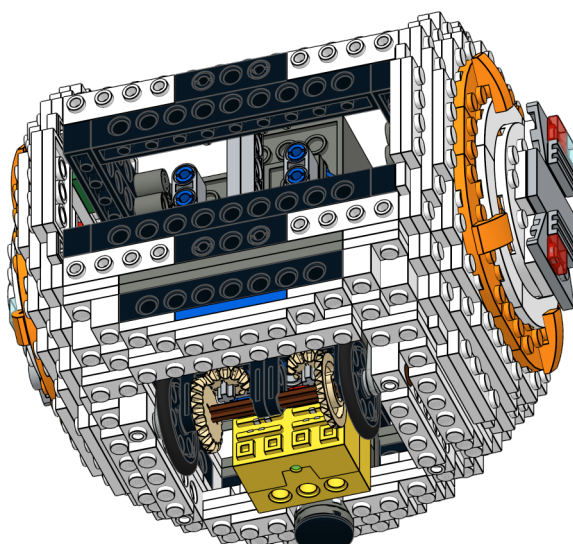
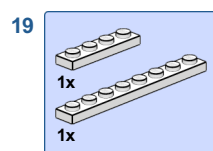
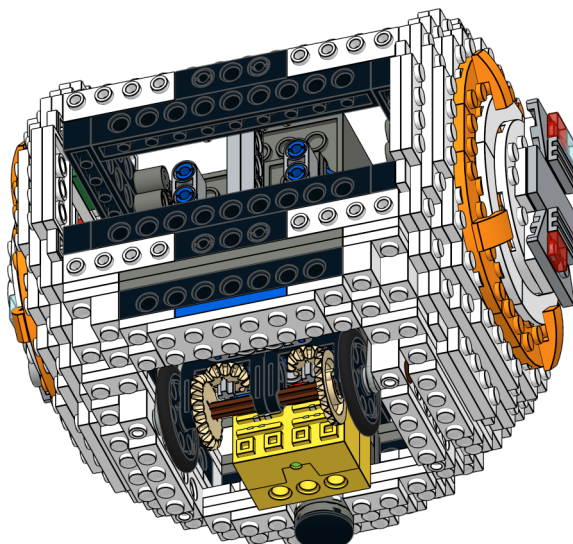
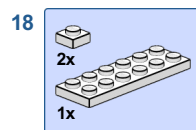
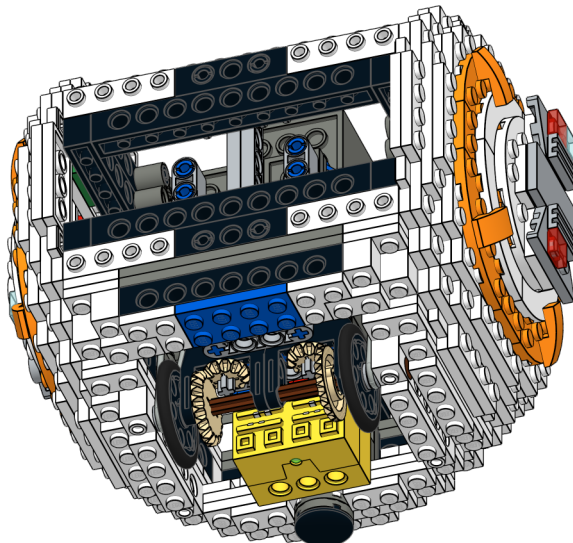
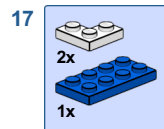

20

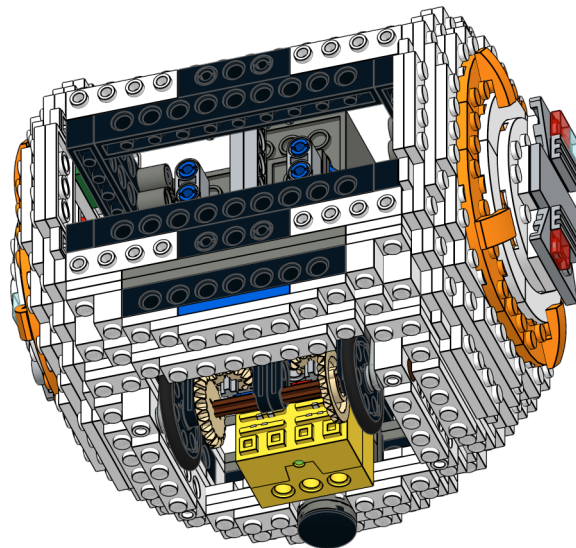
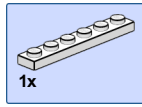

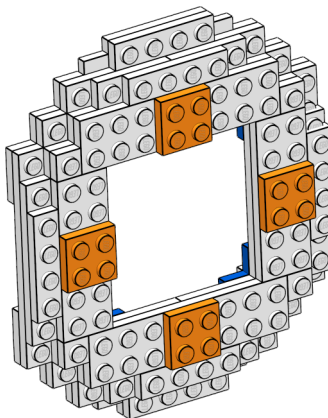
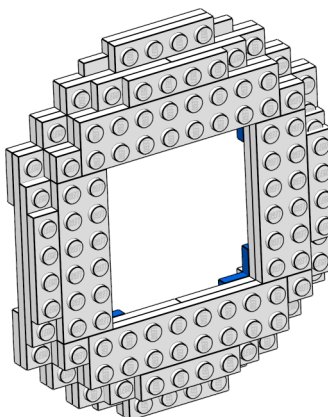
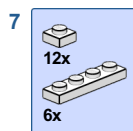
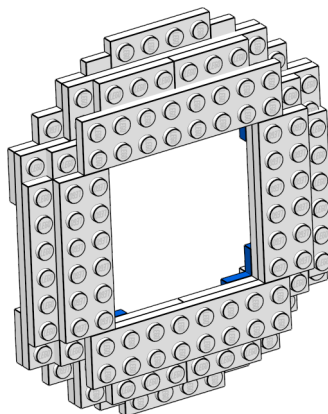
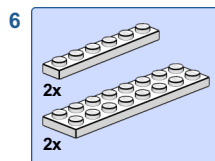
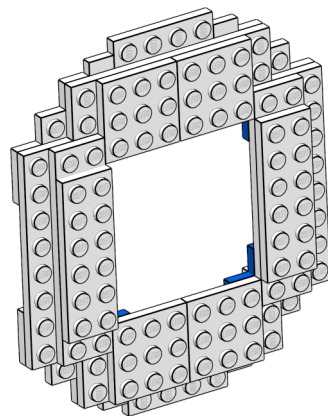
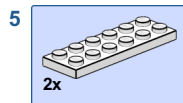
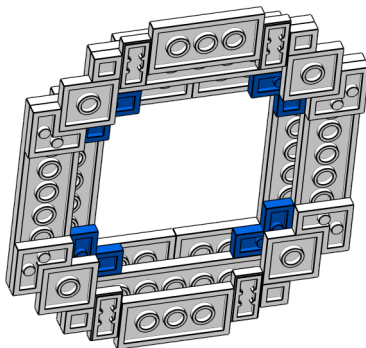
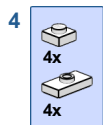
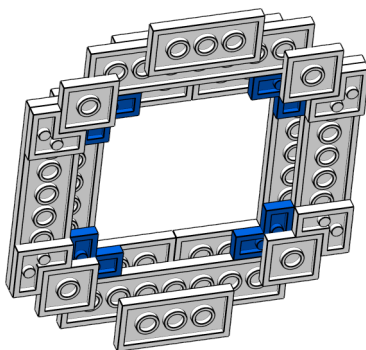
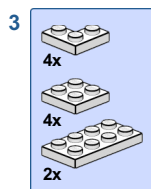
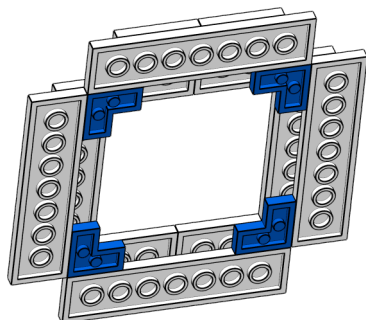
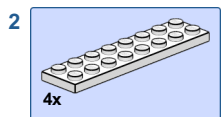
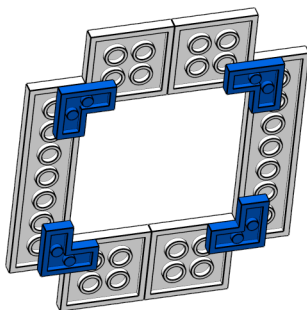
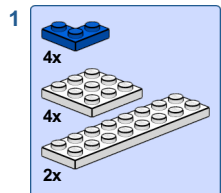

9

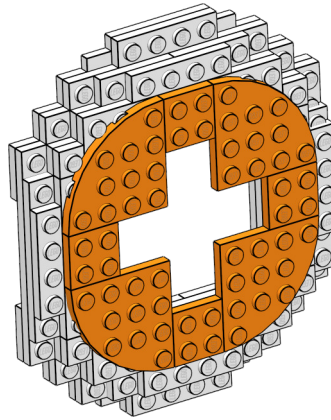

10

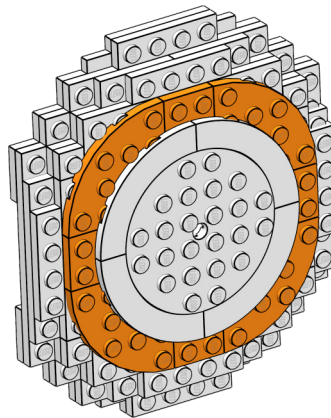
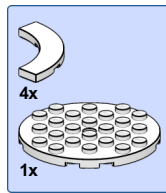

11

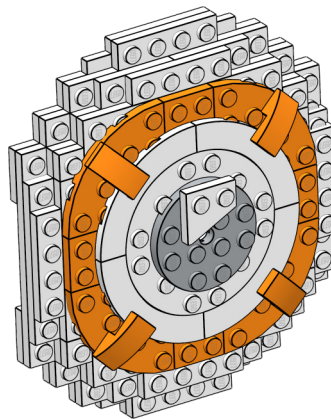

12

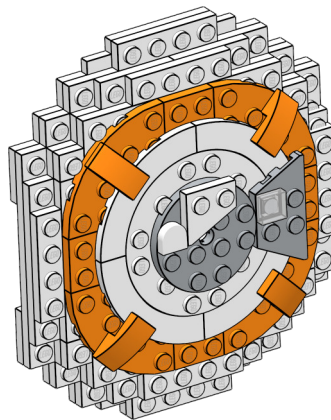
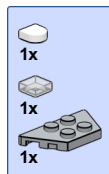

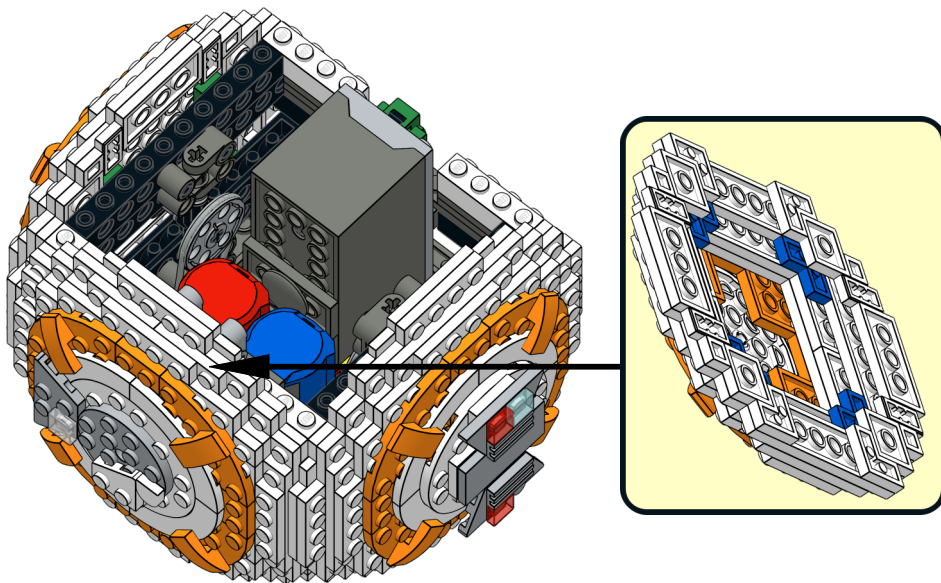

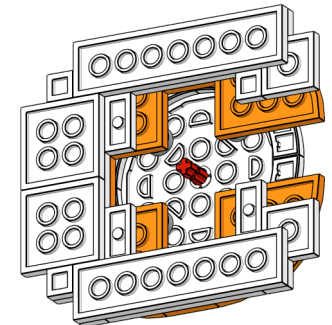
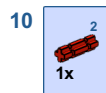
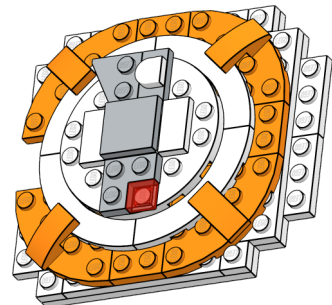
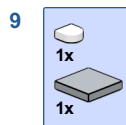
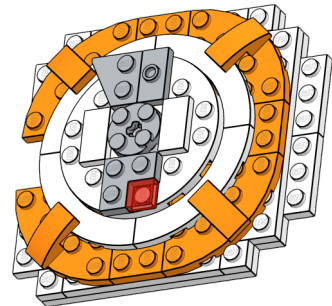
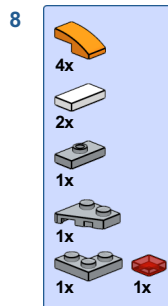
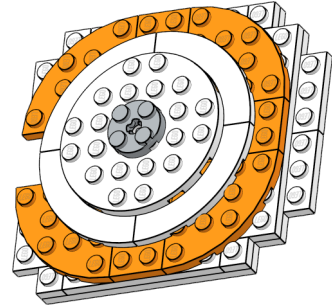
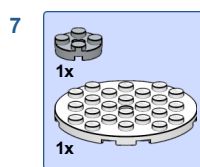
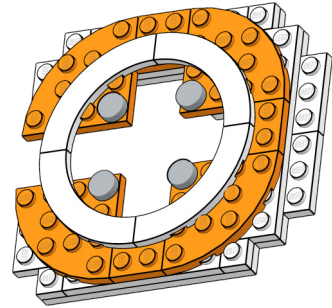
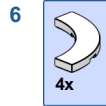
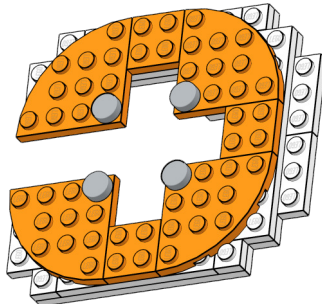
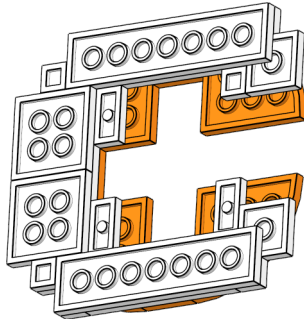
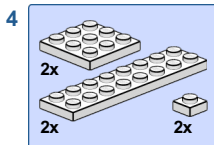
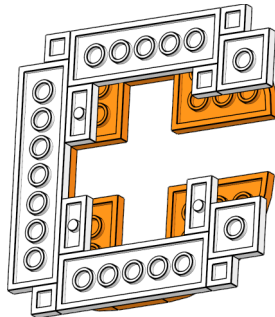
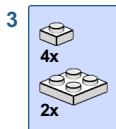
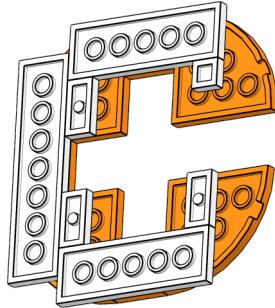
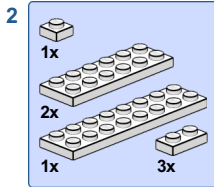
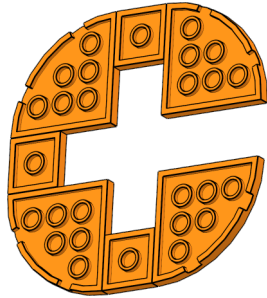
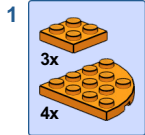

11

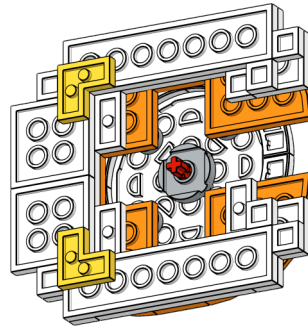

12

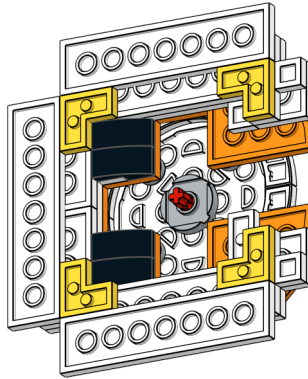
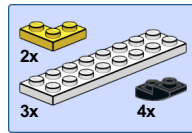

13

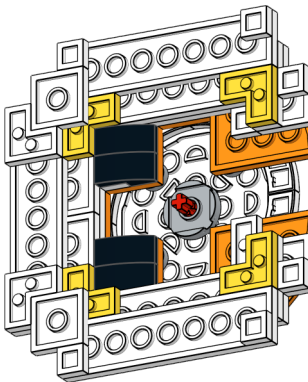
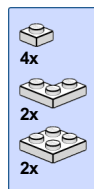

14

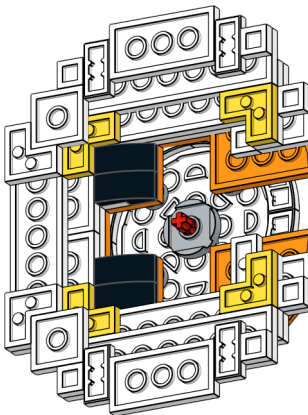
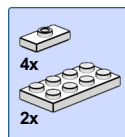

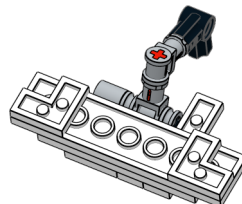
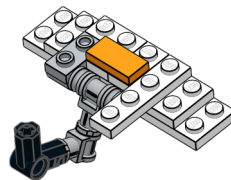
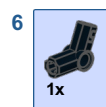
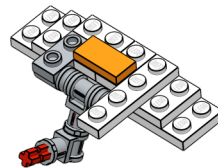
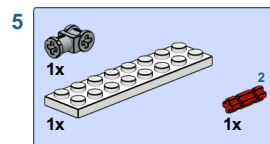
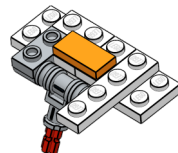
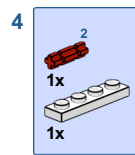
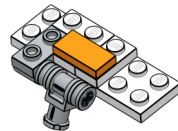
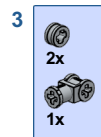
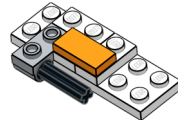
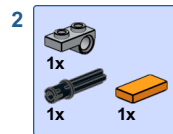
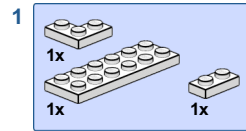

15

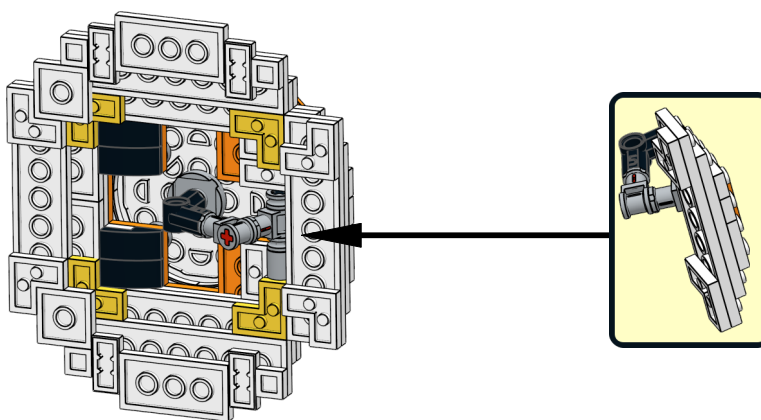

16

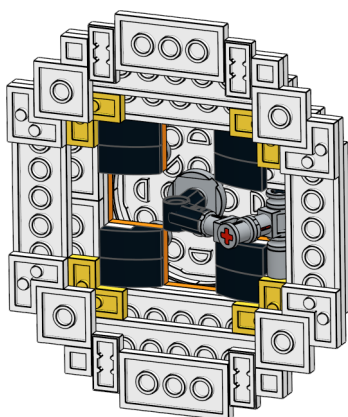

17

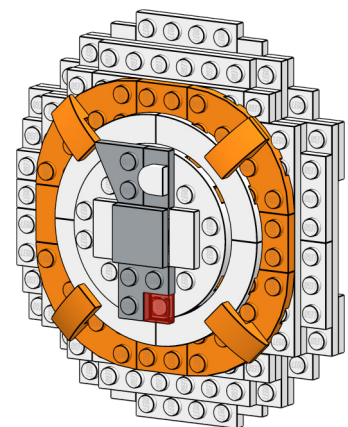
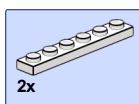

18

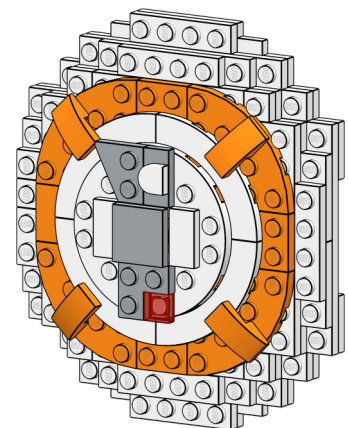
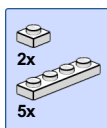

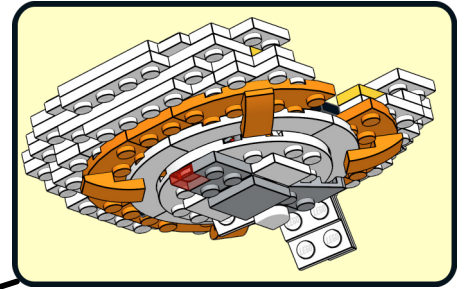
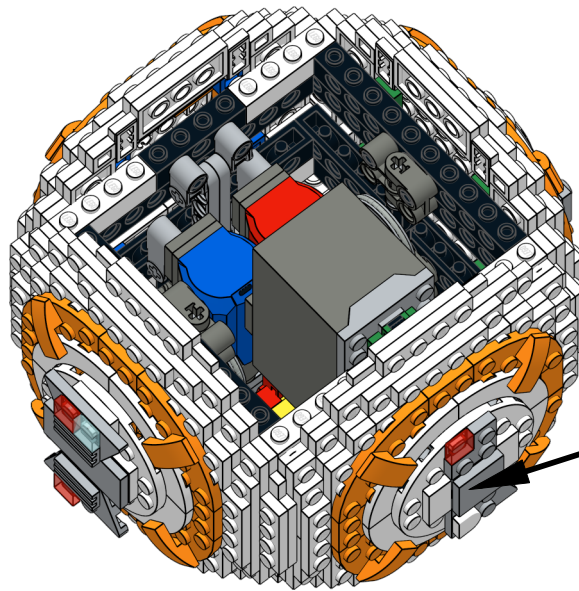

23

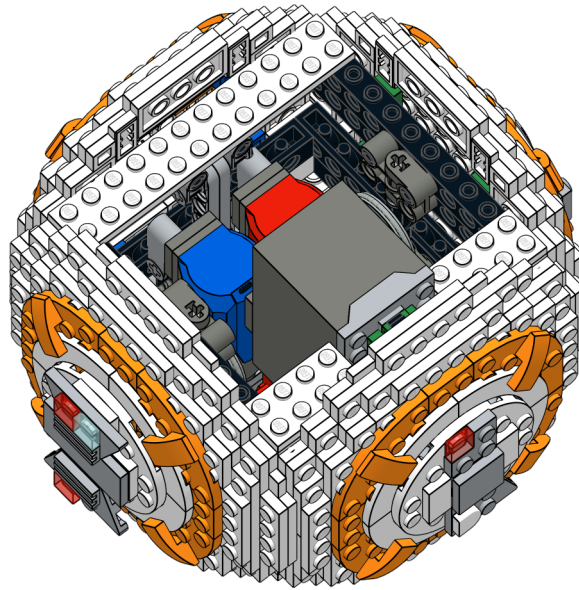
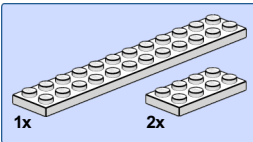

24

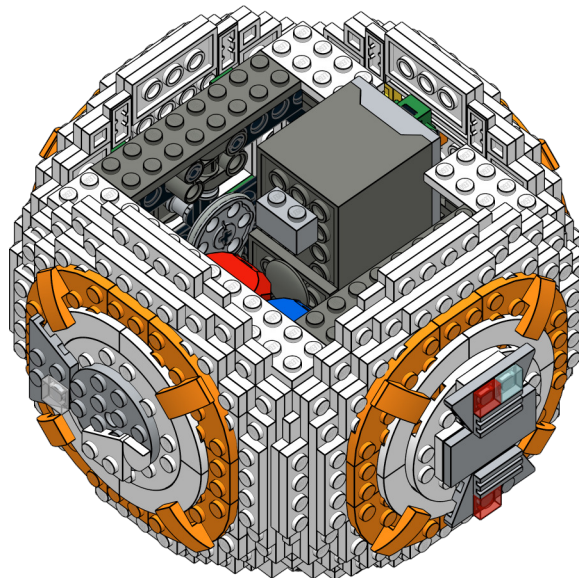
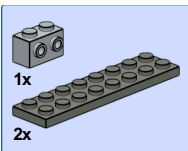

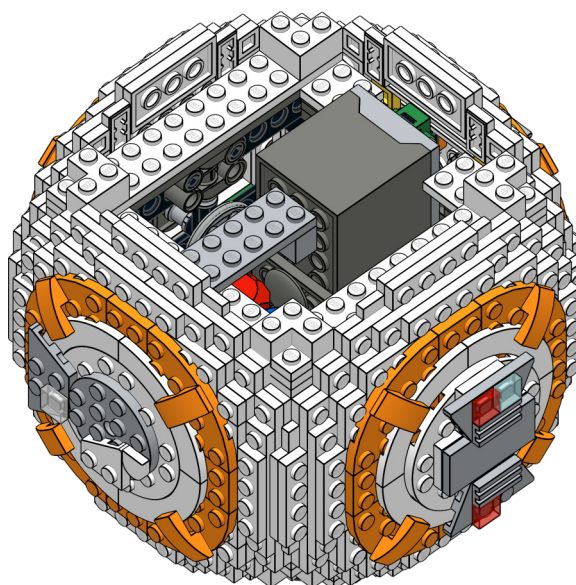
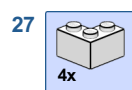
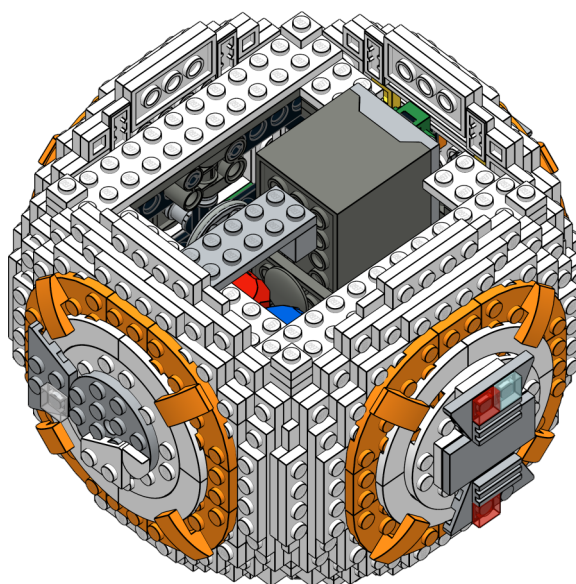
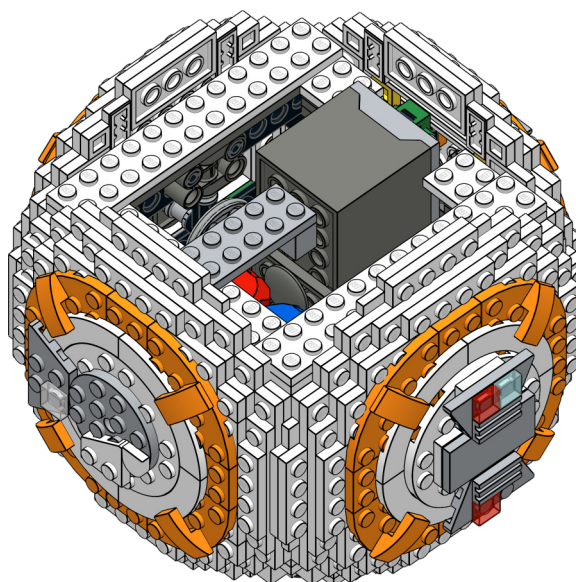
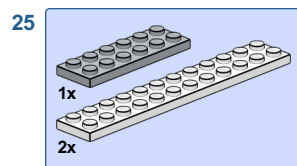

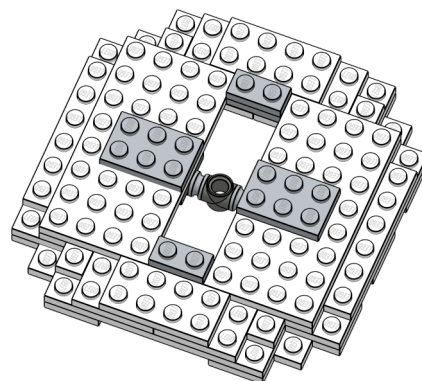
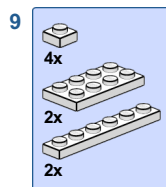
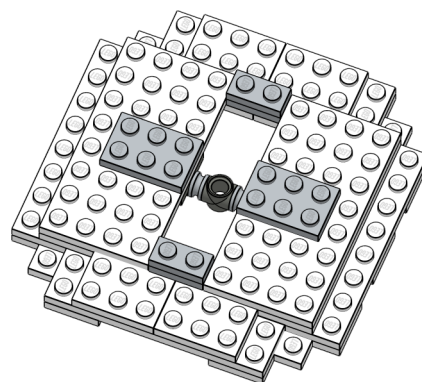
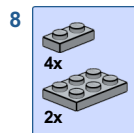
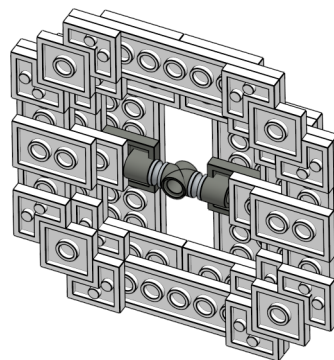
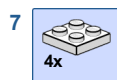
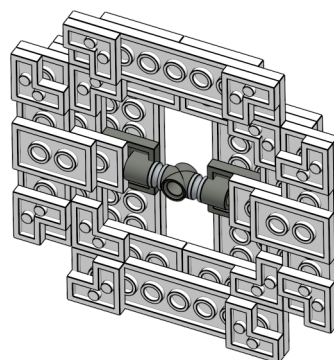
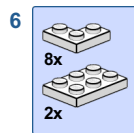
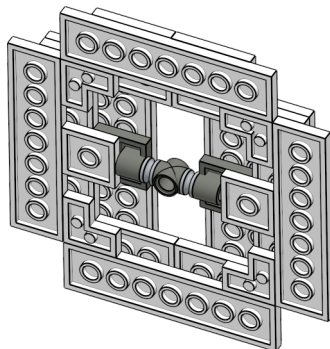
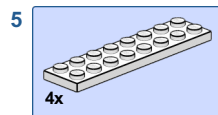
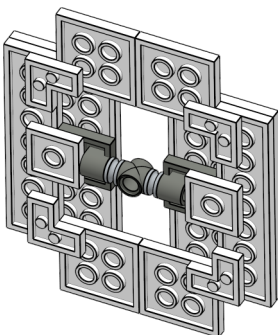
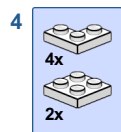
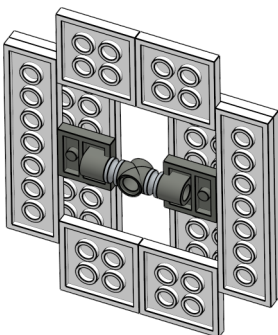
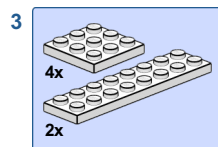
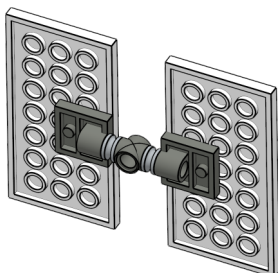
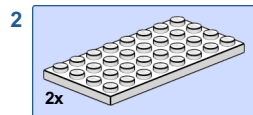
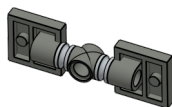
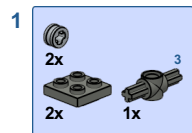

10

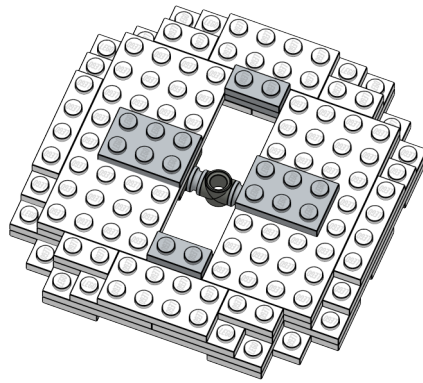
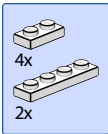

11

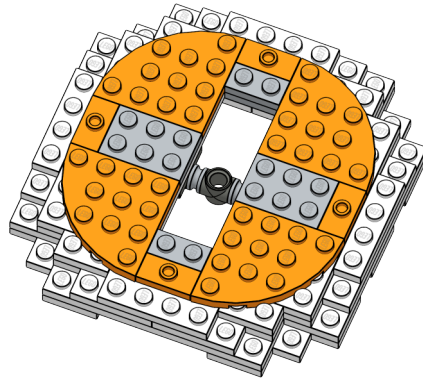
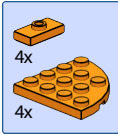

12

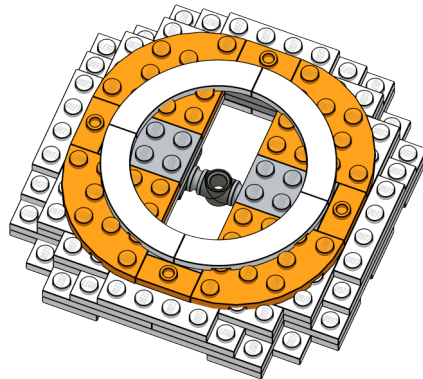

13

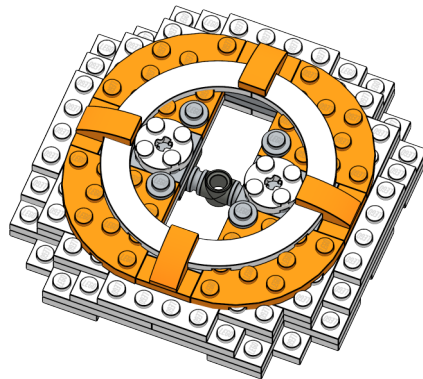

14

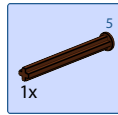

**TIP: use 2x2
LEGO rubber bands
(come in white)**

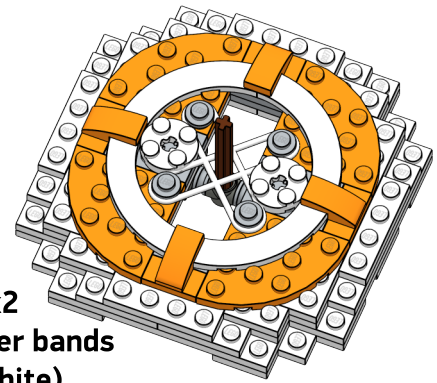

15

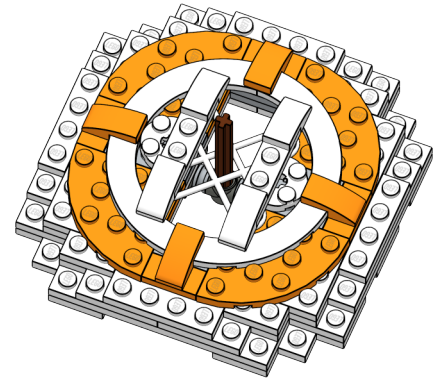
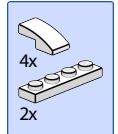

16

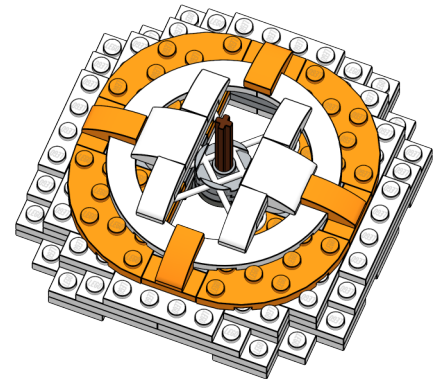
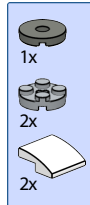

17

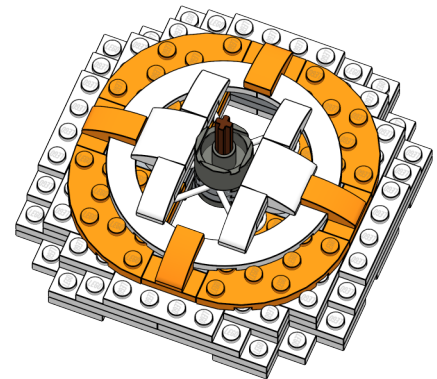

TIP: make sure to put the round tiles and plates OVER rubber bands, pushing them down as shown on the photos (left: top view, right: bottom view)



